

2017  
175

# FINAL PLAT of LAKE BELTON HIGH SCHOOL

WITHIN THE CITY OF TEMPLE, BELL COUNTY, TEXAS  
100.28 ACRES, Being part of the S. M. WILLIAMS SURVEY, ABSTRACT NO. 419 and the  
J. J. SIMMONS SURVEY, ABSTRACT NO. 731, Bell County, Texas,

STATE OF TEXAS  
COUNTY OF BELL

BELTON INDEPENDENT SCHOOL DISTRICT, OWNER OF THE LAND SHOWN ON THIS PLAT AND  
DESIGNATED HEREIN AS LAKE BELTON HIGH SCHOOL, WITHIN THE CITY OF TEMPLE, BELL COUNTY,  
TEXAS, AND WHOSE NAMES ARE SUBSCRIBED HERETO, HEREBY DEDICATE THE USE OF THE PUBLIC  
FOREVER ALL STREETS, ALLEYS, PARKS, WATERCOURSES, DRAINS, EASEMENTS, AND PUBLIC PLACES  
SHOWN HEREON WITHIN THE PLAT BOUNDARIES OF THIS SUBDIVISION.

BY: RANDY PITTENGER, BOARD PRESIDENT  
BELTON INDEPENDENT SCHOOL DISTRICT

STATE OF TEXAS  
COUNTY OF BELL

BEFORE ME, the undersigned authority, on this day personally appeared RANDY PITTENGER, known to  
me to be the person whose name is subscribed to the foregoing instrument, and acknowledged to me  
that he executed the same as Board President, Belton Independent School District, for the purposes  
and consideration therein expressed.  
GIVEN UNDER MY HAND AND SEAL OF OFFICE THIS 4th DAY OF December  
2017.

*Charles C. Lucko*  
NOTARY PUBLIC, STATE OF TEXAS



THIS FINAL PLAT HAS BEEN SUBMITTED TO AND CONSIDERED BY THE PLANNING AND ZONING  
COMMISSION OF THE CITY OF TEMPLE, TEXAS, AND IS HEREBY APPROVED BY SUCH COMMISSION.  
DATED THIS 8th DAY OF December, 2017.

*Charles C. Lucko*  
CHAIRPERSON

*Charles C. Lucko*  
SECRETARY, PLANNING & ZONING

STATE OF TEXAS  
COUNTY OF BELL

I, THE UNDERSIGNED, A REGISTERED PROFESSIONAL LAND SURVEYOR IN THE STATE OF TEXAS,  
HEREBY CERTIFY, TO THE BEST OF MY KNOWLEDGE AND BELIEF, THAT THIS PLAT IS TRUE AND  
CORRECT, THAT IT WAS PREPARED FROM AN ACTUAL SURVEY OF THE PROPERTY MADE UNDER MY  
SUPERVISION ON THE GROUND, AND THAT ALL NECESSARY SURVEY MONUMENTS ARE CORRECTLY  
SHOWN THEREON.

*Charles C. Lucko*  
CHARLES C. LUCKO, R.P.L.S.  
REGISTRATION NO. 4636

DATE SURVEYED: April 21, 2017

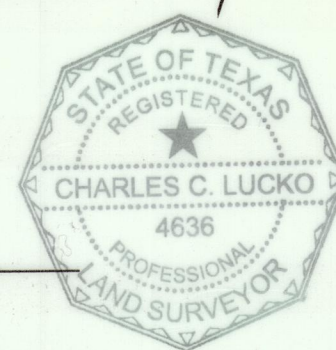

AFFIDAVIT:  
The Tax Appraisal District of Bell County does hereby certify there are currently no  
delinquent taxes due to the Tax Appraisal District of Bell County on the property described by  
this plat.

Dated this 18th day of December, 2017  
A. D.

By: *Morgan Brown*  
Bell County Tax Appraisal District

FILED FOR RECORD THIS 19 DAY OF December, 2017

IN YEAR 2017 PLAT RECORDS OF BELL COUNTY, TEXAS.

DEDICATION INSTRUMENT # 2017-52826 OFFICIAL PUBLIC RECORDS OF BELL  
COUNTY, TEXAS.

LINE	BEARINGS	DISTANCE	RECORD CALLS
L1	S 73°28'06" E	80.07'	S 73°28'06" E 80.07'
L2	S 18°56'58" W	200.18'	S 18°56'58" W 200.18'
L3	S 73°28'06" E	218.63'	S 73°28'06" E 218.63'
L4	S 73°21'32" E	200.13'	S 73°21'32" E 200.00'
L5	N 17°15'52" E	144.15'	N 17°15'52" E 144.15'
L6	N 73°19'38" W	107.54'	N 73°19'38" W 107.54'
L7	S 17°20'41" W	136.11'	S 17°20'41" W 136.11'
L8	N 74°14'14" W	316.31'	N 74°14'14" W 316.31'

CURVE	RADIUS	ARC LENGTH	CHORD LENGTH	CHORD BEARING	DELTA ANGLE	RECORD CALLS
C1	446.21'	524.68'	518.83'	S 58°48'24" E	30°11'10"	ARC = 524.68'
C2	1179.00'	98.78'	98.72'	S 46°20'45" E	4°44'24"	ARC = 98.72'

SIDEWALK NOTES:  
• Sidewalks must be built in line with existing sidewalks in  
accordance with UDC Section 8.2.3C.3  
• The walkway required along FM 2483 will serve as a  
collector level trail as called for in the Citywide Trails  
Master Plan. Collector level trails are to be 6' to 8' wide.

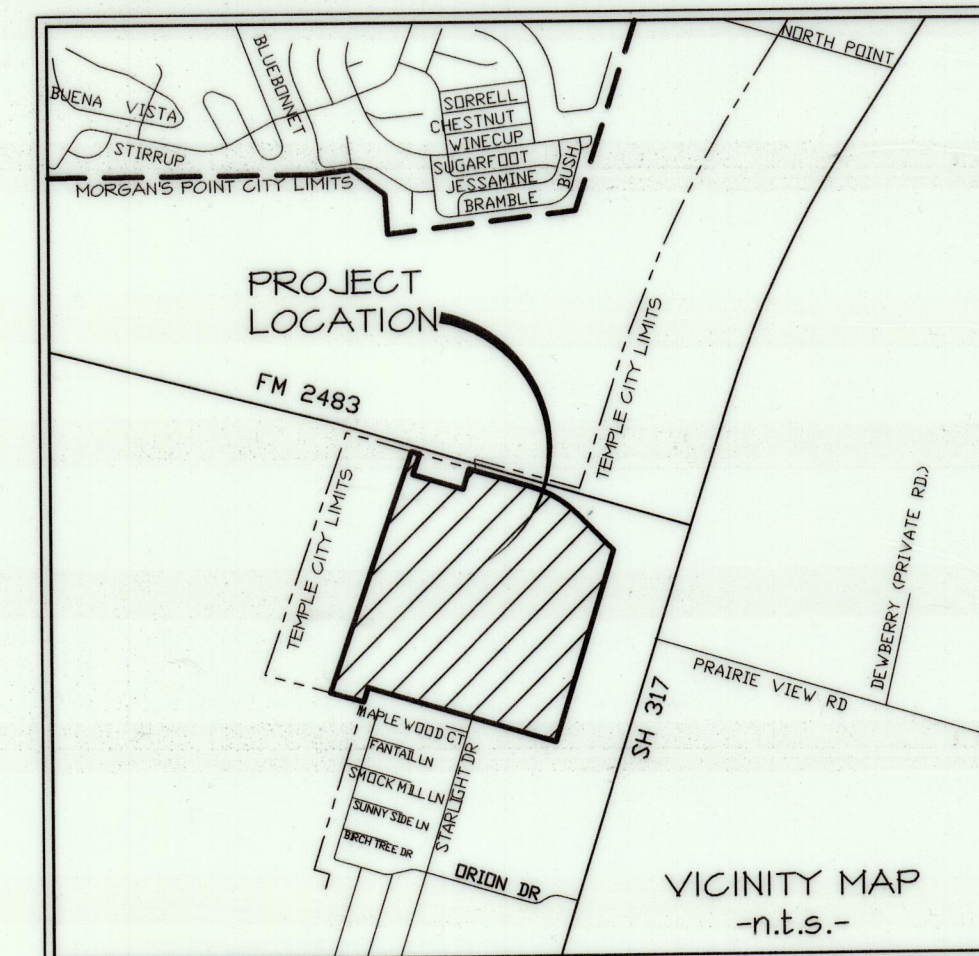

OWNER:  
BELTON INDEPENDENT SCHOOL  
DISTRICT  
P. O. BOX 269  
BELTON, TEXAS 76513  
Doc. # 2006-00058548 &  
Doc. # 2017-00021696

LOTS - 1  
BLOCKS - 1  
AREA - 100.28 ACRES

FINAL PLAT of  
**LAKE BELTON HIGH SCHOOL**  
WITHIN THE CITY OF TEMPLE, BELL COUNTY, TEXAS

Plot Date: 11-13-2017  
Survey completed: 04-21-2017  
Scale: 1" = 200'  
Job No.: 170808  
Dwg No.: 170808P  
Drawn by: MDH  
Surveyor: CCL #4636  
Copyright 2017 All County Surveying, Inc.

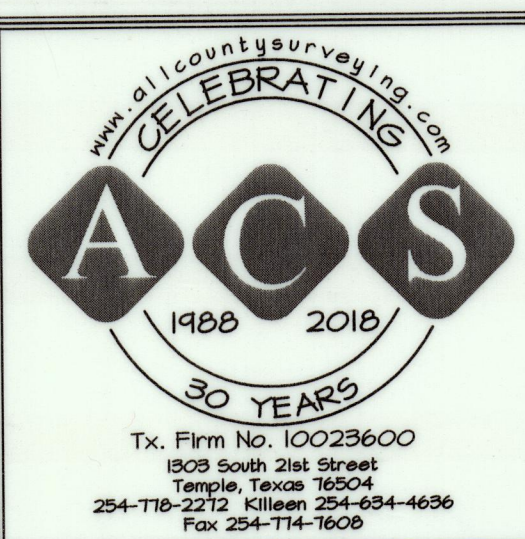

Inst#2017-52826