



OSPREY ENVIRONMENTAL ENGINEERING, LLC.

146 EAST MAIN STREET . CLINTON, CT 06413

PHONE: 860.669.8651

Mr. Scott Bartlett, Superintendent, Director of Public Works Operations
Fairfield Department of Public Works
725 Old Post Road
Fairfield, CT 06824

23 April 2018

Re: Soils Sampling, Silt Fence Line, Aggregate Recycling Yard Berm Project, Fairfield, CT
Collection date: 20 April 2018

Per your request, samples of soils from the locations shown on the attached map and were collected to determine concentrations of constituents of concern (COCs) related to available environmental and health & safety standards and guidelines. Samples were collected in new glassware supplied by the laboratory and stored in compliance with standard sample preservation procedures. The composite samples were submitted to Complete Environmental Testing, Inc., a Connecticut Certified Laboratory. Samples were compared to the DEEP Remediation Standards Regulations (RSRs) Direct Exposure Criteria (DEC) for environmental consideration. Samples were analyzed for ETPH, arsenic, and lead. The following is a comparison of the results of the analyses to their respective evaluation criteria.

Sample Summary Table

COMPOUND	ETPH	Arsenic	Lead	PCBs
(Residential/Industrial & Commercial) mg/kg	500/2500	10/10	400/1000	1/10
S1	300	5.9	32	ND<0.17
S2	270	4.7	22	ND<0.15
S3	ND<66	2.9	31	ND<0.13
S4	1800	3.0	82	ND<0.11

Green is above the Residential DEC *Blue* is above the Residential & Industrial/Commercial DEC, ND = Not detected

One sample had ETPH above the Residential DEC but below the Industrial/Commercial DEC most likely due to the presence of asphalt fragments. PCBs, arsenic and lead were all below the Residential and the Industrial/Commercial DEC.

Should you have any questions regarding the above, please contact me.

Sincerely,
Osprey Environmental Engineering, LLC.

Robert Grabarek, P.E., L.S., LEP
President

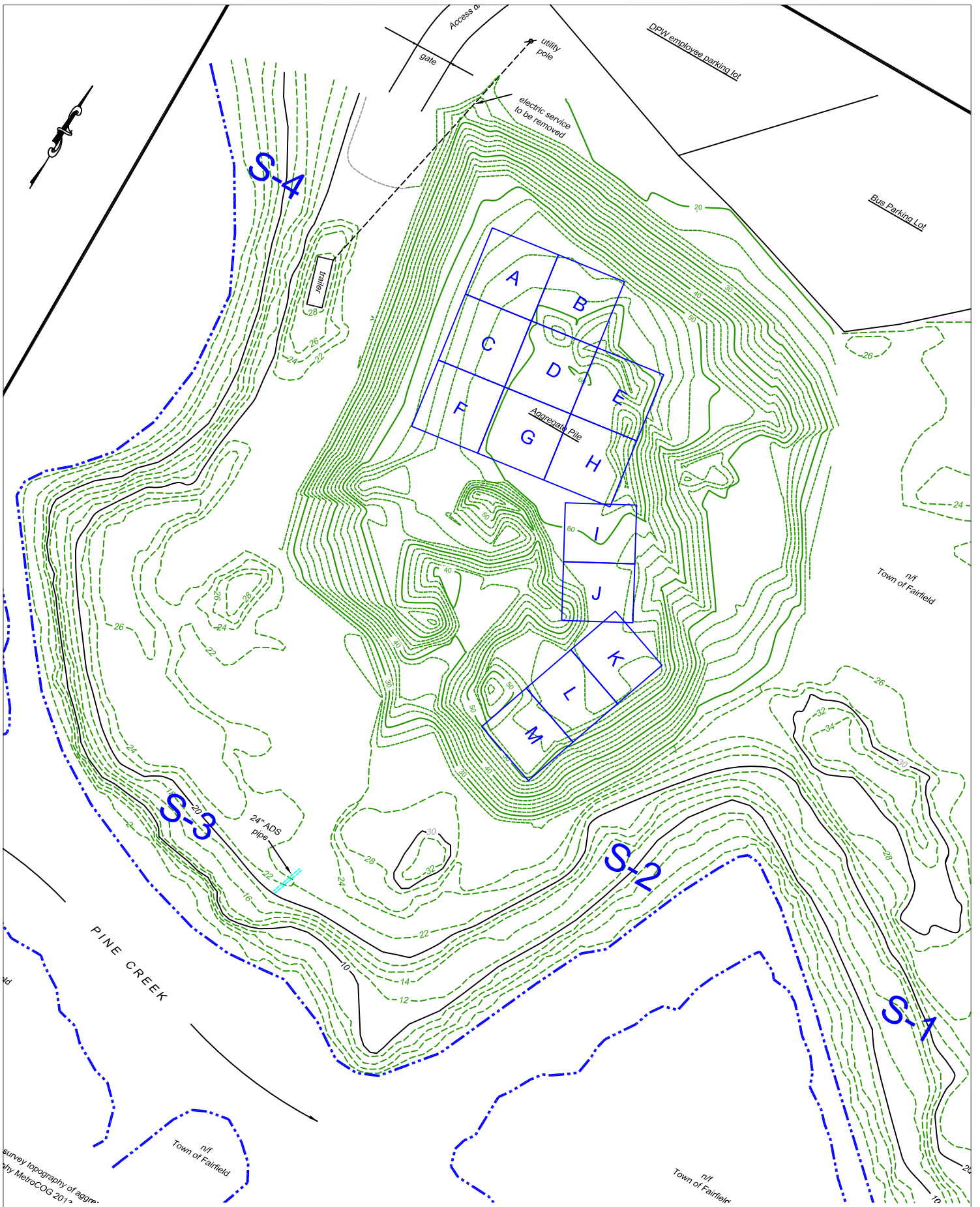

A-2

AGGREGATE YARD SILT FENCE SAMPLES
DEPARTMENT OF PUBLIC WORKS FACILITY
90 ROD HIGHWAY, FAIRFIELD, CT

OSPREY
ENVIRONMENTAL ENGINEERING, LLC
 146 East Main Street
 Clinton, CT 06413
 Phone (860) 669-8651



DRAWN BY: RJC
SCALE: 1"=100'
DATE: 04.23.18
REVISIONS:

Client: Mr. Robert Grabarek
Osprey Enviromental
146 East Main St
Clinton, CT 06413

Analytical Report

CET# 8040704



Report Date: April 23, 2018
Project: Fairfield
Project Number: AG YD

Connecticut Laboratory Certificate: PH 0116
Massachusetts laboratory Certificate: M-CT903



New York NELAP Accreditation: 11982
Rhode Island Certification: 199

CET # : 8040704

Project: Fairfield

Project Number: AG YD

SAMPLE SUMMARY

The sample(s) were received at 19.0°C.

This report contains analytical data associated with following samples only.

Sample ID	Laboratory ID	Matrix	Collection Date/Time	Receipt Date
S1	8040704-01	Soil	4/20/2018 14:15	04/20/2018
S2	8040704-02	Soil	4/20/2018 14:15	04/20/2018
S3	8040704-03	Soil	4/20/2018 14:15	04/20/2018
S4	8040704-04	Soil	4/20/2018 14:15	04/20/2018

CET # : 8040704
Project: Fairfield
Project Number: AG YD

Analyte: Percent Solids [SM 2540 G]

Analyst: DRL

Matrix: Soil

Laboratory ID	Client Sample ID	Result	RL	Units	Dilution	Batch	Prepared	Date/Time Analyzed	Notes
8040704-01	S1	60	1.0	%	1	B8D2335	04/23/2018	04/23/2018 15:45	
8040704-02	S2	63	1.0	%	1	B8D2335	04/23/2018	04/23/2018 15:45	
8040704-03	S3	76	1.0	%	1	B8D2335	04/23/2018	04/23/2018 15:45	
8040704-04	S4	87	1.0	%	1	B8D2335	04/23/2018	04/23/2018 15:45	

Analyte: Total Lead [EPA 6010C]

Analyst: SS

Prep: EPA 3051A

Matrix: Soil

Laboratory ID	Client Sample ID	Result	RL	Units	Dilution	Batch	Prepared	Date/Time Analyzed	Notes
8040704-01	S1	52	3.3	mg/kg dry	1	B8D2320	04/23/2018	04/23/2018 15:04	
8040704-02	S2	120	3.0	mg/kg dry	1	B8D2320	04/23/2018	04/23/2018 15:09	
8040704-03	S3	11	2.4	mg/kg dry	1	B8D2320	04/23/2018	04/23/2018 15:13	
8040704-04	S4	31	2.1	mg/kg dry	1	B8D2320	04/23/2018	04/23/2018 15:17	

Analyte: Total Arsenic [EPA 6010C]

Analyst: SS

Prep: EPA 3051A

Matrix: Soil

Laboratory ID	Client Sample ID	Result	RL	Units	Dilution	Batch	Prepared	Date/Time Analyzed	Notes
8040704-01	S1	5.9	1.7	mg/kg dry	1	B8D2320	04/23/2018	04/23/2018 15:04	
8040704-02	S2	4.7	1.5	mg/kg dry	1	B8D2320	04/23/2018	04/23/2018 15:09	
8040704-03	S3	2.9	1.2	mg/kg dry	1	B8D2320	04/23/2018	04/23/2018 15:13	
8040704-04	S4	3.0	1.1	mg/kg dry	1	B8D2320	04/23/2018	04/23/2018 15:17	

CET # : 8040704
 Project: Fairfield
 Project Number: AG YD

Client Sample ID S1

Lab ID: 8040704-01

Conn. Extractable TPH

Analyst: MJH

Method: CT-ETPH

Matrix: Soil

Analyte	Result (mg/kg dry)	RL (mg/kg dry)	Dilution	Prep Method	Batch	Prepared	Date/Time Analyzed	Notes
ETPH	300	84	1	EPA 3550C	B8D2101	04/21/2018	04/21/2018 16:01	R
<i>Surrogate: Octacosane</i>	<i>93.0 %</i>	<i>50 - 150</i>			B8D2101	04/21/2018	<i>04/21/2018 16:01</i>	
R C18-C36 unknown								

PCBs by ASE

Analyst: PJB

Method: EPA 8082A

Matrix: Soil

Analyte	Result (mg/kg dry)	RL (mg/kg dry)	Dilution	Prep Method	Batch	Prepared	Date/Time Analyzed	Notes
PCB-1016	ND	0.17	1	EPA 3545A	B8D2021	04/20/2018	04/20/2018 23:50	
PCB-1221	ND	0.17	1	EPA 3545A	B8D2021	04/20/2018	04/20/2018 23:50	
PCB-1232	ND	0.17	1	EPA 3545A	B8D2021	04/20/2018	04/20/2018 23:50	
PCB-1242	ND	0.17	1	EPA 3545A	B8D2021	04/20/2018	04/20/2018 23:50	
PCB-1248	ND	0.17	1	EPA 3545A	B8D2021	04/20/2018	04/20/2018 23:50	
PCB-1254	ND	0.17	1	EPA 3545A	B8D2021	04/20/2018	04/20/2018 23:50	
PCB-1260	ND	0.17	1	EPA 3545A	B8D2021	04/20/2018	04/20/2018 23:50	
PCB-1268	ND	0.17	1	EPA 3545A	B8D2021	04/20/2018	04/20/2018 23:50	
PCB-1262	ND	0.17	1	EPA 3545A	B8D2021	04/20/2018	04/20/2018 23:50	
<i>Surrogate: TCMX [1C]</i>	<i>104 %</i>	<i>30 - 150</i>			B8D2021	04/20/2018	<i>04/20/2018 23:50</i>	
<i>Surrogate: TCMX [2C]</i>	<i>105 %</i>	<i>30 - 150</i>			B8D2021	04/20/2018	<i>04/20/2018 23:50</i>	
<i>Surrogate: DCB [1C]</i>	<i>62.4 %</i>	<i>30 - 150</i>			B8D2021	04/20/2018	<i>04/20/2018 23:50</i>	
<i>Surrogate: DCB [2C]</i>	<i>62.4 %</i>	<i>30 - 150</i>			B8D2021	04/20/2018	<i>04/20/2018 23:50</i>	

CET # : 8040704
 Project: Fairfield
 Project Number: AG YD

Client Sample ID S2

Lab ID: 8040704-02

Conn. Extractable TPH

Analyst: MJH

Method: CT-ETPH

Matrix: Soil

Analyte	Result (mg/kg dry)	RL (mg/kg dry)	Dilution	Prep Method	Batch	Prepared	Date/Time Analyzed	Notes
ETPH	270	79	1	EPA 3550C	B8D2101	04/21/2018	04/21/2018 16:24	R
<i>Surrogate: Octacosane</i>	<i>106 %</i>	<i>50 - 150</i>			B8D2101	04/21/2018	<i>04/21/2018 16:24</i>	
R C18-C36 unknown								

PCBs by ASE

Analyst: PJB

Method: EPA 8082A

Matrix: Soil

Analyte	Result (mg/kg dry)	RL (mg/kg dry)	Dilution	Prep Method	Batch	Prepared	Date/Time Analyzed	Notes
PCB-1016	ND	0.15	1	EPA 3545A	B8D2021	04/20/2018	04/21/2018 00:10	
PCB-1221	ND	0.15	1	EPA 3545A	B8D2021	04/20/2018	04/21/2018 00:10	
PCB-1232	ND	0.15	1	EPA 3545A	B8D2021	04/20/2018	04/21/2018 00:10	
PCB-1242	ND	0.15	1	EPA 3545A	B8D2021	04/20/2018	04/21/2018 00:10	
PCB-1248	ND	0.15	1	EPA 3545A	B8D2021	04/20/2018	04/21/2018 00:10	
PCB-1254	ND	0.15	1	EPA 3545A	B8D2021	04/20/2018	04/21/2018 00:10	
PCB-1260	ND	0.15	1	EPA 3545A	B8D2021	04/20/2018	04/21/2018 00:10	
PCB-1268	ND	0.15	1	EPA 3545A	B8D2021	04/20/2018	04/21/2018 00:10	
PCB-1262	ND	0.15	1	EPA 3545A	B8D2021	04/20/2018	04/21/2018 00:10	
<i>Surrogate: TCMX [1C]</i>	<i>94.8 %</i>	<i>30 - 150</i>			B8D2021	04/20/2018	<i>04/21/2018 00:10</i>	
<i>Surrogate: TCMX [2C]</i>	<i>93.6 %</i>	<i>30 - 150</i>			B8D2021	04/20/2018	<i>04/21/2018 00:10</i>	
<i>Surrogate: DCB [1C]</i>	<i>60.4 %</i>	<i>30 - 150</i>			B8D2021	04/20/2018	<i>04/21/2018 00:10</i>	
<i>Surrogate: DCB [2C]</i>	<i>61.2 %</i>	<i>30 - 150</i>			B8D2021	04/20/2018	<i>04/21/2018 00:10</i>	

CET # : 8040704
 Project: Fairfield
 Project Number: AG YD

Client Sample ID S3

Lab ID: 8040704-03

Conn. Extractable TPH

Analyst: MJH

Method: CT-ETPH

Matrix: Soil

Analyte	Result (mg/kg dry)	RL (mg/kg dry)	Dilution	Prep Method	Batch	Prepared	Date/Time Analyzed	Notes
ETPH	ND	66	1	EPA 3550C	B8D2101	04/21/2018	04/21/2018 16:46	
<i>Surrogate: Octacosane</i>	<i>110 %</i>		<i>50 - 150</i>		B8D2101	04/21/2018	<i>04/21/2018 16:46</i>	

PCBs by ASE

Analyst: PJB

Method: EPA 8082A

Matrix: Soil

Analyte	Result (mg/kg dry)	RL (mg/kg dry)	Dilution	Prep Method	Batch	Prepared	Date/Time Analyzed	Notes
PCB-1016	ND	0.13	1	EPA 3545A	B8D2021	04/20/2018	04/21/2018 00:29	
PCB-1221	ND	0.13	1	EPA 3545A	B8D2021	04/20/2018	04/21/2018 00:29	
PCB-1232	ND	0.13	1	EPA 3545A	B8D2021	04/20/2018	04/21/2018 00:29	
PCB-1242	ND	0.13	1	EPA 3545A	B8D2021	04/20/2018	04/21/2018 00:29	
PCB-1248	ND	0.13	1	EPA 3545A	B8D2021	04/20/2018	04/21/2018 00:29	
PCB-1254	ND	0.13	1	EPA 3545A	B8D2021	04/20/2018	04/21/2018 00:29	
PCB-1260	ND	0.13	1	EPA 3545A	B8D2021	04/20/2018	04/21/2018 00:29	
PCB-1268	ND	0.13	1	EPA 3545A	B8D2021	04/20/2018	04/21/2018 00:29	
PCB-1262	ND	0.13	1	EPA 3545A	B8D2021	04/20/2018	04/21/2018 00:29	
<i>Surrogate: TCMX [1C]</i>	<i>76.6 %</i>		<i>30 - 150</i>		B8D2021	04/20/2018	<i>04/21/2018 00:29</i>	
<i>Surrogate: TCMX [2C]</i>	<i>78.7 %</i>		<i>30 - 150</i>		B8D2021	04/20/2018	<i>04/21/2018 00:29</i>	
<i>Surrogate: DCB [1C]</i>	<i>49.9 %</i>		<i>30 - 150</i>		B8D2021	04/20/2018	<i>04/21/2018 00:29</i>	
<i>Surrogate: DCB [2C]</i>	<i>49.1 %</i>		<i>30 - 150</i>		B8D2021	04/20/2018	<i>04/21/2018 00:29</i>	

CET # : 8040704
 Project: Fairfield
 Project Number: AG YD

Client Sample ID S4

Lab ID: 8040704-04

Conn. Extractable TPH

Analyst: MJH

Method: CT-ETPH

Matrix: Soil

Analyte	Result (mg/kg dry)	RL (mg/kg dry)	Dilution	Prep Method	Batch	Prepared	Date/Time Analyzed	Notes
ETPH	1800	58	1	EPA 3550C	B8D2101	04/21/2018	04/21/2018 17:09	R
<i>Surrogate: Octacosane</i>	<i>109 %</i>	<i>50 - 150</i>			B8D2101	04/21/2018	<i>04/21/2018 17:09</i>	
R C18-C36 unknown								

PCBs by ASE

Analyst: PJB

Method: EPA 8082A

Matrix: Soil

Analyte	Result (mg/kg dry)	RL (mg/kg dry)	Dilution	Prep Method	Batch	Prepared	Date/Time Analyzed	Notes
PCB-1016	ND	0.11	1	EPA 3545A	B8D2021	04/20/2018	04/21/2018 00:48	
PCB-1221	ND	0.11	1	EPA 3545A	B8D2021	04/20/2018	04/21/2018 00:48	
PCB-1232	ND	0.11	1	EPA 3545A	B8D2021	04/20/2018	04/21/2018 00:48	
PCB-1242	ND	0.11	1	EPA 3545A	B8D2021	04/20/2018	04/21/2018 00:48	
PCB-1248	ND	0.11	1	EPA 3545A	B8D2021	04/20/2018	04/21/2018 00:48	
PCB-1254	ND	0.11	1	EPA 3545A	B8D2021	04/20/2018	04/21/2018 00:48	
PCB-1260	ND	0.11	1	EPA 3545A	B8D2021	04/20/2018	04/21/2018 00:48	
PCB-1268	ND	0.11	1	EPA 3545A	B8D2021	04/20/2018	04/21/2018 00:48	
PCB-1262	ND	0.11	1	EPA 3545A	B8D2021	04/20/2018	04/21/2018 00:48	
<i>Surrogate: TCMX [1C]</i>	<i>91.6 %</i>	<i>30 - 150</i>			B8D2021	04/20/2018	<i>04/21/2018 00:48</i>	
<i>Surrogate: TCMX [2C]</i>	<i>83.4 %</i>	<i>30 - 150</i>			B8D2021	04/20/2018	<i>04/21/2018 00:48</i>	
<i>Surrogate: DCB [1C]</i>	<i>58.1 %</i>	<i>30 - 150</i>			B8D2021	04/20/2018	<i>04/21/2018 00:48</i>	
<i>Surrogate: DCB [2C]</i>	<i>59.4 %</i>	<i>30 - 150</i>			B8D2021	04/20/2018	<i>04/21/2018 00:48</i>	

All questions related to this report should be directed to David Ditta, Timothy Fusco, or Robert Blake at 203-377-9984.

Sincerely,

This technical report was reviewed by David Ditta



David Ditta
Laboratory Director



Project Manager

Report Comments:

Sample Result Flags:

- E- The result is estimated, above the calibration range.
- H- The surrogate recovery is above the control limits.
- L- The surrogate recovery is below the control limits.
- B- The compound was detected in the laboratory blank.
- P- The Relative Percent Difference (RPD) of dual column analyses exceeds 40%.
- D- The RPD between the sample and the sample duplicate is high. Sample Homogeneity may be a problem.
- + - The Surrogate was diluted out.
- *C1- The Continuing Calibration did not meet method specifications and was biased low for this analyte. Increased uncertainty is associated with the reported value which is likely to be biased low.
- *C2- The Continuing Calibration did not meet method specifications and was biased high for this analyte. Increased uncertainty is associated with the reported value which is likely to be biased high.
- *F1- The Laboratory Control Sample recovery is outside of control limits. Reported value for this analyte is likely to be biased on the low side.
- *F2- The Laboratory Control Sample recovery is outside of control limits. Reported value for this analyte is likely to be biased on the high side.
- I- The Analyte exceeds %RSD limits for the Initial Calibration. This is a non-directional bias.

All results met standard operating procedures unless indicated by a data qualifier next to a sample result, or a narration in the QC report.

For Percent Solids, if any of the following prep methods (3050B, 3540C, 3545A, 3550C, 5035 and 9013A) were used for samples pertaining to this report, the percent solids procedure is within that prep method.

Complete Environmental Testing is only responsible for the certified testing and is not directly responsible for the integrity of the sample before laboratory receipt.

ND is None Detected at or above the specified reporting limit

RL is the Reporting Limit.

All analyses were performed in house unless a Reference Laboratory is listed.

Samples will be disposed of 30 days after the report date.

CERTIFICATIONS

Certified Analyses included in this Report

Analyte	Certifications
<i>CT-ETPH in Soil</i>	
ETPH	CT
<i>EPA 6010C in Soil</i>	
Lead	CT,NY
Arsenic	CT,NY
<i>EPA 8082A in Soil</i>	
PCB-1016	CT,NY
PCB-1221	CT,NY
PCB-1232	CT,NY
PCB-1242	CT,NY
PCB-1248	CT,NY
PCB-1254	CT,NY
PCB-1260	CT,NY
PCB-1268	CT,NY
PCB-1262	NY
<i>SM 2540 G in Soil</i>	
Percent Solids	CT

Complete Environmental Testing operates under the following certifications and accreditations:

Code	Description	Number	Expires
CT	Connecticut Public Health	PH0116	09/30/2018
NY	New York Certification (NELAC)	11982	04/01/2019



8040704



COMPLETE ENVIRONMENTAL TESTING, INC.

CHAIN OF CUSTODY

Volatile Soils Only:

Date and Time in Freezer

Client:

CET:

Additional Analysis

80 Lupes Drive
Stratford, CT 06615
Tel: (203) 377-9984
Fax: (203) 377-9952
e-mail: cet1@cetlabs.com
Bottle Request e-mail: bottleorders@cetlabs.com

Sample ID/Sample Depths
(Include Units for any sample depths provided)

Matrix
A-Air
S-Soil
W-Water
DW-Drinking Water
C-Cassette
Solid
Wipe
Other (Specify)

Turnaround Time **
(check one)
Same Day *
Next Day *
Two Day *
Three Day *
Std (5-7 Days)

Collection Date/Time	Matrix	Turnaround Time
5/1	S	90
5/2	S	90
5/3	S	90
5/4	S	90

PRESERVATIVE (Cl-HCl, N-HNO₃, S-H₂SO₄, Na-NaOH, C=Cool, O-Other)

CONTAINER TYPE (P-Plastic, G-Glass, V-Vial, O-Other)

Soil VOCs Only (M=Meth B=Bisulfate W=Water F=Vial E=Encore)

RELINQUISHED BY: FRANK DATE/TIME: 4/20/18 2:55p RECEIVED BY: MARCO DATE/TIME: 04/20/18 14:50

RELINQUISHED BY: FRANK DATE/TIME: 4/20/18 2:55p RECEIVED BY: MARCO DATE/TIME: 04/20/18 14:50

RELINQUISHED BY: _____ DATE/TIME: _____ RECEIVED BY: _____

Client / Reporting Information

Company Name: OSPREY

Address: _____

City: _____ State: _____ Zip: _____

Report To: _____ E-mail: _____

Phone # _____ Fax # _____

- 8260 CT List
- 8260 Aromatics
- 8260 Halogens
- CT ETPH
- 8270 CT List
- 8270 PNAs
- PCBs SOX ASE
- Pesticides
- 8 RCRA
- 13 Priority Poll
- 15 CT DEP
- Total
- SPLP
- TCLP
- Dissolved
- Field Filtered
- Lab to Filter

Metals
Additional Analysis
TOTAL # OF CONT. 1
NOTE # 1

NOTES:

Results for Monday Pm

Project Information

Project: FRIFIELD

Location: AG YD

CET Quote # _____ Project # _____ Collector(s): THURASHER

QA/QC Std Site Specific (MS/MSD) * RCP Pkg * DQAW *

Data Report PDF EDD - Specify Format _____ Other _____

RSR Reporting Limits (check one) GA GB SWP Other _____

Laboratory Certification Needed (check one) CT NY RI MA

Temp Upon Receipt: 19.0 °C Evidence of Cooling: Y N PAGE 1 OF 1

* Additional charge may apply. ** TAT begins when the samples are received at the Lab and all issues are resolved. TAT for samples received after 3 p.m. will start on the next business day. All samples picked up by courier service will be considered next business day receipt for TAT purposes.