

Fairfield Beach Neighborhood Meeting

FEBRUARY, 2017

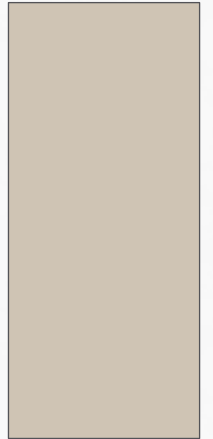

INTRODUCTIONS

First Selectman,
Michael Tetreau

Public Works Director,
Joe Michelangelo

Harvest New England
Regional Manager, Chris Field

Solid Waste & Recycling
Director, Michael Zembruski

Tree Warden, Jeff Minder

Fire Chief, Denis McCarthy

Fire Training Director,
Scott Bisson

Fairfield Beach Road
Association President,
Charles Abercrombie

Fairfield Peninsula Association
President, Patti Zecchi

Conservation Director,
Brian Carey

OVERVIEW

FIRST SELECTMAN, MICHAEL TETREAU

HARVEST NEW ENGLAND

HOW TO DIRECT QUESTIONS

Fires:

Call 911

Fire Chief, Denis McCarthy

203 254 4713

dmccarthy@fairfieldct.org

After Hours

203 254 4700

Operations:

Director of Solid Waste and
Recycling, Mike Zembruski

203 256 3023

mzembruski@fairfieldct.org

PURPOSE AND OBJECTIVE OF TOWN'S YARD WASTE FACILITY

- Provide a location for disposal of yard waste & woody debris generated by residents, Town, and private contractors
- Operate, maintain, and manage collected material
- Minimize odor, noise and traffic, and maintain the high-quality and high performance of the facility. Preserve and protect the environment in and around the Facility

TOWN'S YARD WASTE FACILITY- MATERIALS ACCEPTED

- Brush
- Logs
- Stumps
- Wood Chips
- Leaves
- Grass
- Clean untreated lumber

TOWN'S YARD WASTE FACILITY- BENEFITS

- Allows Town Residents to dispose of yard waste material **No cost**
- Allows Town Public Works & Conservation to disposal of yard waste material **No cost**
- FREE MULCH! – for residents and Town operations
- Provides location for contractors' yard waste; reduces dumping in wetlands and Conservation properties
- Provides wood chip amendment for mixture with biosolids for composting at WPCF **No cost**
- Provides final screening & processing of biosolids/amendment compost for sale as a final product; **Town receives approximately \$5,000 revenue**

TOWN'S YARD WASTE FACILITY- AGREEMENT

- Town pays Harvest New England \$49,500/ year
- Harvest New England charges commercial operators for disposal
- Harvest New England receives revenue through sales of mulch

TIMELINE

History of Composting and Brush Recycling:

- 1970's -1993 Town Of Fairfield operated site.
- 1993-1995 Scott's Earthgro operated the site.
- 1996-2006 Ground Products won the Bid and operated the site.
- 2006-Present GreenCycle, now as Harvest New England, won the Bid operates the site.



Site Map

HISTORY OF FIRE CALLS

2010 2 Calls for Service

8/02 Fire in portable building
11/18 Mulch Fire

2011 1 Call for Service

9/25 Mulch Fire

2012 2 Calls for Service

12/16 Mulch Fire
12/18 Mulch Fire

2013 5 Calls for Service

2/12 Mulch Fire
2/15 Mulch Fire
2/28 Mulch Fire
10/21 Mulch Fire

2014 1 Call for Service

1/12 Mulch Fire

2015 2 Calls for Service

11/30 Mulch Fire
12/05 Mulch Fire

2016 6 Calls for Service

3/04
3/05
3/06
3/08 Mulch Fire
10/23 Mulch Fire
11/30 Mulch Fire

2017 4 Calls for Service

1/07
1/08
1/09 Mulch Fire
1/17 Steam Investigation

AFTER ACTION REVIEW

- Jan 7th Mulch Fire Reported at HNE
- FD responded and provided assistance to HNE Staff
- Code Red message sent to FBR area residents
- Fire started in an unscreened mulch pile that sat for 4 months
- Battle Plan created: HNE committed round the clock crews to dismantle the mulch pile.
- FD met with HNE each day until all smoldering was extinguished
- FS FD and HNE Staff met to develop Mulch Management Plan

MULCH MANAGEMENT AND RISK REDUCTION PLAN

Risk Factors:

- Mulch piles greater than 20'. Stagnant piles should not be greater than 12'
- Mulch piles that age more than one month
- Unscreened mulch piles as the fine material (fines) hinders heat dissipation
- Dry pile with less than 50% moisture content

HNE Action plan: The execution of the mulch and brush management plan will be supervised by DPW staff. All records developed as prescribed below will be sent to DPW and Fire personnel for review.

- All mulch piles will be screened
- Piles scheduled to be screened will not be allowed to age more than 1 month
- Mulch temps will be probed for temperature 2x/week
- Any piles with temps > 140 degrees and rising will be deconstructed
- Piles with temps of 160 degrees or higher will be immediately deconstructed

SEMI-WEEKLY MULCH PILE REPORTS

PILE	Temp1	Temp2	Temp3	Temp4	Height	Date Formed
Main Wood chip pile	150°F (top)	130°F	110°F (top)	120°F (face)	20'	12/1/2016
Overs - Screened Chips	130°F	140°F	135°F	110°F	15'	1/9/2017
Screened Single Grind	120°F	130°F	140°F	120°F	20'	1/19/2017

FUTURE PLAN AND TIMELINE

- Zero tolerance for any fires
- Existing agreement expires 6/30/17
- Issue new RFP for new operator 4/1/2017
- Possibly reduce amount of contractor waste allowed
- Possibly reduce square footage of operations in next agreement
- Potential landscape berm – Peter Miniutti LA design

CROSS SECTION OF PROPOSED LANDSCAPE BERM

As designed by Peter Miniutti, UConn Landscape Architect

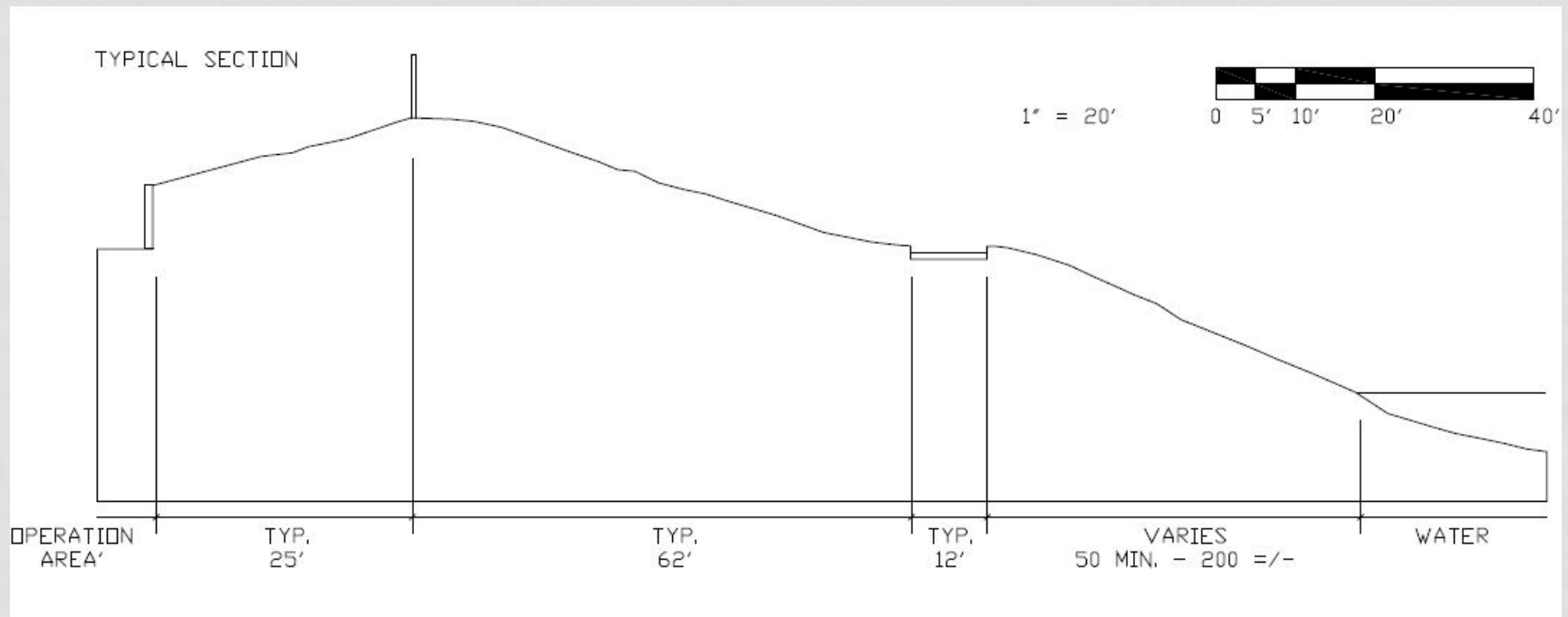

QUESTIONS?

FAIRFIELD REGIONAL FIRE SCHOOL

COMMITMENT TO NEIGHBORS

- The Fairfield Fire Department commits to be good neighbors to the residential property owners in the Fairfield Beach Rd and surrounding neighborhoods.
- We will seek every opportunity to reduce the impact of Fire Training has on its neighbors. We will use scheduling, engineering and landscaping when and where applicable.
- We will maintain an open line of communications with the neighborhood associations and individuals to manage any issues as they arise.

FIRE SCHOOL HISTORY



FIRE SCHOOL HISTORY



HISTORY OF FIRE SCHOOL

- 1965 Town of Fairfield Purchases Nike Missile Site from Federal Government
- 1971 Special Act 71-132 Establishes the Fairfield Regional Fire School
- 1971-2015 Fairfield Operates the Regional School
- 2016 State of Ct begins construction of new Regional School
- 2017 Projected Opening of the Regional School

MODIFICATIONS OF SITE PLAN

- During Construction the Site Plan was modified improve site/neighborhood interface.
- ✓ Create a planting bed by reducing concrete surfaces in the rear of the burn building
- ✓ Relocate the flood control wall to the new edge of concrete
- ✓ Build up planting bed to 13'
- ✓ Purchase and plant trees along the south property line
- ✓ Relocate the flashover simulator

Propane
Fire Props

Vehicle
Extrication

Plant
Screening
(Existing)

Ladder
Tower

Burn
Building

Plant
Screening
(New)

Classroom and
Administration

Flashover Simulator
(New Position)

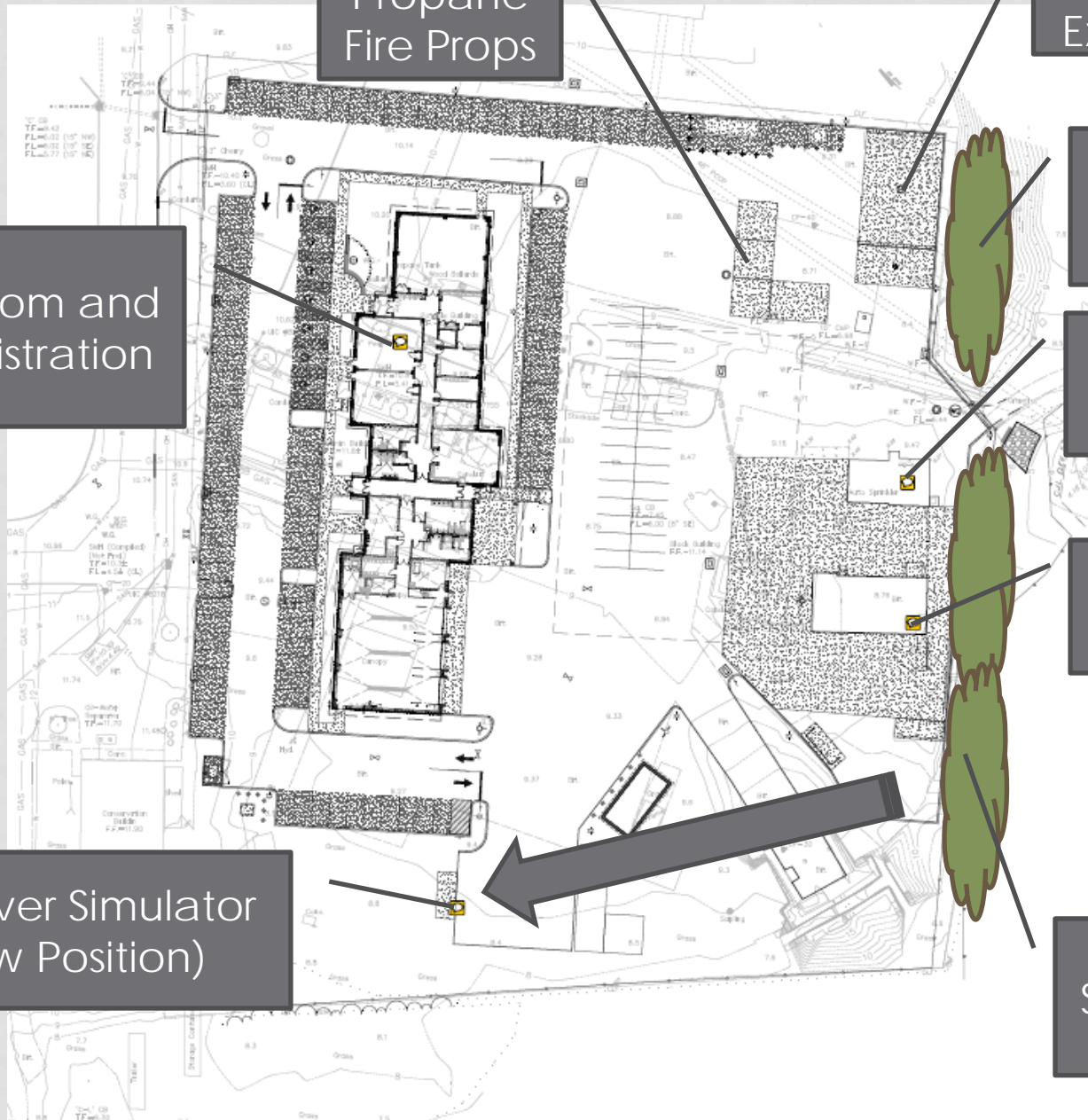

FLOOD CONTROL BERM

- Town received a \$2.5 M grant for Microgrid project to service Wastewater Plant, Fire Training, Conservation Garage, and Animal Control during power outages
- Town received a \$2.316 M grant (w/ 772 k local share) for Flood Control Hardening Project
- Hardening project necessary as part of Microgrid project award
- A Flood Control structure may reduce need for future elevation of Wastewater Plant infrastructure

FLOOD CONTROL BERM

- Flood Control Structure will be earthen where footprint allows.
- Directly behind the new Burn Building and Existing Burn Tower, structural wall(s) are necessary due to limited width.
- Around the Wastewater Plant, barrier will be well below the sound barrier which rises to elevation 29'

FLOOD CONTROL BERM

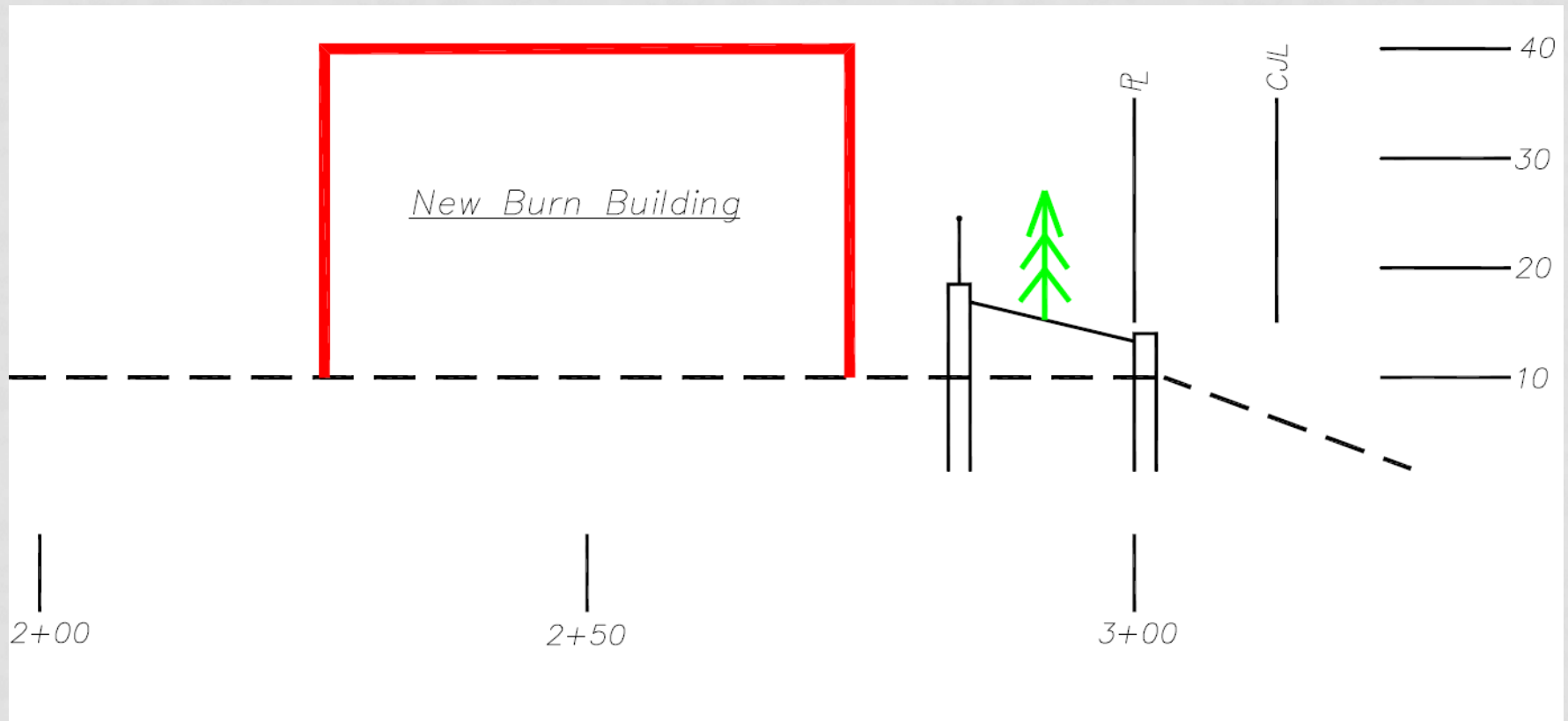

FLOOD CONTROL BERM

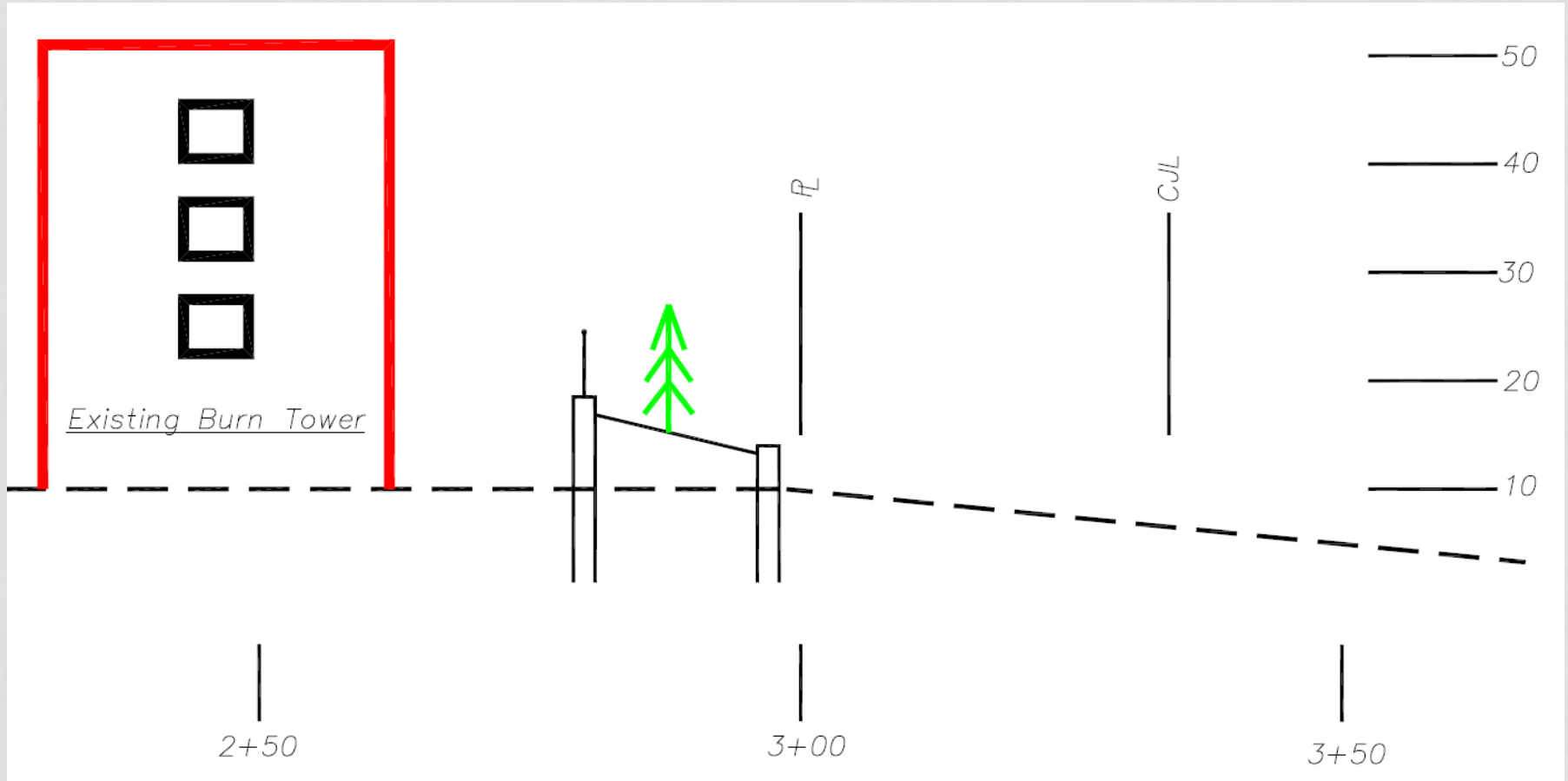







View 1 – Initial Planting 14' high



View 1 – 10 Year Growth -40' high

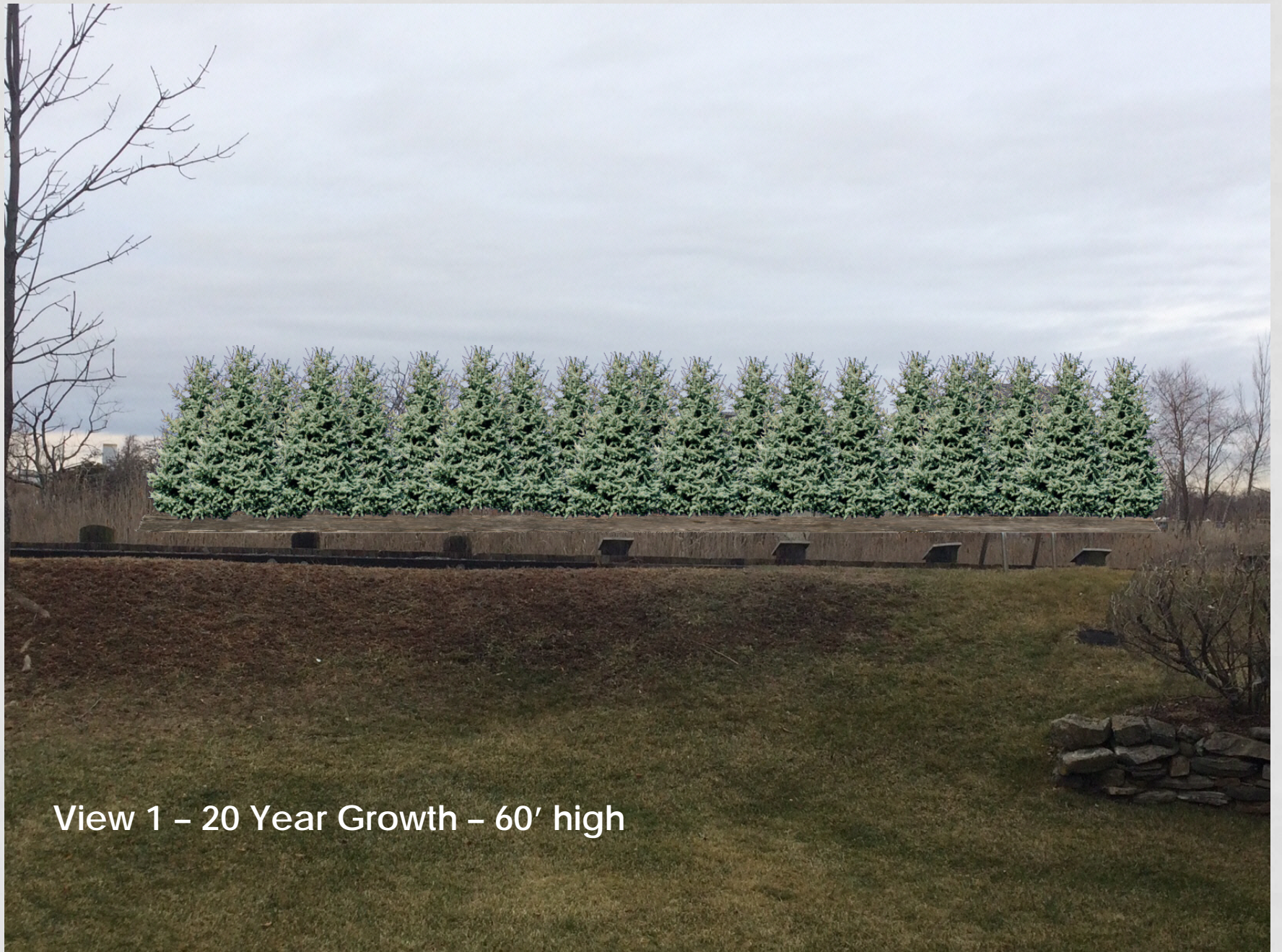

View 1 – 20 Year Growth – 60' high





View 2 – Initial Planting – 14' high



View 2 – 10 Year Growth – 40' high



View 2 – 20 Year Growth – 60' high





View 3 – Initial Planting

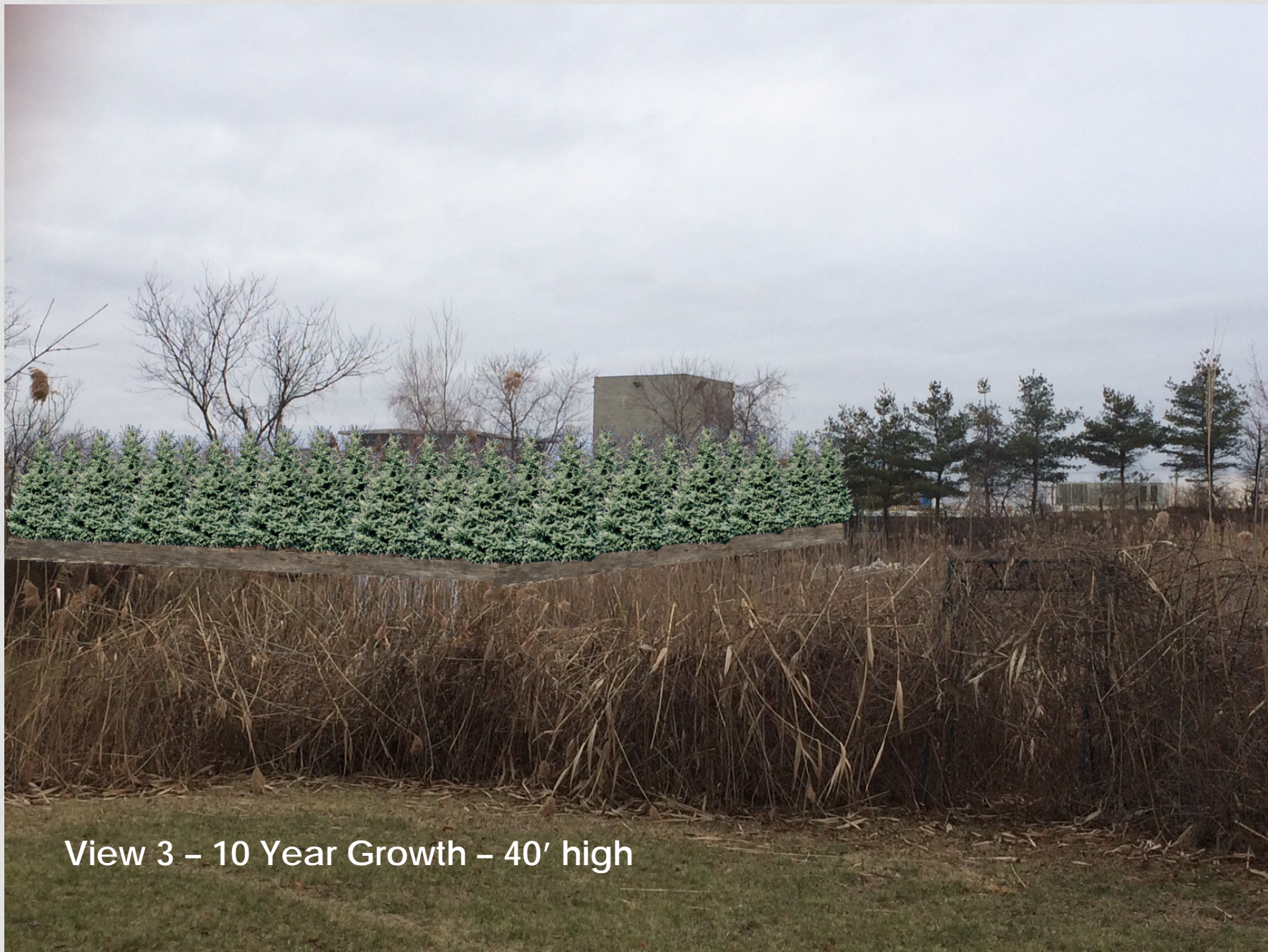

View 3 – 10 Year Growth – 40' high



View 3 – 20 Year Growth – 60' high

UPRIGHT WHITE PINE



- **Eastern White Pine** (*Pinus Strobus Fastigiata*).
- **Hardiness Zone 3-8:** Connecticut is zone 5/6.
- **Growth Rate:** Grows at a fast rate, with potential growth of 24-36" per year. Can grow in excess of 50ft tall and 12ft wide.
- **Sun Preference:** Full sun and partial shade are best for this tree, it prefers a minimum of four hours of direct sunlight each day.
- **Soil Preference:** Grows in acidic, moist well-drained and dry soils. While it does best in moist soil, the tree can be known to tolerate everything from dry, rocky ridges to bogs.
- **Attributes:** Works well for windbreaks and screening in areas that are limited for space. Rapid growth rate. Provides food and shelter for numerous forest birds and wild life. Tolerates heavy winds, snow, ice, heat waves and drought. Deer resistant. Little to no maintenance.

TRAINING SCHOOL OPERATIONS

- “You fight the way you train”
- Cognitive and Practical skills for fire and rescue services
- Encourages cooperation across disciplines and jurisdictional lines
- Provides vital life safety skills through live fire training in specially designed burn buildings
- The amount of training should not increase from what we had in 2013

IMPROVING QUALITY OF LIFE FOR OUR NEIGHBORS

- Significantly reducing emissions from previous training methods (i.e.. car fires, oil pan fires)
- Modern and Cleaner
- Safer and visually appealing facility
- Environmentally friendly
- Energy efficient
- Reduces carbon footprint

TRAINING SCHEDULE

- Firefighter Certification Classes
- Refresher Drills
- Regional classes and drills
- Outside Practical evolutions
 - Apparatus Driving and Pumping
 - Hose work
 - Live Fire Training (propane)
 - Ladders
 - HAZMAT
 - Extrication
 - Technical Rescue (confined space, trench, ropes)
- Smoke Producing Evolutions
 - Live Fire Training (Wood)
 - Flash Over Simulator

MONTHLY SCHEDULE OF TRAINING ACTIVITIES

- Weekdays - Career Department's
 - Busiest time, career department's
 - class, drill and live fire evolutions
- Weeknights – Volunteer Department's
 - class, drill and live fire evolutions
- Weekend days – Volunteer and Certification
 - class, drill and live fire evolutions
- No routine operations on weekend nights and holidays – special circumstances

SMOKE, NOISE AND LIGHT ABATEMENT STRATEGIES

- Lights – timers, angles and screening
- Noise - establish and enforce quiet hours
- Cold Weather Operations - Parking trucks inside instead of running outside in cold
- Smoke – reduced smoke producing evolutions
- Smoke - reposition mobile flashover simulator
- Smoke – reduce actual smoke production based on weather conditions with artificial smoke generation capability (no odor)

ELIMINATED – OIL PIT FIRES



ELIMINATED – OIL PAN FIRES



ELIMINATED – CAR FIRES



LOW/NO SMOKE PRODUCTION PROPANE PROPS



SMOKE PRODUCING EVOLUTIONS

- Flashover Simulator
 - Burns wood to demonstrate fire behavior
- Class A burn building
 - Burns hay and wood to create realistic fire conditions for interior search, rescue and coordinated fire attack

Although there will be smoke there will be much less due to the improvements and policy changes

CURRENT PHOTOS FLASHOVER SIMULATOR



FLASHOVER SIMULATOR



CLASS A BURN BUILDING TYPICAL OPERATIONS



PLANNED TRAINING SCHEDULE

Starting in the spring of 2017, FRFS will posted a planned schedule of outdoor training evolutions on our official webpage.

Training is weather and emergency dependent and may be added, changed or deleted.

Fairfieldfireschool.com

*Note: This will NOT show all facility usage or inside classes

September 2013

September 3
FRFS Firefighter II Begins
6:30 p.m.—10 p.m.
Weekends 8:00 a.m.—4:30 p.m.
COST \$400
(Baker)

September 7
Q Endorsement Class Begins
8:30 a.m.—4:30 p.m.
\$275 per student
Attendance at all classes is
MANDATORY
(Acanfora)

September 9
CFA Public Information
Officer Begins
8:30 a.m.—4:30 p.m.
Applications must be sent through the
Connecticut Fire Academy

September 11
Fire Training Series TBA
6:30 p.m.—9:30 p.m.
\$35 per student
(Higgins)

September 22
Thermal Imaging Day
8:30 a.m.—4:30 p.m.
COST TBA
(Mate)

Sun	Mon	Tue	Wed	Thu	Fri	Sat
1	2 <i>Labor Day</i>	3 * FFII: Building Construction	4	5 * FFII: Rescue & Extrication	6	7 * Q Endorsement
8 * Q Endorsement	9 * Public Info. Officer	10 * Public Info. Officer * FFII: Water Supply	11 * Fire Training Series	12 * FFII: Fire Hose	13	14 * Q Endorsement * FFII: Rescue & Extrication (P)
15 * FFII: Company Ops. * Q Endorsement	16	17 * FFII: Fire Streams	18	19 * FFII: Evidence Preservation	20	21 * Q Endorsement
22 * Q Endorsement * Thermal Imaging	23	24 * FFII: Prevention & Education	25	26 * FFII: Calling the Mayday	27	28 * FFII: Calling the Mayday Practical * Q Endorsement
29 * FFII: Water Supply, Hose & Fire Streams	30					

Fairfield Regional Fire School

205 One Rod Highway
Fairfield, CT 06824

Fairfieldfireschool.org

Phone: 203-254-4708

Fax: 203-254-4719

Email: FRFS@town.fairfield.ct.us



QUESTIONS?