

**Illinois Department
of Transportation**
**Local Public Agency
Material Proposal or
Deliver & Install
Proposal**

PROPOSAL SUBMITTED BY		
Contractor's Name		
Street	P.O. Box	
City	State	Zip Code

STATE OF ILLINOIS

COUNTY OF GrundyErienna Township

(Name of City, Village, Town or Road District)

FOR THE IMPROVEMENT OF

STREET NAME OR ROUTE NO. VariousSECTION NO. 19-03000-00-GMTYPES OF FUNDS Local☐ MATERIAL PROPOSAL☒ DELIVER & INSTALL PROPOSAL☒ SPECIFICATIONS (required)☒ PLANS (if applicable)**For Municipal Projects**

Submitted/Approved/Passed

☐ Mayor ☐ President of Board of Trustees ☐ Municipal Official

Date

Department of Transportation☐ Released for bid based on limited review

Regional Engineer

Date

For County and Road District Projects

Submitted/Approved

Highway Commissioner

Date

Submitted/Approved

County Engineer/Superintendent of Highways

Date

Note: All proposal documents, including Proposal Guaranty Checks or Proposal Bid Bonds, should be stapled together to prevent loss when bids are processed.

NOTICE TO BIDDERS

County Grundy
 Local Public Agency Erienna Township
 Section Number 19-03000-00-GM
 Route Various

Sealed proposals for the furnishing or delivering & installing materials required in the construction/maintenance of the above Section will be received and at that time publicly opened and read at the office of Grundy County Highway Dept.,

245 N. Illinois Route 47, Morris, IL. 60450

Address

until

10:00 AM

Time

on

August 16, 2019

Date

- Plans and proposal forms will be available in the office of Grundy County Highway Dept.
245 N. Illinois Route 47, Morris, IL. 60450
 Address
- ☒ Prequalification. If checked, the 2 low bidders must file within 24 hours after the letting an "Affidavit of Availability" (Form BC 57), in duplicate, showing all uncompleted contracts awarded to them and all low bids pending award for Federal, State, County, Municipal and private work.
- The Awarding Authority reserves the right to waive technicalities and to reject any or all proposals as provided in BLRS Special Provision for Bidding Requirements and Conditions for Material Proposals.
- A proposal guaranty in the proper amount, as specified in BLRS Special Provision for Bidding Requirements and Conditions for Material Proposals, will be required. Bid Bonds will not be allowed as a proposal guaranty.
- The successful bidder at the time of execution of the contract will not be required to deposit a contract bond for the full amount of the award. When a contract bond is not required, the proposal guaranty check will be held in lieu thereof. Failure on the part of the contractor to deliver the material within the time specified or to do the work specified herein will be considered just cause to forfeit his surety as provided in Article 108.10 of the Standard Specifications.
- Proposals shall be submitted on forms furnished by the Awarding Authority and shall be enclosed in an envelope endorsed "Material Proposal, Section 19-03000-00-GM".

By Order of Grundy County Board
 (Awarding Authority)

07/30/2019
 Date

Eric Gibson, P.E.
 (County Engineer/Superintendent of Highways/Municipal Clerk)

Material Proposal or Deliver & Install Proposal

To Grundy County Board
 (Awarding Authority)

If this bid is accepted within 45 days from date of opening, the undersigned agrees to furnish or to deliver & install any or all of the materials, at the quoted unit prices, subject to the following:

- It is understood and agreed that the "Standard Specifications for Road and Bridge Construction", adopted April 1, 2016, and the "Supplemental Specifications and Recurring Special Provisions", adopted January 1, 2019, prepared by the Department of Transportation, shall govern insofar as they may be applied and insofar as they do not conflict with the special provisions and supplemental specifications attached hereto.
- It is understood that quantities listed are approximate only and that they may be increased or decreased as may be needed to properly complete the improvement within its present limits or extensions thereto, at the unit price stated and that bids will be compared on the basis of the total price bid for each group.
- Delivery in total or partial shipments as ordered shall be made within the time specified in the special provisions or by the acceptance at the point and in the manner specified in the "Schedule of Prices". If delivery on the job site is specified, it shall mean any place or places on the road designated by the awarding authority or its authorized representative.
- The contractor and/or local agency performing the actual material placement operations shall be responsible for providing work zone traffic control, unless otherwise specified in this proposal. Such devices shall meet the requirements of and be installed in accordance with applicable provisions of the "Illinois Manual on Uniform Traffic Control Devices" and any referenced Illinois Highway Standards.
- Each pay item should have a unit price and a total price. If no total price is shown or if there is a discrepancy between the product of the unit price multiplied by the quantity, the unit price shall govern. If a unit price is omitted, the total price will be divided by the quantity in order to establish a unit price. A bid will be declared unacceptable if neither a unit price nor a total price is shown.

Discounts will be allowed for payment as follows: _____ % _____ calendar days: _____ % _____ calendar days.

Discounts will not be considered in determining the low bidder.

Bidder _____

By _____
 (Signature)

Address _____

Title _____

[illegible]

The undersigned firm certifies that it has not been convicted of bribery or attempting to bribe an officer or employee of the State of Illinois, nor has the firm made an admission of guilt of such conduct which is a matter of record, nor has an official, agent or employee of the firm committed bribery or attempted bribery on behalf of the firm and pursuant to the direction or authorization of a responsible official of the firm. The undersigned firm further certifies that it is not barred from contracting with any unit of State or local government as a result of a violation of State laws prohibiting bid-rigging or bid rotating.

Address



Return with Bid

Route	Various
County	Grundv
Local Agency	Erienna Township
Section	19-03000-00-GM

All contractors are required to complete the following certification:

☒ For this contract proposal or for all groups in this deliver and install proposal.

☐ For the following deliver and install groups in this material proposal:

Illinois Department of Transportation policy, adopted in accordance with the provisions of the Illinois Highway Code, requires this contract to be awarded to the lowest responsive and responsible bidder. The award decision is subject to approval by the Department. In addition to all other responsibility factors, this contract or deliver and install proposal requires all bidders and all bidders' subcontractors to disclose participation in apprenticeship or training programs that are (1) approved by and registered with the United States Department of Labor's Bureau of Apprenticeship and Training, and (2) applicable to the work of the above indicated proposals or groups. Therefore, all bidders are required to complete the following certification:

- I. Except as provided in paragraph IV below, the undersigned bidder certifies that it is a participant, either as an individual or as part of a group program, in an approved apprenticeship or training program applicable to each type of work or craft that the bidder will perform with its own employees.
- II. The undersigned bidder further certifies for work to be performed by subcontract that each of its subcontractors submitted for approval either (A) is, at the time of such bid, participating in an approved, applicable apprenticeship or training program; or (B) will, prior to commencement of performance of work pursuant to this contract, establish participation in an approved apprenticeship or training program applicable to the work of the subcontract.
- III. The undersigned bidder, by inclusion in the list in the space below, certifies the official name of each program sponsor holding the Certificate of Registration for all of the types of work or crafts in which the bidder is a participant and that will be performed with the bidder's employees. Types of work or craft that will be subcontracted shall be included and listed as subcontract work. The list shall also indicate any type of work or craft job category for which there is no applicable apprenticeship or training program available.

- IV. Except for any work identified above, any bidder or subcontractor that shall perform all or part of the work of the contract or deliver and install proposal solely by individual owners, partners or members and not by employees to whom the payment of prevailing rates of wages would be required, check the following box, and identify the owner/operator workforce and positions of ownership. ☐

The requirements of this certification and disclosure are a material part of the contract, and the contractor shall require this certification provision to be included in all approved subcontracts. The bidder is responsible for making a complete report and shall make certain that each type of work or craft job category that will be utilized on the project is accounted for and listed. The Department at any time before or after award may require the production of a copy of each applicable Certificate of Registration issued by the United States Department of Labor evidencing such participation by the contractor and any or all of its subcontractors. In order to fulfill the participation requirement, it shall not be necessary that any applicable program sponsor be currently taking or that it will take applications for apprenticeship, training or employment during the performance of the work of this contract or deliver and install proposal.

Bidder: _____

By: _____

(Signature)

Address: _____

Title: _____

**Illinois Department
of Transportation**
Affidavit of Illinois Business Office

County Grundy
 Local Public Agency Erienna Township
 Section Number 19-03000-00-GM
 Route Various

State of _____)
) ss.
 County of _____)

I, _____ of _____, _____,
 (Name of Affiant) (City of Affiant) (State of Affiant)

being first duly sworn upon oath, states as follows:

1. That I am the _____ of _____
 officer or position bidder
 2. That I have personal knowledge of the facts herein stated.
 3. That, if selected under this proposal, _____, will maintain a
 (bidder)
- business office in the State of Illinois which will be located in _____ County, Illinois.
4. That this business office will serve as the primary place of employment for any persons employed in the construction contemplated by this proposal.
 5. That this Affidavit is given as a requirement of state law as provided in Section 30-22(8) of the Illinois Procurement Code.

 (Signature)

 (Print Name of Affiant)

This instrument was acknowledged before me on _____ day of _____, _____.

(SEAL)

 (Signature of Notary Public)



Affidavit of Availability For the Letting of

Part I. Work Under Contract

	1	2	3	4	Awards Pending	
Contract Number						
Contract With						
Estimated Completion Date						
Total Contract Price						Accumulated Totals
Uncompleted Dollar Value if Firm is the Prime Contractor						
Uncompleted Dollar Value if Firm is the Subcontractor						
				Total Value of All Work		

List below the uncompleted dollar value of work for each contract and awards pending to be completed with your own forces. All work subcontracted to others will be listed on the reverse of this form. In a joint venture, list only that portion of the work to be done by your company. If no work is contracted, show NONE.

Earthwork						
Portland Cement Concrete Paving						
HMA Plant Mix						
HMA Paving						
Clean & Seal Cracks/Joints						
Aggregate Bases & Surfaces						
Highway, R.R. and Waterway Structures						
Drainage						
Electrical						
Cover and Seal Coats						
Concrete Construction						
Landscaping						
Fencing						
Guardrail						
Painting						
Signing						
Cold Milling, Planning & Rotomilling						
Demolition						
Pavement Markings (Paint)						
Other Construction (List)						
						\$ 0.00
Totals						

Printed 7/30/2019

Part III. Work Subcontracted to Others.

For each contract described in Part I, list all the work you have subcontracted to others.

	1	2	3	4	Awards Pending
Subcontractor					
Type of Work					
Subcontract Price					
Amount Uncompleted					
Subcontractor					
Type of Work					
Subcontract Price					
Amount Uncompleted					
Subcontractor					
Type of Work					
Subcontract Price					
Amount Uncompleted					
Subcontractor					
Type of Work					
Subcontract Price					
Amount Uncompleted					
Subcontractor					
Type of Work					
Subcontract Price					
Amount Uncompleted					
Subcontractor					
Type of Work					
Subcontract Price					
Amount Uncompleted					
Total Uncompleted					

I, being duly sworn, do hereby declare that this affidavit is a true and correct statement relating to ALL uncompleted contracts of the undersigned for Federal, State, County, City and private work, including ALL subcontract work, ALL pending low bids not yet awarded or rejected and ALL estimated completion dates.

Subscribed and sworn to before me

this _____ day of _____, _____ Type or Print Name _____
 _____ Officer or Director _____ Title

Signed _____

Notary Public

My commission expires _____

(Notary Seal)

Company _____

Address _____



The Following Recurring Special Provisions Indicated By An "X" Are Applicable To This Contract And Are Included By Reference:

Recurring Special Provisions

<u>Check Sheet #</u>		<u>Page No.</u>
1	<input type="checkbox"/> Additional State Requirements for Federal-Aid Construction Contracts	75
2	<input type="checkbox"/> Subletting of Contracts (Federal-Aid Contracts)	78
3	<input type="checkbox"/> EEO	79
4	<input type="checkbox"/> Specific EEO Responsibilities Non Federal-Aid Contracts	89
5	<input type="checkbox"/> Required Provisions - State Contracts	94
6	<input type="checkbox"/> Asbestos Bearing Pad Removal	100
7	<input type="checkbox"/> Asbestos Waterproofing Membrane and Asbestos HMA Surface Removal	101
8	<input type="checkbox"/> Temporary Stream Crossings and In-Stream Work Pads	102
9	<input type="checkbox"/> Construction Layout Stakes Except for Bridges	103
10	<input type="checkbox"/> Construction Layout Stakes	106
11	<input type="checkbox"/> Use of Geotextile Fabric for Railroad Crossing	109
12	<input type="checkbox"/> Subsealing of Concrete Pavements	111
13	<input type="checkbox"/> Hot-Mix Asphalt Surface Correction	115
14	<input type="checkbox"/> Pavement and Shoulder Resurfacing	117
15	<input type="checkbox"/> Patching with Hot-Mix Asphalt Overlay Removal	118
16	<input type="checkbox"/> Polymer Concrete	120
17	<input type="checkbox"/> PVC Pipeliner	122
18	<input type="checkbox"/> Bicycle Racks	123
19	<input type="checkbox"/> Temporary Portable Bridge Traffic Signals	125
20	<input type="checkbox"/> Work Zone Public Information Signs	127
21	<input type="checkbox"/> Nighttime Inspection of Roadway Lighting	128
22	<input type="checkbox"/> English Substitution of Metric Bolts	129
23	<input type="checkbox"/> Calcium Chloride Accelerator for Portland Cement Concrete	130
24	<input type="checkbox"/> Quality Control of Concrete Mixtures at the Plant	131
25	<input type="checkbox"/> Quality Control/Quality Assurance of Concrete Mixtures	139
26	<input type="checkbox"/> Digital Terrain Modeling for Earthwork Calculations	155
27	<input type="checkbox"/> Reserved	157
28	<input checked="" type="checkbox"/> Preventive Maintenance - Bituminous Surface Treatment	158
29	<input type="checkbox"/> Reserved	164
30	<input type="checkbox"/> Reserved	165
31	<input type="checkbox"/> Reserved	166
32	<input type="checkbox"/> Temporary Raised Pavement Markers	167
33	<input type="checkbox"/> Restoring Bridge Approach Pavements Using High-Density Foam	168
34	<input type="checkbox"/> Portland Cement Concrete Inlay or Overlay	171
35	<input type="checkbox"/> Portland Cement Concrete Partial Depth Hot-Mix Asphalt Patching	175

The Following Local Roads And Streets Recurring Special Provisions Indicated By An "X" Are Applicable To This Contract And Are Included By Reference:

Local Roads And Streets Recurring Special Provisions

<u>Check Sheet #</u>		<u>Page No.</u>
LRS 1	Reserved	179
LRS 2	<input type="checkbox"/> Furnished Excavation	180
LRS 3	<input type="checkbox"/> Work Zone Traffic Control Surveillance	181
LRS 4	<input checked="" type="checkbox"/> Flaggers in Work Zones	182
LRS 5	<input checked="" type="checkbox"/> Contract Claims	183
LRS 6	<input type="checkbox"/> Bidding Requirements and Conditions for Contract Proposals	184
LRS 7	<input checked="" type="checkbox"/> Bidding Requirements and Conditions for Material Proposals	190
LRS 8	Reserved	196
LRS 9	<input checked="" type="checkbox"/> Bituminous Surface Treatments	197
LRS 10	Reserved	198
LRS 11	<input checked="" type="checkbox"/> Employment Practices	199
LRS 12	<input checked="" type="checkbox"/> Wages of Employees on Public Works	201
LRS 13	<input checked="" type="checkbox"/> Selection of Labor	203
LRS 14	<input type="checkbox"/> Paving Brick and Concrete Paver Pavements and Sidewalks	204
LRS 15	<input checked="" type="checkbox"/> Partial Payments	207
LRS 16	<input checked="" type="checkbox"/> Protests on Local Lettings	208
LRS 17	<input checked="" type="checkbox"/> Substance Abuse Prevention Program	209
LRS 18	<input type="checkbox"/> Multigrade Cold Mix Asphalt	210

BDE SPECIAL PROVISIONS
For the January 18, 2019 and March 8, 2019 Lettings

The following special provisions indicated by a "check mark" are applicable to this contract and will be included by the Project Coordination and Implementation Section of the BD&E. An * indicates a new or revised special provision for the letting.

File Name #		Special Provision Title	Effective	Revised
80099	1	<input type="checkbox"/> Accessible Pedestrian Signals (APS)	April 1, 2003	Jan. 1, 2014
80274	2	<input type="checkbox"/> Aggregate Subgrade Improvement	April 1, 2012	April 1, 2016
80192	3	<input type="checkbox"/> Automated Flagger Assistance Device	Jan. 1, 2008	
80173	4	<input type="checkbox"/> Bituminous Materials Cost Adjustments	Nov. 2, 2006	Aug. 1, 2017
80241	5	<input type="checkbox"/> Bridge Demolition Debris	July 1, 2009	
50261	6	<input type="checkbox"/> Building Removal-Case I (Non-Friable and Friable Asbestos)	Sept. 1, 1990	April 1, 2010
50481	7	<input type="checkbox"/> Building Removal-Case II (Non-Friable Asbestos)	Sept. 1, 1990	April 1, 2010
50491	8	<input type="checkbox"/> Building Removal-Case III (Friable Asbestos)	Sept. 1, 1990	April 1, 2010
50531	9	<input type="checkbox"/> Building Removal-Case IV (No Asbestos)	Sept. 1, 1990	April 1, 2010
* 80404	10	<input type="checkbox"/> Coarse Aggregate Quality for Micro-Surfacing and Cape Seals	Jan. 1, 2019	
80384	11	<input type="checkbox"/> Compensable Delay Costs	June 2, 2017	
80198	12	<input type="checkbox"/> Completion Date (via calendar days)	April 1, 2008	
80199	13	<input type="checkbox"/> Completion Date (via calendar days) Plus Working Days	April 1, 2008	
80293	14	<input type="checkbox"/> Concrete Box Culverts with Skews > 30 Degrees and Design Fills ≤ 5 Feet	April 1, 2012	July 1, 2016
80311	15	<input type="checkbox"/> Concrete End Sections for Pipe Culverts	Jan. 1, 2013	April 1, 2016
80277	16	<input type="checkbox"/> Concrete Mix Design – Department Provided	Jan. 1, 2012	April 1, 2016
80261	17	<input type="checkbox"/> Construction Air Quality – Diesel Retrofit	June 1, 2010	Nov. 1, 2014
80387	18	<input type="checkbox"/> Contrast Preformed Plastic Pavement Marking	Nov. 1, 2017	
80029	19	<input type="checkbox"/> Disadvantaged Business Enterprise Participation	Sept. 1, 2000	April 2, 2018
80402	20	<input type="checkbox"/> Disposal Fees	Nov. 1, 2018	
80378	21	<input type="checkbox"/> Dowel Bar Inserter	Jan. 1, 2017	Jan. 1, 2018
* 80405	22	<input type="checkbox"/> Elastomeric Bearings	Jan. 1, 2019	
80388	23	<input type="checkbox"/> Equipment Parking and Storage	Nov. 1, 2017	
80229	24	<input type="checkbox"/> Fuel Cost Adjustment	April 1, 2009	Aug. 1, 2017
80304	25	<input type="checkbox"/> Grooving for Recessed Pavement Markings	Nov. 1, 2012	Nov. 1, 2017
80246	26	<input type="checkbox"/> Hot-Mix Asphalt – Density Testing of Longitudinal Joints	Jan. 1, 2010	Aug. 1, 2018
* 80406	27	<input type="checkbox"/> Hot-Mix Asphalt – Mixture Design Verification and Production (Modified for I-FIT Projects)	Jan. 1, 2019	
* 80398	28	<input type="checkbox"/> Hot-Mix Asphalt – Longitudinal Joint Sealant	Aug. 1, 2018	Jan. 1, 2019
80399	29	<input type="checkbox"/> Hot-Mix Asphalt – Oscillatory Roller	Aug. 1, 2018	Nov. 1, 2018
80347	30	<input type="checkbox"/> Hot-Mix Asphalt – Pay for Performance Using Percent Within Limits – Jobsite Sampling	Nov. 1, 2014	Aug. 1, 2018
* 80383	31	<input type="checkbox"/> Hot-Mix Asphalt – Quality Control for Performance	April 1, 2017	Jan. 1, 2019
80376	32	<input type="checkbox"/> Hot-Mix Asphalt – Tack Coat	Nov. 1, 2016	
80392	33	<input type="checkbox"/> Lights on Barricades	Jan. 1, 2018	
80336	34	<input type="checkbox"/> Longitudinal Joint and Crack Patching	April 1, 2014	April 1, 2016
* 80393	35	<input type="checkbox"/> Manholes, Valve Vaults, and Flat Slab Tops	Jan. 1, 2018	Jan. 1, 2019
80400	36	<input type="checkbox"/> Mast Arm Assembly and Pole	Aug. 1, 2018	
80045	37	<input type="checkbox"/> Material Transfer Device	June 15, 1999	Aug. 1, 2014
80394	38	<input type="checkbox"/> Metal Flared End Section for Pipe Culverts	Jan. 1, 2018	April 1, 2018
80165	39	<input type="checkbox"/> Moisture Cured Urethane Paint System	Nov. 1, 2006	Jan. 1, 2010
80349	40	<input type="checkbox"/> Pavement Marking Blackout Tape	Nov. 1, 2014	April 1, 2016
80371	41	<input type="checkbox"/> Pavement Marking Removal	July 1, 2016	
80390	42	<input type="checkbox"/> Payments to Subcontractors	Nov. 2, 2017	
80389	43	<input type="checkbox"/> Portland Cement Concrete	Nov. 1, 2017	
80359	44	<input type="checkbox"/> Portland Cement Concrete Bridge Deck Curing	April 1, 2015	Nov. 1, 2017
80401	45	<input type="checkbox"/> Portland Cement Concrete Pavement Connector for Bridge Approach Slab	Aug. 1, 2018	

80300	46	<input type="checkbox"/>	Preformed Plastic Pavement Marking Type D - Inlaid	April 1, 2012	April 1, 2016
80328	47	<input type="checkbox"/>	Progress Payments	Nov. 2, 2013	
34261	48	<input type="checkbox"/>	Railroad Protective Liability Insurance	Dec. 1, 1986	Jan. 1, 2006
80157	49	<input type="checkbox"/>	Railroad Protective Liability Insurance (5 and 10)	Jan. 1, 2006	
* 80306	50	<input type="checkbox"/>	Reclaimed Asphalt Pavement (RAP) and Reclaimed Asphalt Shingles (RAS)	Nov. 1, 2012	Jan. 1, 2019
* 80407	51	<input type="checkbox"/>	Removal and Disposal of Regulated Substances	Jan. 1, 2019	
80395	52	<input type="checkbox"/>	Sloped Metal End Section for Pipe Culverts	Jan. 1, 2018	
80340	53	<input type="checkbox"/>	Speed Display Trailer	April 2, 2014	Jan. 1, 2017
80127	54	<input type="checkbox"/>	Steel Cost Adjustment	April 2, 2004	Aug. 1, 2017
* 80408	55	<input type="checkbox"/>	Steel Plate Beam Guardrail Manufacturing	Jan. 1, 2019	
80397	56	<input type="checkbox"/>	Subcontractor and DBE Payment Reporting	April 2, 2018	
80391	57	<input type="checkbox"/>	Subcontractor Mobilization Payments	Nov. 2, 2017	
80317	58	<input type="checkbox"/>	Surface Testing of Hot-Mix Asphalt Overlays	Jan. 1, 2013	April 1, 2016
80298	59	<input type="checkbox"/>	Temporary Pavement Marking	April 1, 2012	April 1, 2017
20338	60	<input type="checkbox"/>	Training Special Provisions	Oct. 15, 1975	
80403	61	<input type="checkbox"/>	Traffic Barrier Terminal, Type 1 Special	Nov. 1, 2018	
* 80409	62	<input type="checkbox"/>	Traffic Control Devices - Cones	Jan. 1, 2019	
* 80410	63	<input type="checkbox"/>	Traffic Spotters	Jan. 1, 2019	
80318	64	<input type="checkbox"/>	Traversable Pipe Grate for Concrete End Sections	Jan. 1, 2013	Jan. 1, 2018
80288	65	<input type="checkbox"/>	Warm Mix Asphalt	Jan. 1, 2012	April 1, 2016
80302	66	<input type="checkbox"/>	Weekly DBE Trucking Reports	June 2, 2012	April 2, 2015
80071	67	<input type="checkbox"/>	Working Days	Jan. 1, 2002	

The following special provisions are in the 2019 Supplemental Specifications and Recurring Special Provisions.

<u>File Name</u>	<u>Special Provision Title</u>	<u>New Location(s)</u>	<u>Effective</u>	<u>Revised</u>
80382	Adjusting Frames and Grates	Articles 602.02(s) and (t), 1043.04, and 1043.05	April 1, 2017	
80366	Butt Joints	Article 406.08(c)	July 1, 2016	
80386	Calcium Aluminate Cement for Class PP-5 Concrete Patching	Article 1001.01(e)	Nov. 1, 2017	
80396	Class A and B Patching	Articles 442.06(a)(1) and (2)	Jan. 1, 2018	Nov. 1, 2018
80377	Portable Changeable Message Signs	Articles 701.20(h) and 1106.02(i)	Nov. 1, 2016	April 1, 2017
80385	Portland Cement Concrete Sidewalk	Article 424.12	Aug. 1, 2017	

The following special provisions require additional information from the designer. The additional information needs to be submitted as a separate document. The Project Coordination and Implementation section will then include the information in the applicable special provision.

- Bridge Demolition Debris
- Building Removal - Case I
- Building Removal - Case II
- Building Removal - Case III
- Building Removal-Case IV
- Completion Date
- Completion Date Plus Working Days
- DBE Participation
- Material Transfer Device
- Railroad Protective Liability Insurance
- Training Special Provisions
- Working Days



Special Provisions

The following Special Provisions supplement the "Standard Specifications for Road and Bridge Construction", Adopted April 1, 2016, the latest edition of the "Manual on Uniform Traffic Control Devices for Streets and Highways", and the "Manual of Test Procedures of Materials" in effect on the date of invitation of bids, and the Supplemental Specifications and Recurring Special Provisions indicated on the Check Sheet included here in which apply to and govern the construction of Section: **19-03000-00-GM** and in case of conflict with any part, or parts, of said Specifications, the said Special Provisions shall take precedence and shall govern.

DESCRIPTION OF WORK

The work of this Section consists of the application of a Bituminous Surface Treatment, Class A-1 and/or A-2 in accordance with the applicable portions of Section 403 of the Standard Specification. This work shall be done in various widths and locations as shown in the enclosed Schedule of Quantities and Locations Maps.

MATERIALS AND RATES OF APPLICATION

The materials shall be applied on the road in accordance with the applicable portions of Section 403 of the Standard Specifications with the following revisions:

1. Cover Coat and Seal Coat Aggregates - The Cover and Seal Coat Aggregates shall be crushed stone as specified in Section 1004 of the Standard Specifications and shall be CA-14 for Cover Coat and CA-13, CA-15 or CA-16 for Seal Coat. (See Schedule of Prices sheet for stone size of Seal Coat on particular Township.)
2. Revise Article 1004.01(b)6/ of the Standard Specifications to read: For crushed aggregate, if the material finer than the No. 200 sieve consists of the dust from fracture, essentially free from clay or silt, this percentage shall not exceed 2.0%.
3. Bituminous Materials - The Bituminous Material shall meet the requirements of Article 403.02 of the Standard Specifications and shall be the grade MC-30 or PEP for Prime Coat and Hot Oil and HFP for A-1 and A-2. **Note: All Bituminous Materials will be paid for by the Gallon.**

	<u>BITUMINOUS MATERIAL</u>	<u>AGGREGATE</u>
Prime Coat	0.35 Gal./ Sq. Yd.	
Cover Coat	0.35 Gal./Sq. Yd.	25 Lbs./Sq. Yd.
Seal Coat	(A-1) 0.35 Gal./Sq. Yd.	(A-1) 25 Lbs./Sq. Yd.
	(A-2) 0.38 Gal./Sq. Yd.	(A-2) 22 Lbs./Sq. Yd.



Special Provisions

(A-2) 0.38 Gal./Sq. Yd.

(A-2) 22 Lbs./Sq. Yd.

PREPARATION OF BASE

Revise the first sentence of the second paragraph of Article 358.04(b) to read: After the surface of the base course has been brought to a smooth grade and proper crown, each mile shall be compacted by repeated wetting and rolling with a pneumatic-tired roller for a period of not less than six (6) hours. A steel drum wheel roller may be used instead of a pneumatic-tired roller if approved by the Engineer.

Revise the third sentence of the second paragraph of Article 358.04(b) to read: Before a prime coat is applied, the base shall be surface dry, but at no time shall the period of drying be less than four (4) hours. No priming shall be performed after 7:00 P.M. The Engineer shall be the sole judge of drying time.

WIDTH OF APPLICATION

The application may be applied to the full width except that if satisfactory results are not being attained, the application shall be applied to one lane at a time as directed by the Engineer.

APPLICATION OF BITUMINOUS MATERIAL

The third paragraph of Article 403.10 shall be strictly enforced.

EQUIPMENT

The pneumatic-tired roller as specified in Article 403.03 shall be a self-propelled roller in accordance with Article 1101.01 of the Standard Specifications. A Steel Wheel Roller shall also be used and meet the requirements of Article 1101.01(e).

FOG SEAL

This work shall consist of furnishing and applying a diluted asphalt emulsion Fog Seal Coat to an existing bituminous pavement.

Immediately prior to placing the fog seal the contractor shall clean the existing surface in accordance with Section 358.05 of the Standard Specification for Road and Bridge Construction.

The asphalt material used shall be SS-1h and shall be diluted with water at the supplier's terminal prior to transport.

The Fog Seal shall not be applied to damp surfaces, if rain is imminent or if pavement or air temperatures are below 60°F.

The Fog Seal shall be applied at a rate between 0.10 and 0.15 gallons per square yard which shall be accomplished in two (2) separate applications made in



Special Provisions

opposite directions. A pressure distributor that conforms with Section 1102.05 of the Standard Specifications shall be used.

During construction, the contractor shall insure that a minimum of one lane of traffic shall be open to traffic at all times. The contractor shall provide traffic control per the Highway Standard 701201. The cost of the traffic control shall be included in the pay items as no additional compensation will be provided for traffic control. The road may be opened to traffic when the asphalt has cured sufficiently so that it will not pick up.

Basis of payment will be at the contract unit price bid per SQUARE YARD for FOG SEAL which shall include all costs associated for furnishing and applying the material in accordance with this specification.

PROSECUTION OF WORK

Revise the first sentence of Article 108.03 of the Standard Specifications to read: The Contractor shall begin the work to be performed under this Section not later than ten (10) days after receiving written notice from the Grundy County Engineer.

MOBILIZATION

Provisions of Section 671 of the "Standard Specifications for Road and Bridge Construction" are not applicable to this Proposal.

RESPONSIBILITY OF THE CONTRACTOR

The contractor shall notify the Engineer and township commissioner a minimum of 48 hours prior to the commencement of work.

Should a conflict be discovered between these plans and conditions in the field, the contractor shall notify the Engineer immediately of the issue(s). No work that will directly affect or be affected by the conflict may proceed without the Engineer's approval.

TRAFFIC CONTROL

All Traffic Control Standards shall be incidental to the contract. The Contractor shall be responsible for all traffic control operations as follows, with no additional compensation being allowed:

1. The Contractor shall provide two pickup trucks, each equipped with a mounted yellow flashing light, a mounted Road Closed sign (R11-2), and a mounted "Fresh Oil" sign (W21-2). These trucks shall be placed at the intersection immediately ahead of and behind the Seal Coat operation to control the traffic.



Special Provisions

2. The Contractor shall equip all of his / her oil distributors, chip spreaders, and rollers with a mounted yellow flashing light.
3. The Contractor shall equip all of his / her rollers with a "Fresh Oil" sign (W21-2).
4. The Contractor shall place a "Road Closed Ahead" sign (W20-3) 750 feet prior to the intersection where the required pickup truck is controlling traffic if the pickup truck is not visible at that point to oncoming traffic.
5. All traffic control devices shall comply with Highway Standard 701901, Highway Standard B.L.R. 17-4 and the Manual on Uniform Traffic Control Devices - 2009 Edition. Type I or II Barricades may be used in lieu of Type III Barricades where road closure is for a short period of time and involves the movement from one location to another.

KEEPING ROAD OPEN TO TRAFFIC

The roads involved in this Section shall be kept open to two-way traffic at all times except when construction operations require, as directed by the Engineer. The Engineer will be the sole judge as to the necessity of lane closures and the length and duration of same. The Engineer may add requirements and/or conditions for the closure as they deem necessary. The contractor shall maintain access to private property throughout the limits of the improvement in accordance with the applicable portions of Article 107.09 and Article 107.14 of the "Standard Specifications", and as directed by the Engineer.

COMPLETION DATE PLUS WORKING DAYS

Revised Article 108.05(b) of the Standard Specifications to read:

"(b) Completion Date Plus Working Days. When a completion date plus working days is specified, the Contractor shall complete the project by 11:59 p.m. on or prior to November 8, 2019. The PROJECT shall have all work completed, except the punch list items for the PROJECT to be considered complete.

The Contractor will be allowed 5 working days after the completion date to complete punch list items.

State of Illinois
Department of Transportation
Bureau of Local Roads and Streets

SPECIAL PROVISION
FOR
INSURANCE

Effective: February 1, 2007
Revised: August 1, 2007

All references to Sections or Articles in this specification shall be construed to mean specific Section or Article of the Standard Specifications for Road and Bridge Construction, adopted by the Department of Transportation.

The Contractor shall name the following entities as additional insured under the Contractor's general liability insurance policy in accordance with Article 107.27:

Erienna Township

The entities listed above and their officers, employees, and agents shall be indemnified and held harmless in accordance with Article 107.26.

State of Illinois
Department of Transportation
Bureau of Local Roads and Streets
SPECIAL PROVISION
FOR
CONSTRUCTION AND MAINTENANCE SIGNS

Effective: January 1, 2004
Revised: June 1, 2007

All references to Sections or Articles in this specification shall be construed to mean a specific Section or Article of the Standard Specifications for Road and Bridge Construction, adopted by the Department of Transportation.

701.14. Signs. Add the following paragraph to Article 701.14:

All warning signs shall have minimum dimensions of 1200 mm x 1200 mm (48" x 48") and have a black legend on a fluorescent orange reflectorized background, meeting, as a minimum, Type AP reflectivity requirements of Table 1091-2 in Article 1091.02.

Grundy County Prevailing Wage for 2019

Trade Title	Region	Type	Class	Base Wage	Foreman Wage	OT M-F	OT Sa	OT Su	OT Hol	H/W	Pension	Vacation	Training
ASBESTOS ABT-GEN	All	ALL		42.72	43.72	1.5	1.5	2	2	14.9	12.57	0	0.72
ASBESTOS ABT-MEC	All	BLD		37.88	40.38	1.5	1.5	2	2	12.92	11.82	0	0.72
BOILERMAKER	All	BLD		49.46	53.91	2	2	2	2	6.97	20.41	0	0.4
BRICK MASON	All	BLD		46.19	50.81	1.5	1.5	2	2	10.65	17.92	0	0.92
CARPENTER	All	ALL		47.35	52.09	1.5	1.5	2	2	11.79	20.42	0	0.63
CEMENT MASON	All	ALL		42	44	2	1.5	2	2	10.25	26.02	0	0.5
CERAMIC TILE FINISHER	All	BLD		39.56	39.56	1.5	1.5	2	2	10.75	12.02	0	0.77
COMMUNICATION TECH	All	BLD		36	37.5	1.5	1.5	2	2	14.92	13.44	1.5	0.72
ELECTRIC PWR EQMT OP	All	ALL		51.9	56.9	1.5	1.5	2	2	12.04	17.18	0	3.23
ELECTRIC PWR GRNDMAN	All	ALL		40.48	56.9	1.5	1.5	2	2	9.39	13.4	0	2.51
ELECTRIC PWR LINEMAN	All	ALL		51.9	56.9	1.5	1.5	2	2	12.04	17.18	0	3.23
ELECTRICIAN	All	BLD		43.5	47.42	1.5	1.5	2	2	15.72	18.34	4	1.2
ELEVATOR CONSTRUCTOR	All	BLD		44.78	50.38	2	2	2	2	15.43	16.61	3.58	0.61
GLAZIER	All	BLD		43.85	45.35	1.5	2	2	2	14.17	21.11	0	0.94
HT/FROST INSULATOR	All	BLD		50.5	53	1.5	1.5	2	2	12.92	13.16	0	0.72
IRON WORKER	All	ALL		43	47.3	2	2	2	2	11.81	25.54	0	0.85
LABORER	All	ALL		42.72	43.72	1.5	1.5	2	2	14.9	12.57	0	0.72
LATHER	All	ALL		47.35	52.09	1.5	1.5	2	2	11.79	20.42	0	0.63
MACHINIST	All	BLD		48.38	50.88	1.5	1.5	2	2	7.23	8.95	1.85	1.47
MARBLE FINISHERS	All	ALL		34.65	47.7	1.5	1.5	2	2	10.65	16.46	0	0.49
MARBLE MASON	All	BLD		45.43	49.97	1.5	1.5	2	2	10.65	17.39	0	0.61
MATERIAL TESTER I	All	ALL		32.72	32.72	1.5	1.5	2	2	14.9	12.57	0	0.72
MATERIALS TESTER II	All	ALL		37.72	37.72	1.5	1.5	2	2	14.9	12.57	0	0.72
MILLWRIGHT	All	ALL		47.35	52.09	1.5	1.5	2	2	11.79	20.42	0	0.63
OPERATING ENGINEER	All	BLD	1	51.1	55.1	2	2	2	2	19.65	15.1	2	1.4
OPERATING ENGINEER	All	BLD	2	49.8	55.1	2	2	2	2	19.65	15.1	2	1.4
OPERATING ENGINEER	All	BLD	3	47.25	55.1	2	2	2	2	19.65	15.1	2	1.4
OPERATING ENGINEER	All	BLD	4	45.5	55.1	2	2	2	2	19.65	15.1	2	1.4
OPERATING ENGINEER	All	BLD	5	54.85	55.1	2	2	2	2	19.65	15.1	2	1.4
OPERATING ENGINEER	All	BLD	6	52.1	55.1	2	2	2	2	19.65	15.1	2	1.4
OPERATING ENGINEER	All	BLD	7	54.1	55.1	2	2	2	2	19.65	15.1	2	1.4
OPERATING ENGINEER	All	FLT		38	38	1.5	1.5	2	2	18.8	14.35	2	1.3
OPERATING ENGINEER	All	HWY	1	49.3	53.3	1.5	1.5	2	2	19.65	15.1	2	1.4
OPERATING ENGINEER	All	HWY	2	48.75	53.3	1.5	1.5	2	2	19.65	15.1	2	1.4
OPERATING ENGINEER	All	HWY	3	46.7	53.3	1.5	1.5	2	2	19.65	15.1	2	1.4
OPERATING ENGINEER	All	HWY	4	45.3	53.3	1.5	1.5	2	2	19.65	15.1	2	1.4
OPERATING ENGINEER	All	HWY	5	44.1	53.3	1.5	1.5	2	2	19.65	15.1	2	1.4
OPERATING ENGINEER	All	HWY	6	52.3	53.3	1.5	1.5	2	2	19.65	15.1	2	1.4
OPERATING ENGINEER	All	HWY	7	50.3	53.3	1.5	1.5	2	2	19.65	15.1	2	1.4
PAINTER	All	ALL		46.55	52.36	1.5	1.5	1.5	2	11.81	11.94	0	1.87
PAINTER SIGNS	All	BLD		38.2	43.25	1.5	1.5	2	2	2.6	9.25	0	0
PILEDRIIVER	All	ALL		47.35	52.09	1.5	1.5	2	2	11.79	20.42	0	0.63
PIPEFITTER	All	BLD		48.5	51.5	1.5	1.5	2	2	10.05	18.85	0	2.22
PLASTERER	All	BLD		43.25	45.85	1.5	1.5	2	2	14.25	16.69	0	1.35
PLUMBER	All	BLD		50.25	53.25	1.5	1.5	2	2	14.34	14.42	0	1.31
ROOFER	All	BLD		34.46	36.46	1.5	1.5	2	2	9.73	11.54	0	0.58
SHEETMETAL WORKER	All	BLD		48.02	50.42	1.5	1.5	2	2	10.75	16.19	0	1.03
SIGN HANGER	All	All		22.99	25.29	1.5	1.5	2	2	3.79	2.5	0	0
SPRINKLER FITTER	All	BLD		48.1	50.6	1.5	1.5	2	2	13.25	15.9	0	0.55
STONE MASON	All	BLD		46.19	50.81	1.5	1.5	2	2	10.65	17.92	0	0.92
TERRAZZO FINISHER	All	BLD		41.54	41.54	1.5	1.5	2	2	10.75	13.71	0	0.86
TERRAZZO MASON	All	BLD		45.38	48.88	1.5	1.5	2	2	10.75	15.17	0	0.89
TILE MASON	All	BLD		46.49	50.49	1.5	1.5	2	2	10.75	14.99	0	0.9
TRUCK DRIVER	All	ALL	1	38.41	38.96	1.5	1.5	2	2	9.15	10.43	0	0.15
TRUCK DRIVER	All	ALL	2	38.56	38.96	1.5	1.5	2	2	9.15	10.43	0	0.15
TRUCK DRIVER	All	ALL	3	38.76	38.96	1.5	1.5	2	2	9.15	10.43	0	0.15
TRUCK DRIVER	All	ALL	4	38.96	38.96	1.5	1.5	2	2	9.15	10.43	0	0.15
TUCKPINTER	All	BLD		46	47	1.5	1.5	2	2	8.34	16.81	0	0.93

Grundy County Prevailing Wage for 2019

Legend

M-F OT Unless otherwise noted, OT pay is required for any hour greater than 8 worked each day, Mon through Fri. The number listed is the multiple of the base wage.

OSA Overtime pay required for every hour worked on Saturdays

OSH Overtime pay required for every hour worked on Sundays and Holidays

H/W Health/Welfare benefit

Explanations GRUNDY COUNTY

PLUMBERS & PIPEFITTERS (WEST) - That part of the county West of Rt. 47 excluding the City of Morris.

The following list is considered as those days for which holiday rates of wages for work performed apply: New Years Day, Memorial Day, Fourth of July, Labor Day, Thanksgiving Day, Christmas Day and Veterans Day in some classifications/counties. Generally, any of these holidays which fall on a Sunday is celebrated on the following Monday. This then makes work performed on that Monday payable at the appropriate overtime rate for holiday pay. Common practice in a given local may alter certain days of celebration. If in doubt, please check with IDOL.

EXPLANATION OF CLASSES

ASBESTOS - GENERAL - removal of asbestos material/mold and hazardous materials from any place in a building, including mechanical systems where those mechanical systems are to be removed. This includes the removal of asbestos materials/mold and hazardous materials from ductwork or pipes in a building when the building is to be demolished at the time or at some close future date.

ASBESTOS - MECHANICAL - removal of asbestos material from mechanical systems, such as pipes, ducts, and boilers, where the mechanical systems are to remain.

CERAMIC TILE FINISHER

The grouting, cleaning, and polishing of all classes of tile, whether for interior or exterior purposes, all burned, glazed or unglazed products; all composition materials, granite tiles, warning detectable tiles, cement tiles, epoxy composite materials, pavers, glass, mosaics, fiberglass, and all substitute materials, for tile made in tile-like units; all mixtures in tile like form of cement, metals, and other materials that are for and intended for use as a finished floor surface, stair treads, promenade roofs, walks, walls, ceilings, swimming pools, and all other places where tile is to form a finished interior or exterior. The mixing of all setting mortars including but not limited to thin-set mortars, epoxies, wall mud, and any other

sand and cement mixtures or adhesives when used in the preparation, installation, repair, or maintenance of tile and/or similar materials. The handling and unloading of all sand, cement, lime, tile, fixtures, equipment, adhesives, or any other materials to be used in the preparation, installation, repair, or maintenance of tile and/or similar materials. Ceramic Tile Finishers shall fill all joints and voids regardless of method on all tile work, particularly and especially after installation of said tile work. Application of any and all protective coverings to all types of tile installations including, but not be limited to, all soap compounds, paper products, tapes, and all polyethylene coverings, plywood, masonite, cardboard, and any new type of products that may be used to protect tile installations, Blastrac equipment, and all floor scarifying equipment used in preparing floors to receive tile. The clean up and removal of all waste and materials. All demolition of existing tile floors and walls to be re-tiled.

Grundy County Prevailing Wage for 2019

COMMUNICATIONS TECHNICIAN

Installation, operation, inspection, maintenance, repair and service of radio, television, recording, voice, sound and vision production and reproduction, telephone and telephone interconnect, facsimile, equipment and appliances used for domestic, commercial, educational and entertainment purposes, pulling of wire through conduit but not the installation of conduit.

MARBLE FINISHER

Loading and unloading trucks, distribution of all materials (all stone, sand, etc.), stocking of floors with material, performing all rigging for heavy work, the handling of all material that may be needed for the installation of such materials, building of scaffolding, polishing if needed, patching, waxing of material if damaged, pointing up, caulking, grouting and cleaning of marble, holding water on diamond or Carborundum blade or saw for setters cutting, use of tub saw or any other saw needed for preparation of material, drilling of holes for wires that anchor material set by setters, mixing up of molding plaster for installation of material, mixing up thin set for the installation of material, mixing up of sand to cement for the installation of material and such other work as may be required in helping a Marble Setter in the handling of all material in the erection

or installation of interior marble, slate, travertine, art marble, serpentine, alberene stone, blue stone, granite and other stones (meaning as to stone any foreign or domestic materials as are specified and used in building interiors and exteriors and customarily known as stone in the trade), carrara, sanionyx, vitrolite and similar opaque glass and the laying of all marble tile, terrazzo tile, slate tile and precast tile, steps, risers treads, base, or any other materials that may be used as substitutes for any of the aforementioned materials and which are used on interior and exterior which are installed in a similar manner.

MATERIAL TESTER I: Hand coring and drilling for testing of materials; field inspection of uncured concrete and asphalt.

MATERIAL TESTER II: Field inspection of welds, structural steel, fireproofing, masonry, soil, facade, reinforcing steel, formwork, cured concrete, and concrete and asphalt batch plants; adjusting proportions of bituminous mixtures.

OPERATING ENGINEER - BUILDING

Class 1. Asphalt Plant; Asphalt Spreader; Autograde; Backhoes with Caisson Attachment; Batch Plant; Benoto (requires Two Engineers); Boiler and Throttle Valve; Caisson Rigs; Central Redi-Mix Plant; Combination Back Hoe Front End-loader Machine; Compressor and Throttle Valve; Concrete Breaker (Truck Mounted); Concrete Conveyor; Concrete Conveyor (Truck Mounted); Concrete Paver Over 27E cu. ft; Concrete Paver

27E cu. ft. and Under: Concrete Placer; Concrete Placing Boom; Concrete Pump (Truck Mounted); Concrete Tower; Cranes, All; Cranes, Hammerhead; Cranes, (GCI and similar Type); Creter Crane; Spider Crane; Crusher, Stone, etc.; Derricks, All; Derricks, Traveling; Formless Curb and Gutter Machine; Grader, Elevating; Grouting Machines; Heavy Duty Self-Propelled Transporter or Prime Mover; Highlift Shovels or Front Endloader 2-1/4 yd. and over; Hoists, Elevators, outside type rack and pinion and similar machines; Hoists, One, Two and Three Drum; Hoists, Two Tugger One Floor; Hydraulic Backhoes; Hydraulic Boom Trucks; Hydro Vac (and similar equipment); Locomotives, All; Motor Patrol; Lubrication Technician; Manipulators; Pile Drivers and Skid Rig; Post Hole Digger; Pre-

Grundy County Prevailing Wage for 2019

Stress Machine; Pump Cretes Dual Ram; Pump Cretes: Squeeze Cretes-Screw Type Pumps; Gypsum Bulker and Pump; Raised and Blind Hole Drill; Roto Mill Grinder; Scoops - Tractor Drawn; Slip-Form Paver; Straddle Buggies; Operation of Tie Back Machine; Tournapull; Tractor with Boom and Side Boom; Trenching Machines.

Class 2. Boilers; Broom, All Power Propelled; Bulldozers; Concrete Mixer (Two Bag and Over); Conveyor, Portable; Forklift Trucks; Highlift Shovels or Front Endloaders under 2-1/4 yd.; Hoists, Automatic; Hoists, Inside Elevators; Hoists, Sewer Dragging Machine; Hoists, Tugger Single Drum; Laser Screed; Rock Drill (Self-Propelled); Rock Drill (Truck Mounted); Rollers, All; Steam Generators; Tractors, All; Tractor Drawn Vibratory Roller; Winch Trucks with "A" Frame.

Class 3. Air Compressor; Combination Small Equipment Operator; Generators; Heaters, Mechanical; Hoists, Inside Elevators (remodeling or renovation work); Hydraulic Power Units (Pile Driving, Extracting, and Drilling); Pumps, over 3" (1 to 3 not to exceed a total of 300 ft.); Low Boys; Pumps, Well Points; Welding Machines (2 through 5); Winches, 4 Small Electric Drill Winches.

Class 4. Bobcats and/or other

Skid Steer Loaders; Oilers; and

Brick Forklift. Class 5. Assistant

Craft Foreman.

Class 6. Gradall.

Class 7. Mechanics; Welders.

OPERATING ENGINEERS - HIGHWAY CONSTRUCTION

Class 1. Asphalt Plant; Asphalt Heater and Planer Combination; Asphalt Heater Scarfire; Asphalt Spreader; Autograder/GOMACO or other similar type machines: ABG Paver; Backhoes with Caisson Attachment; Ballast Regulator; Belt Loader; Caisson Rigs; Car Dumper; Central Redi-Mix Plant; Combination Backhoe Front Endloader Machine, (1 cu. yd. Backhoe Bucket or over or with attachments); Concrete Breaker (Truck Mounted); Concrete Conveyor; Concrete Paver over 27E cu. ft.; Concrete Placer; Concrete Tube Float; Cranes, all attachments; Cranes, Tower Cranes of all types: Creter Crane: Spider Crane; Crusher, Stone, etc.; Derricks, All; Derrick Boats; Derricks, Traveling; Dredges; Elevators, Outside type Rack & Pinion and Similar Machines; Formless Curb and Gutter Machine; Grader, Elevating; Grader, Motor Grader, Motor Patrol, Auto Patrol, Form Grader, Pull Grader, Subgrader; Guard Rail Post Driver Truck Mounted; Hoists, One, Two and Three Drum; Heavy Duty Self-Propelled Transporter or Prime Mover; Hydraulic Backhoes; Backhoes with shear attachments up to 40' of boom reach; Lubrication Technician; Manipulators; Mucking Machine; Pile Drivers and Skid Rig; Pre-Stress Machine; Pump Cretes Dual Ram; Rock Drill - Crawler or Skid Rig; Rock Drill - Truck Mounted; Rock/Track Tamper; Roto Mill Grinder; Slip-Form Paver; Snow Melters; Soil Test Drill Rig (Truck Mounted); Straddle Buggies; Hydraulic Telescoping Form (Tunnel); Operation of Tieback Machine; Tractor Drawn Belt Loader; Tractor Drawn Belt Loader (with attached pusher - two engineers); Tractor with Boom; Tractaire with Attachments; Traffic Barrier Transfer Machine; Trenching; Truck Mounted Concrete Pump with Boom; Raised or Blind Hole Drills (Tunnel Shaft);

Grundy County Prevailing Wage for 2019

Underground Boring and/or Mining Machines 5 ft. in diameter and over tunnel, etc; Underground Boring and/or Mining Machines under 5 ft. in diameter; Wheel Excavator; Widener (APSCO).

Class 2. Batch Plant; Bituminous Mixer; Boiler and Throttle Valve; Bulldozers; Car Loader Trailing Conveyors; Combination Backhoe Front Endloader Machine (Less than 1 cu. yd. Backhoe Bucket or over or with attachments); Compressor and Throttle Valve; Compressor, Common Receiver (3); Concrete Breaker or Hydro Hammer; Concrete Grinding Machine; Concrete Mixer or Paver 7S Series to and including 27 cu. ft.; Concrete Spreader; Concrete Curing Machine, Burlap Machine, Belting Machine and Sealing Machine; Concrete Wheel Saw; Conveyor Muck Cars (Haglund or Similar Type); Drills, All; Finishing Machine - Concrete; Highlift Shovels or Front Endloader; Hoist - Sewer Dragging Machine; Hydraulic Boom Trucks (All Attachments); Hydro-Blaster; Hydro Excavating (excluding hose work); Laser Screed; All Locomotives, Dinky; Off-Road Hauling Units (including articulating) Non Self-Loading Ejection Dump; Pump Cretes: Squeeze Cretes - Screw Type Pumps, Gypsum Bulker and Pump; Roller, Asphalt; Rotary Snow Plows; Rototiller, Seaman, etc., self-propelled; Self-Propelled Compactor; Spreader - Chip - Stone, etc.; Scraper - Single/Twin Engine/Push and Pull; Scraper - Prime Mover in Tandem (Regardless of Size); Tractors pulling attachments, Sheeps Foot, Disc, Compactor, etc.; Tug Boats.

Class 3. Boilers; Brooms, All Power Propelled; Cement Supply Tender; Compressor, Common Receiver (2); Concrete Mixer (Two Bag and Over); Conveyor, Portable; Farm-Type Tractors Used for Mowing, Seeding, etc.; Forklift Trucks; Grouting Machine; Hoists, Automatic; Hoists, All Elevators; Hoists, Tugger Single Drum; Jeep Diggers; Low Boys; Pipe Jacking Machines; Post-Hole Digger; Power Saw, Concrete Power Driven; Pug Mills; Rollers, other than Asphalt; Seed and Straw Blower; Steam Generators; Stump Machine; Winch Trucks with "A" Frame; Work Boats; Tamper-Form-Motor Driven.

Class 4. Air Compressor; Combination - Small Equipment Operator; Directional Boring Machine; Generators; Heaters, Mechanical; Hydraulic Power Unit (Pile Driving, Extracting, or Drilling); Light Plants, All (1 through 5); Pumps, over 3" (1 to 3 not to exceed a total of 300 ft.); Pumps, Well Points; Vacuum Trucks (excluding hose work); Welding Machines (2 through 5); Winches, 4 Small Electric Drill Winches.

Class 5. SkidSteer Loader (all); Brick Forklifts; Oilers.

Class 6. Field Mechanics and Field Welders

Class 7. Dowell Machine with Air

Compressor; Gradall and machines of

like nature. OPERATING ENGINEERS -

FLOATING

Diver. Diver Wet Tender, Diver Tender, ROV Pilot, ROV Tender

TRUCK DRIVER - BUILDING, HEAVY AND HIGHWAY CONSTRUCTION Class 1. Two or three Axle Trucks. A-frame Truck when used for transportation purposes; Air Compressors and Welding Machines, including those pulled by cars, pick-up trucks and tractors; Ambulances; Batch Gate Lockers; Batch Hopperman; Car and Truck Washers; Carry-alls; Fork Lifts and Hoisters; Helpers; Mechanics Helpers and Greasers; Oil Distributors 2-man operation; Pavement Breakers; Pole Trailer, up to 40 feet; Power

Grundy County Prevailing Wage for 2019

Mower Tractors; Self-propelled Chip Spreader; Skipman; Slurry Trucks, 2-man operation; Slurry Truck Conveyor Operation, 2 or 3 man; Teamsters Unskilled dumpman; and Truck Drivers hauling warning lights, barricades, and portable toilets on the job site.

Class 2. Four axle trucks; Dump Crets and Adgetors under 7 yards; Dumpsters, Track Trucks, Euclids, Hug Bottom Dump Turnapulls or Turnatrailers when pulling other than self-loading equipment or similar equipment under 16 cubic yards; Mixer Trucks under 7 yards; Ready-mix Plant Hopper Operator, and Winch Trucks, 2 Axles.

Class 3. Five axle trucks; Dump Crets and Adgetors 7 yards and over; Dumpsters, Track Trucks, Euclids, Hug Bottom Dump Turnatrailers or turnapulls when pulling other than self-loading equipment or similar equipment over 16 cubic yards; Explosives and/or Fission Material Trucks; Mixer Trucks 7 yards or over; Mobile Cranes while in transit; Oil Distributors, 1-man operation; Pole Trailer, over 40 feet; Pole and Expandable Trailers hauling material over 50 feet long; Slurry trucks, 1-man operation; Winch trucks, 3 axles or more; Mechanic--Truck Welder and Truck Painter.

Class 4. Six axle trucks; Dual-purpose vehicles, such as mounted crane trucks with hoist and accessories; Foreman; Master Mechanic; Self-loading equipment like P.B. and trucks with scoops on the front.

TERRAZZO FINISHER

The handling of sand, cement, marble chips, and all other materials that may be used by the Mosaic Terrazzo Mechanic, and the mixing, grinding, grouting, cleaning and sealing of all Marble, Mosaic, and Terrazzo work, floors, base, stairs, and wainscoting by hand or machine, and in addition, assisting and aiding Marble, Masonic, and Terrazzo Mechanics.

Other Classifications of Work:

For definitions of classifications not otherwise set out, the Department generally has on file such definitions which are available. If a task to be performed is not subject to one of the classifications of pay set out, the Department will upon being contacted state which neighboring county has such a classification and provide such rate, such rate being deemed to exist by reference in this document. If no neighboring county rate applies to the task, the Department shall undertake a special determination, such special determination being then deemed to have existed under this determination. If a project requires these, or any classification not listed, please contact IDOL at 217-782-1710 for wage rates or clarifications.

LANDSCAPING

Landscaping work falls under the existing classifications for laborer, operating engineer and truck driver. The work performed by landscape plantsman and landscape laborer is covered by the existing classification of laborer. The work performed by landscape operators (regardless of equipment used or its size) is covered by the classifications of operating engineer. The work performed by landscape truck drivers (regardless of size of truck driven) is covered by the classifications of truck driver.

MATERIAL TESTER & MATERIAL TESTER/INSPECTOR I AND II

Grundy County Prevailing Wage for 2019

Notwithstanding the difference in the classification title, the classification entitled "Material Tester I" involves the same job duties as the classification entitled "Material Tester/Inspector I". Likewise, the classification entitled "Material Tester II" involves the same job duties as the classification entitled "Material Tester/Inspector II".

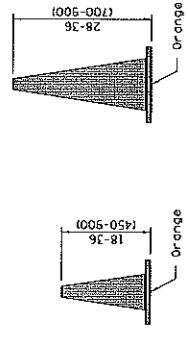
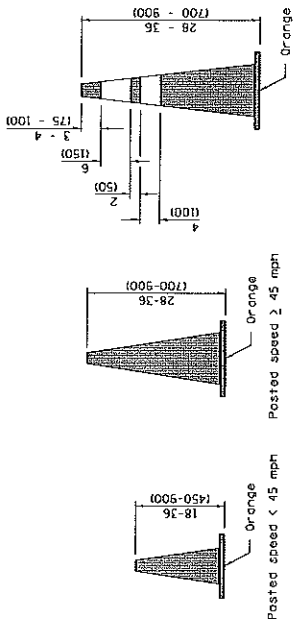

Posted speed < 45 mph

Posted speed ≥ 45 mph

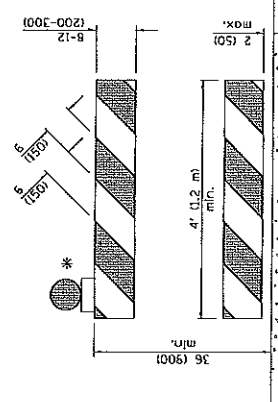
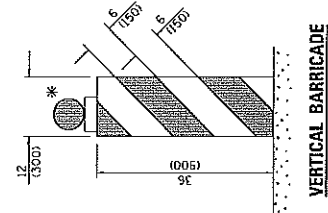
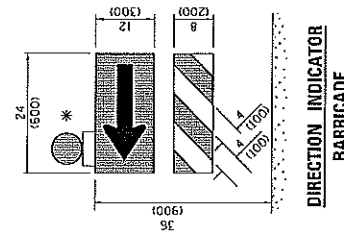
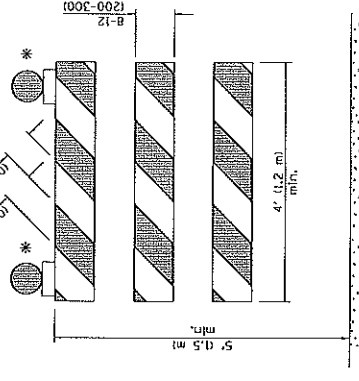
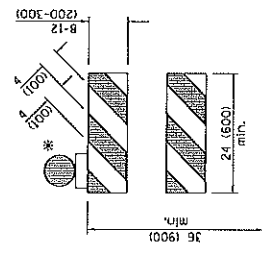
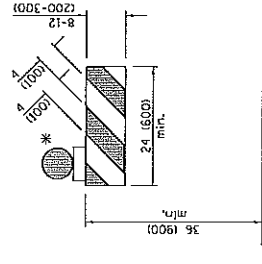
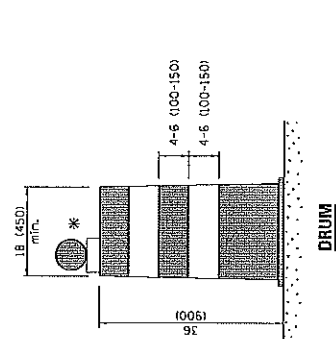
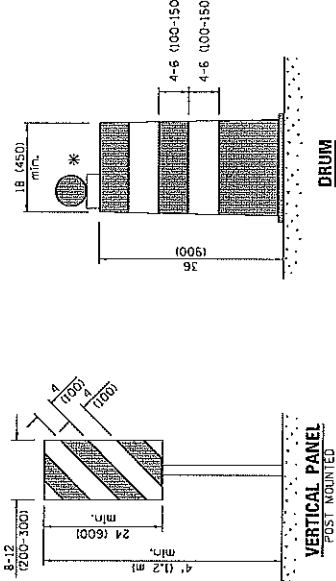
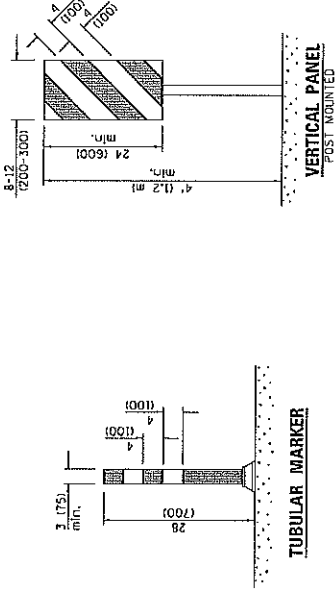

* Warning lights (if required)

GENERAL NOTES

All heights shown shall be measured above the pavement surface.

All dimensions are in inches (millimeters) unless otherwise shown.

DATE	REVISIONS
1-1-17	Changed FLEXIBLE DELINEATOR to TUBULAR MARKER.
4-1-16	Add dims. to barricades. Rev. notes for post mt. signs.
	Rev. cone dims. Add W12-1103.

APPROVED	DESIGNED	1-1-17
ENGINEER OF OPERATIONS	ENGINEER	2017
APPROVED	DESIGNED	2017
ENGINEER OF DESIGN AND ENVIRONMENT	ENGINEER	2017

**TRAFFIC CONTROL
DEVICES**

STANDARD 701901-06

(Sheet 1 of 3)

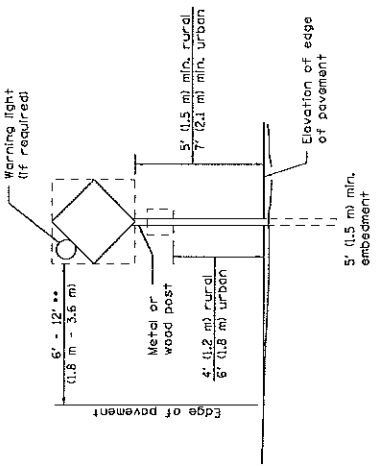

POST MOUNTED SIGNS

.. When curb or paved shoulder are present this dimension shall be 24 (600) to the face of curb or 6' (1.8 m) to the outside edge of the paved shoulder.

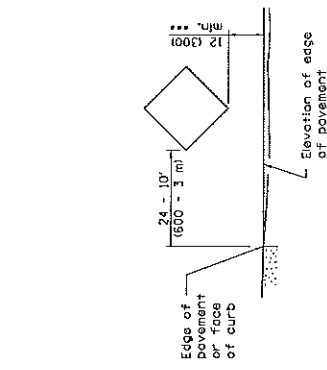

SIGNS ON TEMPORARY SUPPORTS

... When work operations exceed four days, this dimension shall be 5' (1.5 m) min. If located behind other devices, the height shall be sufficient to be seen completely above the devices.

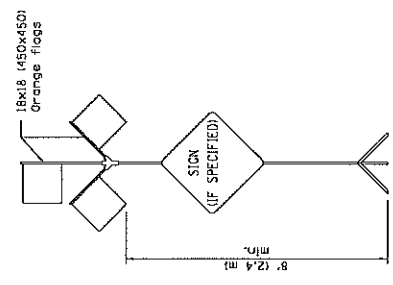

HIGH LEVEL WARNING DEVICE

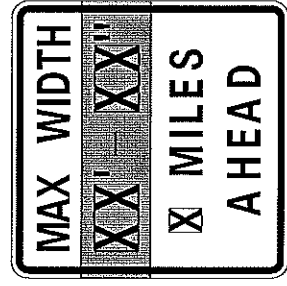

W12-1103-4846

WIDTH RESTRICTION SIGN

XX'-XX" width and X miles are variable.

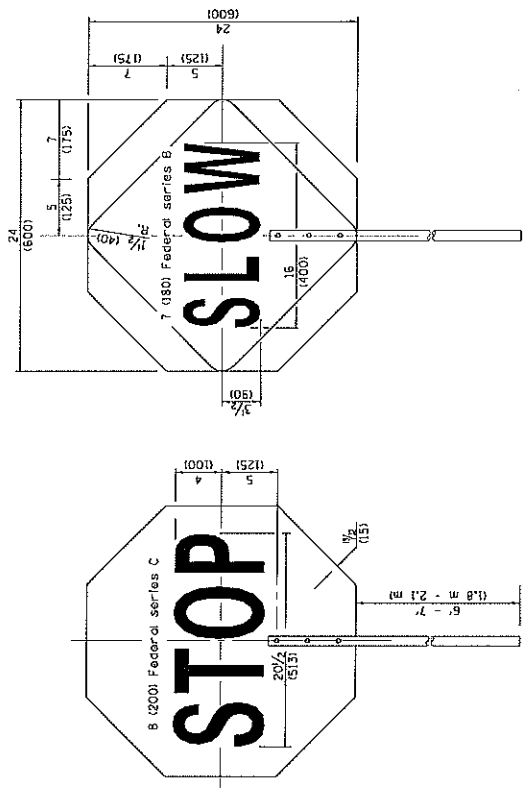

FRONT SIDE

REVERSE SIDE

FLAGGER TRAFFIC CONTROL SIGN

Illinois Department of Transportation

APPROVED: *[Signature]* January 1, 2017

ENGINEER OF OPERATIONS

APPROVED: *[Signature]* January 1, 2017

ENGINEER OF DESIGN AND ENVIRONMENT

ISSUED 1-1-97

ROAD CONSTRUCTION NEXT X MILES

END CONSTRUCTION

620-110401-6036

620-110501-6024

This signing is required for all projects 2 miles (3200 m) or more in length.

ROAD CONSTRUCTION NEXT X MILES sign shall be placed 500' (150 m) in advance of project limits.

END CONSTRUCTION sign shall be erected at the end of the job unless another job is within 2 miles (3200 m).

Dual sign displays shall be utilized on multi-lane highways.

WORK LIMIT SIGNING

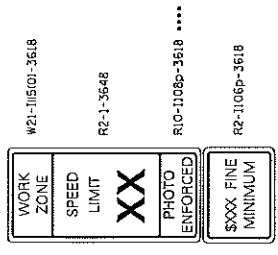

Sign assembly as shown on Standards or as allowed by District Operations.

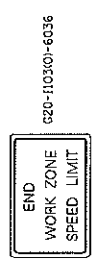

This sign shall be used when the above sign assembly is used.

HIGHWAY CONSTRUCTION SPEED ZONE SIGNS

.... R10-108p shall only be used along roadways under the jurisdiction of the State.

TRAFFIC CONTROL DEVICES

(Sheet 2 of 3)

STANDARD 701901-06

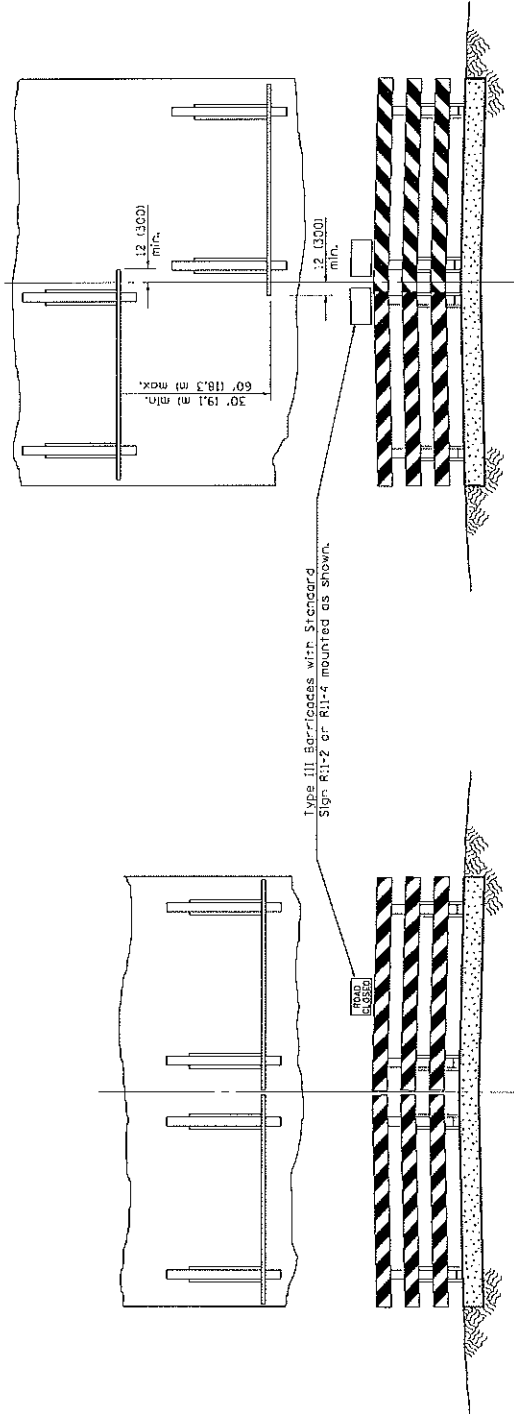

Resident traffic and day labor force's equipment to use road shoulder for passing barricade.

Use when shoulders are too narrow for passage of traffic.

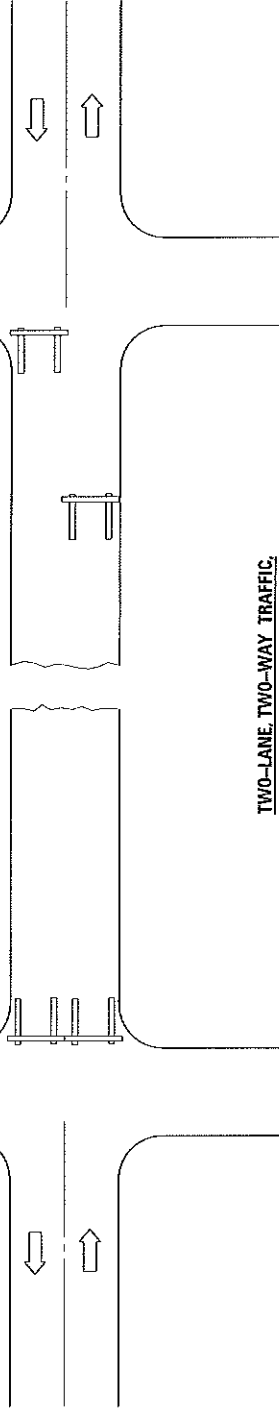

**TWO-LANE, TWO-WAY TRAFFIC,
RURAL OPERATIONS EXCEEDING
ONE DAYLIGHT PERIOD**

GENERAL NOTES
Type III barricades to be width of pavement only.
ReflectORIZED striping shall appear on both sides of barricades. Barricades shall be positioned so that the side of the road is toward the side on which traffic is to pass.

Although not shown, advance warning signs with minimum dimensions of 36x36 (900x900) and black legends on orange reflectORIZED backgrounds shall be utilized where needed.

This case is for use on rural local roads where the local authority considers this protection to be appropriate for the specific job conditions.

All dimensions are in inches (millimeters) unless otherwise shown.

Illinois Department of Transportation
APPROVED: 2009
ENGINEER: *John J. [Signature]*
APPROVED: 2009
ENGINEER: *John J. [Signature]*
ISSUED: 1-1-97
ENGINEER OF DESIGN AND CONSTRUCTION

DATE	REVISIONS
1-1-09	Switched units to English (imperial).
1-1-98	Rev. "R11-1" to "R11-4".
	Rev. 4th General Note.

**TRAFFIC CONTROL DEVICES -
DAY LABOR CONSTRUCTION**

STANDARD B.L.R. 17-4

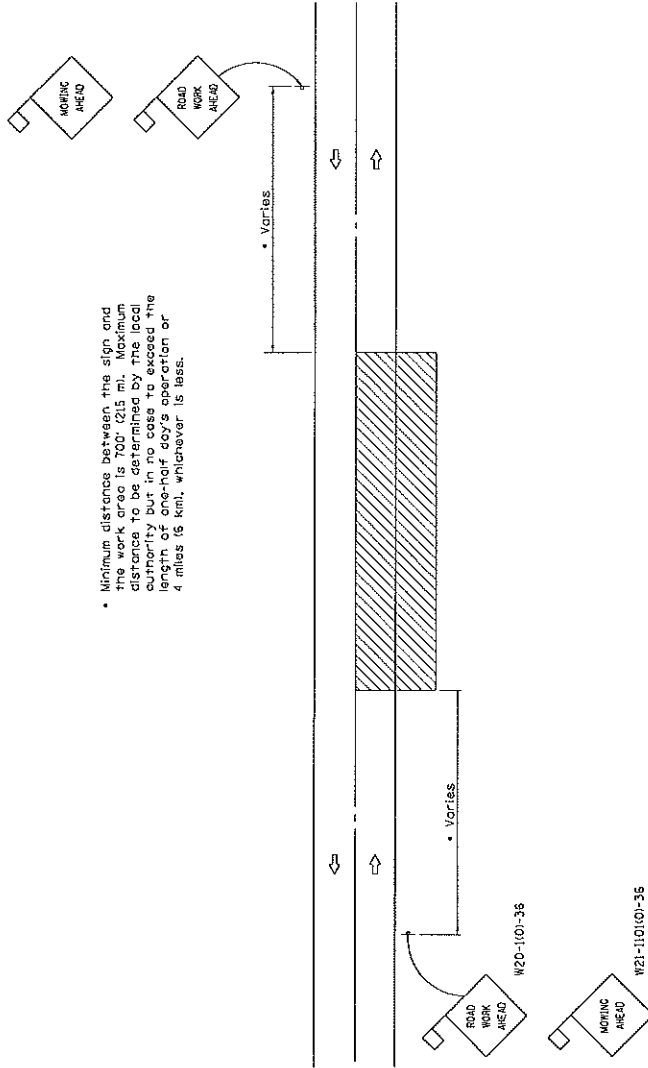

TWO-LANE TWO-WAY TRAFFIC RURAL OPERATIONS ONLY DAY OPERATIONS ONLY

SYMBOLS



Work area



Sign with 18x48 (450x450) min. orange flag attached.

TYPICAL APPLICATIONS

MOVING
SPREADING AGGREGATE
SPREADING ASPHALT
BITUMINOUS RESURFACING
CRACK POURING
SHOULDER REPAIR
CLEANING DITCHES

GENERAL NOTES

Maintenance operations shall be confined to one traffic lane, leaving the opposite lane open to traffic. At least 300' (120 m) of both traffic lanes shall be kept clear of equipment and materials between work areas at intervals not greater than 1000' (300 m).

When operations are on the pavement and stationary or moving at a speed less than 4 mph (6 km/h), a ONE LANE AHEAD, or other appropriate sign, shall be installed in each direction between the ROAD WORK AHEAD sign and the work area. The distance between this sign and the work area shall be a minimum of 400' (120 m) but in no case to exceed the length of one-half day's operation or 4 miles (6 km), whichever is less. The distance between the two signs shall be approximately 400' (120 m).

All signs are to be removed at completion of the day's operation.

Any unattended obstacle, excavation, or pavement drop off greater than 3' (75) in the work area shall be protected by Type I or Type II barricades with flashing lights.

Longitudinal dimensions may be adjusted slightly to fit field conditions.

All vehicles, equipment, men, and their activities are restricted at all times to one side of the pavement.

Flashing lights or rotating beacons are required for all maintenance vehicles while in operation.

Applicable operations illustrated in Standard 701301 may be used when operations do not exceed 15 minutes on the pavement or 60 minutes on the shoulder respectively.

All warning signs shall have minimum dimensions of 36x48 (900x500) and have black legend on an orange reflectorized background.

When fluorescent signs are used, orange flags are not required.

This case is for use on rural local roads where the local authority considers this protection to be appropriate for the specific job conditions.

All dimensions are in inches (millimeters) unless otherwise shown.

TRAFFIC CONTROL DEVICES— DAY LABOR MAINTENANCE	
DATE	REVISIONS
1-1-15	Corrected RNA sign number.
1-1-09	Switched units to English (metric). Moved One General Note.

Illinois Department of Transportation	
APPROVED	ISSUED 1-1-97
DESIGNED BY	2019
ENGINEER	LOCAL ROADS AND STREETS
APPROVED	2015
ENGINEER OF DESIGN AND ENVIRONMENT	

STANDARD B.L.R. 18-6



County: Grundy
Township: Erienna
Section: 19-03000-00-GM

**Material Proposal
Schedule of Quantities**

<u>Location: County Line Rd</u>		<u>Pay Item</u>	<u>Foot</u>	<u>Gallons</u>	<u>Tons</u>
From:	To:				
Morris Blacktop	Long Point Rd	Bituminous Matl. Prime		4116	
		Seal Coat Aggregate			13.54
		Fog Seal (SQ Yds)	10,289		
<u>Location: Nettle Creek Rd</u>					
Morris Blacktop	Long Point Rd	Bituminous Matl. Prime		4295	
		Seal Coat Aggregate			118.5
		Fog Seal	10,737		
Totals			21026	8411	132.04

Erienna Township Grundy County, Illinois

