

This packet is not for
bid and is to be only
used as a reference.

Please request a
formal bid packet by
emailing Cody Doran

@

cdoran@grundycountyil.gov



COVER SHEET

Proposal Submitted By:

Contractor's Name

Contractor's Address

City

State

Zip Code

STATE OF ILLINOIS

Local Public Agency

County

Section Number

Grundy Co. & Various Townships

Grundy

24-XX000-00-GM

Route(s) (Street/Road Name)

Type of Funds

Various

MFT and Local

☐ Proposal Only ☒ Proposal and Plans ☐ Proposal only, plans are separate

Submitted/Approved

For Local Public Agency:

For a County and Road District Project

Submitted/Approved

Highway Commissioner Signature & Date

Submitted/Approved

County Engineer/Superintendent of Highways Signature & Date

[Signature] 01/26/2024

For a Municipal Project

Submitted/Approved/Passed

Signature & Date

Official Title

Department of Transportation

Released for bid based on limited review

Regional Engineer Signature & Date

Note: All proposal documents, including Proposal Guaranty Checks or Proposal Bid Bonds, should be stapled together to prevent loss when bids are processed.

Local Public Agency	County	Section Number	Route(s) (Street/Road Name)
Grundy Co. & Various Townships	Grundy	24-XX000-00-GM	Various

NOTICE TO BIDDERS

Sealed proposals for the project described below will be received at the office of Grundy County Highway Department

245 N. IL. Rt. 47 Morris, IL. 60450 Name of Office
until 11:40 AM on 02/22/24
Address Time Date

Sealed proposals will be opened and read publicly at the office of Grundy County Highway Department

245 N. IL. Rt. 47 Morris, IL. 60450 Name of Office
at 11:40 AM on 02/22/24
Address Time Date

DESCRIPTION OF WORK

Location	Project Length
Various HMA Resurfacing Operations	6 miles

Proposed Improvement

HMA Paving and Pavement Removal: See schedule of quantities and description of work special provisions.

1. Plans and proposal forms will be available in the office of

Grundy County Highway Department
245 N. IL. Rt. 47 Morris, IL. 60450
24-XX000-00-GM HMA Contract

2. ☒ Prequalification

If checked, the 2 apparent as read low bidders must file within 24 hours after the letting an "Affidavit of Availability" (Form BC 57) in triplicate, showing all uncompleted contracts awarded to them and all low bids pending award for Federal, State, County, Municipal and private work. One original shall be filed with the Awarding Authority and two originals with the IDOT District Office.

3. The Awarding Authority reserves the right to waive technicalities and to reject any or all proposals as provided in BLRS Special Provision for Bidding Requirements and Conditions for Contract Proposals.

4. The following BLR Forms shall be returned by the bidder to the Awarding Authority:

- Local Public Agency Formal Contract Proposal (BLR 12200)
- Schedule of Prices (BLR 12201)
- Proposal Bid Bond (BLR 12230) (if applicable)
- Apprenticeship or Training Program Certification (BLR 12325) (do not use for project with Federal funds.)
- Affidavit of Illinois Business Office (BLR 12326) (do not use for project with Federal funds)

5. The quantities appearing in the bid schedule are approximate and are prepared for the comparison of bids. Payment to the Contractor will be made only for the actual quantities of work performed and accepted or materials furnished according to the contract. The scheduled quantities of work to be done and materials to be furnished may be increased, decreased or omitted as hereinafter provided.

6. Submission of a bid shall be conclusive assurance and warranty the bidder has examined the plans and understands all requirements for the performance of work. The bidder will be responsible for all errors in the proposal resulting from failure or neglect to conduct an in depth examination. The Awarding Authority will, in no case, be responsible for any costs, expenses, losses or changes in anticipated profits resulting from such failure or neglect of the bidder.

7. The bidder shall take no advantage of any error or omission in the proposal and advertised contract.

8. If a special envelope is supplied by the Awarding Authority, each proposal should be submitted in that envelope furnished by the Awarding Agency and the blank spaces on the envelope shall be filled in correctly to clearly indicate its contents. When an envelope other than the special one furnished by the Awarding Authority is used, it shall be marked to clearly indicate its contents. When sent by mail, the sealed proposal shall be addressed to the Awarding Authority at the address and in care of the official in whose office the bids are to be received. All proposals shall be filed prior to the time and at the place specified in the Notice to Bidders. Proposals received after the time specified will be returned to the bidder unopened.

9. Permission will be given to a bidder to withdraw a proposal if the bidder makes the request in writing or in person before the time for opening proposals.

Local Public Agency	County	Section Number	Route(s) (Street/Road Name)
Grundy Co. & Various Townships	Grundy	24-XX000-00-GM	Various

PROPOSAL

- Proposal of _____ Contractor's Name _____
Contractor's Address _____
- The plans for the proposed work are those prepared by Eric Gibson
and approved by the Department of Transportation on _____.
- The specifications referred to herein are those prepared by the Department of Transportation and designated as "Standard Specifications for Road and Bridge Construction" and the "Supplemental Specifications and Recurring Special Provisions" thereto, adopted and in effect on the date of invitation for bids.
- The undersigned agrees to accept, as part of the contract, the applicable Special Provisions indicated on the "Check Sheet for Recurring Special Provisions" contained in this proposal.
- The undersigned agrees to complete the work within _____ working days or by 10/01/24 unless additional time is granted in accordance with the specifications.
- The successful bidder at the time of execution of the contract will _____ be required to deposit a contract bond for the full amount of the award. When a contract bond is not required, the proposal guaranty check will be held in lieu thereof. If this proposal is accepted and the undersigned fails to execute a contract and contract bond as required, it is hereby agreed that the Bid Bond of check shall be forfeited to the Awarding Authority.
- Each pay item should have a unit price and a total price. If no total price is shown or if there is a discrepancy between the products of the unit price multiplied by the quantity, the unit price shall govern. If a unit price is omitted, the total price will be divided by the quantity in order to establish a unit price. A bid may be declared unacceptable if neither a unit price nor a total price is shown.
- The undersigned submits herewith the schedule of prices on BLR 12201 covering the work to be performed under this contract.
- The undersigned further agrees that if awarded the contract for the sections contained in the combinations on BLR 12201, the work shall be in accordance with the requirements of each individual proposal for the multiple bid specified in the Schedule for Multiple Bids below.
- A proposal guaranty in the proper amount, as specified in BLRS Special Provision for Bidding Requirements and Conditions for Contract Proposals, will be required. Bid Bonds will _____ be allowed as a proposal guaranty. Accompanying this proposal is either a bid bond, if allowed, on Department form BLR 12230 or a proposal guaranty check, complying with the specifications, made payable to: Grundy County Treasurer of Grundy County .
The amount of the check is _____ (_____).

Attach Cashier's Check or Certified Check Here

In the event that one proposal guaranty check is intended to cover two or more bid proposals, the amount must be equal to the sum of the proposal guaranties which would be required for each individual bid proposal. If the proposal guaranty check is placed in another bid proposal, state below where it may be found.

The proposal guaranty check will be found in the bid proposal for: Section Number _____ .

Local Public Agency	County	Section Number	Route(s) (Street/Road Name)
Grundy Co. & Various Townships	Grundy	24-XX000-00-GM	Various

CONTRACTOR CERTIFICATIONS

The certifications hereinafter made by the bidder are each a material representation of fact upon which reliance is placed should the Department enter into the contract with the bidder.

1. **Debt Delinquency.** The bidder or contractor or subcontractor, respectively, certifies that it is not delinquent in the payment of any tax administered by the Department of Revenue unless the individual or other entity is contesting, in accordance with the procedure established by the appropriate Revenue Act, its liability for the tax or the amount of the tax. Making a false statement voids the contract and allows the Department to recover all amounts paid to the individual or entity under the contract in a civil action.
2. **Bid-Rigging or Bid Rotating.** The bidder or contractor or subcontractor, respectively, certifies that it is not barred from contracting with the Department by reason of a violation of either 720 ILCS 5/33E-3 or 720 ILCS 5/33E-4.

A violation of section 33E-3 would be represented by a conviction of the crime of bid-rigging which, in addition to Class 3 felony sentencing, provides that any person convicted of this offense, or any similar offense of any state or the United States which contains the same elements as this offense shall be barred for 5 years from the date of conviction from contracting with any unit of State or local government. No corporation shall be barred from contracting with any unit of State or local government as a result of a conviction under this Section of any employee or agent of such corporation if the employee so convicted is no longer employed by the corporation: (1) it has been finally adjudicated not guilty or (2) if it demonstrates to the governmental entity with which it seeks to contract that entity finds that the commission of the offense was neither authorized, requested, commanded, nor performed by a director, officer or a high managerial agent on behalf of the corporation.

A violation of Section 33E-4 would be represented by a conviction of the crime of bid-rotating which, in addition to Class 2 felony sentencing, provides that any person convicted of this offense or any similar offense of any state or the United States which contains the same elements as this offense shall be permanently barred from contracting with any unit of State or Local government. No corporation shall be barred from contracting with any unit of State or Local government as a result of a conviction under this Section of any employee or agent of such corporation if the employee so convicted is no longer employed by the corporation and: (1) it has been finally adjudicated not guilty or (2) if it demonstrates to the governmental entity with which it seeks to contract and that entity finds that the commission of the offense was neither authorized, requested, commanded, nor performed by a director, officer or a high managerial agent on behalf of the corporation.

3. **Bribery.** The bidder or contractor or subcontractor, respectively, certifies that, it has not been convicted of bribery or attempting to bribe an officer or employee of the State of Illinois or any unit of local government, nor has the firm made an admission of guilt of such conduct which is a matter of record, nor has an official, agent, or employee of the firm committed bribery or attempted bribery on behalf of the firm and pursuant to the direction or authorization of a responsible official of the firm.
4. **Interim Suspension or Suspension.** The bidder or contractor or subcontractor, respectively, certifies that it is not currently under a suspension as defined in Subpart I of Title 44 Subtitle A Chapter III Part 6 of the Illinois Administrative code. Furthermore, if suspended prior to completion of this work, the contract or contracts executed for the completion of this work may be canceled.

Local Public Agency	County	Section Number	Route(s) (Street/Road Name)
Grundy Co. & Various Townships	Grundy	24-XX000-00-GM	Various

SIGNATURES

(If an individual)

Bidder Signature & Date

Business Address

City

State

Zip Code

(If a partnership)

Firm Name

Signature & Date

Title

Business Address

City

State

Zip Code

Insert the Names and Addresses of all Partners

(If a corporation)

Corporate Name

Signature & Date

Title

Business Address

City

State

Zip Code

Insert Names of Officers

President

Attest:

Secretary

Secretary

Treasurer

Not
For
Bid



Local Public Agency

County

Section Number

Grundy County & Various Townships

Grundy

24-XX000-00-GM

WE, _____ as PRINCIPAL, and
_____ as SURETY, are held jointly,

severally and firmly bound unto the above Local Public Agency (hereafter referred to as "LPA") in the penal sum of 5% of the total bid price, or for the amount specified in the proposal documents in effect on the date of invitation for bids, whichever is the lesser sum. We bind ourselves, our heirs, executors, administrators, successors, and assigns, jointly pay to the LPA this sum under the conditions of this instrument.

WHEREAS THE CONDITION OF THE FOREGOING OBLIGATION IS SUCH that, the said PRINCIPAL is submitting a written proposal to the LPA acting through its awarding authority for the construction of the work designated as the above section.

THEREFORE if the proposal is accepted and a contract awarded to the PRINCIPAL by the LPA for the above designated section and the PRINCIPAL shall within fifteen (15) days after award enter into a formal contract, furnish surety guaranteeing the faithful performance of the work, and furnish evidence of the required insurance coverage, all as provided in the "Standard Specifications for Road and Bridge Construction" and applicable Supplemental Specifications, then this obligation shall become void; otherwise it shall remain in full force and effect.

IN THE EVENT the LPA determines the PRINCIPAL has failed to enter into a formal contract in compliance with any requirements set forth in the preceding paragraph, then the LPA acting through its awarding authority shall immediately be entitled to recover the full penal sum set out above, together with all court costs, all attorney fees, and any other expense of recovery.

IN TESTIMONY WHEREOF, the said PRINCIPAL and the said SURETY have caused this instrument to be signed by their respective officers this _____ of _____
Day Month and Year

Principal

Company Name

Signature & Date

By:

Title

Company Name

Signature & Date

By:

Title

(If Principal is a joint venture of two or more contractors, the company names, and authorized signatures of each contractor must be affixed.)

Surety

Name of Surety

Signature of Attorney-in-Fact Signature & Date

By:

STATE OF IL

COUNTY OF

I _____, a Notary Public in and for said county do hereby certify that

(Insert names of individuals signing on behalf of PRINCIPAL & SURETY)

who are each personally known to me to be the same persons whose names are subscribed to the foregoing instrument on behalf of PRINCIPAL and SURETY, appeared before me this day in person and acknowledged respectively, that they signed and delivered said instruments as their free and voluntary act for the uses and purposes therein set forth.

Given under my hand and notarial seal this _____ day of _____
Day Month and Year

(SEAL, if required by the LPA)

Notary Public Signature & Date

Date commission expires _____

Local Public Agency

County

Section Number

Grundy County & Various Townships

Grundy

24-XX000-00-GM

ELECTRONIC BID BOND

☐ **Electronic bid bond is allowed (box must be checked by LPA if electronic bid bond is allowed)**

The Principal may submit an electronic bid bond, in lieu of completing the above section of the Proposal Bid Bond Form. By providing an electronic bid bond ID code and signing below, the Principal is ensuring the identified electronic bid bond has been executed and the Principal and Surety are firmly bound unto the LPA under the conditions of the bid bond as shown above. (If PRINCIPAL is a joint venture of two or more contractors, an electronic bid bond ID code, company/Bidder name title and date must be affixed for each contractor in the venture.)

Electronic Bid Bond ID Code

--	--	--	--	--	--	--	--	--	--	--	--	--

Company/Bidder Name

--

Signature & Date

--

Title

--

Not
For
Bid



Affidavit of Availability

For the Letting of 02/22/24



Bureau of Construction
2300 South Dirksen Parkway/Room 322
Springfield, IL 62764

Instructions: Complete this form by either typing or using black ink. "Authorization to Bid" will not be issued unless both sides of this form are completed in detail. Use additional forms as needed to list all work.

Part I. Work Under Contract

List below all work you have under contract as either a prime contractor or a subcontractor. It is required to include all pending low bids not yet awarded or rejected. In a joint venture, list only that portion of the work which is the responsibility of your company. The uncompleted dollar value is to be based upon the most recent engineer's or owners estimate, and must include work subcontracted to others. If no work is contracted, show NONE.

	1	2	3	4	Awards Pending	Accumulated Totals
Contract Number						
Contract With						
Estimated Completion Date						
Total Contract Price						
Uncompleted Dollar Value if Firm is the Prime Contractor						
Uncompleted Dollar Value if Firm is the Subcontractor						
Total Value of All Work						

Part II. Awards Pending and Uncompleted Work to be done with your own forces.

List below the uncompleted dollar value of work for each contract and awards pending to be completed with your own forces. All work subcontracted to others will be listed on the reverse of this form. In a joint venture, list only that portion of the work to be done by your company. If no work is contracted, show NONE.

Earthwork						
Portland Cement Concrete Paving						
HMA Plant Mix						
HMA Paving						
Clean & Seal Cracks/Joints						
Aggregate Bases, Surfaces						
Highway, R.R., Waterway Struc.						
Drainage						
Electrical						
Cover and Seal Coats						
Concrete Construction						
Landscaping						
Fencing						
Guardrail						
Painting						
Signing						
Cold Milling, Planning, Rotomilling						
Demolition						
Pavement Markings (Paint)						
Other Construction (List)						
Totals						

Disclosure of this information is REQUIRED to accomplish the statutory purpose as outlined in the "Illinois Procurement Code." Failure to comply will result in non-issuance of an "Authorization To Bid." This form has been approved by the State Forms Management Center.

Part III. Work Subcontracted to Others.

For each contract described in Part I, list all the work you have subcontracted to others.

	1	2	3	4	Awards Pending
Subcontractor					
Type of Work					
Subcontract Price					
Amount Uncompleted					
Subcontractor					
Type of Work					
Subcontract Price					
Amount Uncompleted					
Subcontractor					
Type of Work					
Subcontract Price					
Amount Uncompleted					
Subcontractor					
Type of Work					
Subcontract Price					
Amount Uncompleted					
Subcontractor					
Type of Work					
Subcontract Price					
Amount Uncompleted					
Total Uncompleted					

Notary

I, being duly sworn, do hereby declare this affidavit is a true and correct statement relating to ALL uncompleted contracts of the undersigned for Federal, State, County, City and private work, including ALL subcontract work, ALL pending low bids not yet awarded or rejected and ALL estimated completion dates.

Officer or Director

Title

Signature

Date

Company

Address

City

State

Zip Code

Subscribed and sworn to before me

this _____ day of _____, _____

(Signature of Notary Public)

My commission expires _____

(Notary Seal)

☐ Add pages for additional contracts



Material Proposal Schedule of Prices

Local Public Agency

County

Section Number

Grundy County & Various Townships

Grundy

24-XX000-00-GM

Material Proposal Schedule of Prices

Group No.	Item(s)	Delivery	Unit	Quantity	Unit Price	Total
A.	Erienna 24-03000-00-GM	Applied on Road				
	Class D Patch Special 4" Ty4		Sq Yd	515.0		
B.	Goose Lake, 24-07000-00-GM	Applied on Road				
	HMA Prime Coat		Lb	3,865.2		
	HMA Surface Rem. 2"		Sq Yd	8,589.33		
	HMA SC 2" Mix "C" N50		Ton	962.01		
C.	Highland, 24-09000-00-GM	Applied on Road				
	HMA Surf. Removal Special		Sq Yd	4500.0		
D.	Norman, 24-14000-00-GM	Applied on Road				
	Class D Patch Special 4" Ty4		Sq Yd	81.33		
E.	Saratoga, 24-15000-00-GM	Applied on Road				
	HMA Prime Coat		Lb	11,075.0		
	HMA Surf. Rem. 1" Spl.		Sq Yd	24,611.11		
	HMA LVL BC 1"		Ton	1,378.22		
	HMA SC 2" Mix "C" N50		Ton	2,756.44		
	HMA Butt Joints		Sq Yd	633.33		
	Agg. Wedge Shoulder		Ton	700.0		
	Class D Patch SPL 4" Tp4		Sq Yd	444.44		
F.	Wauponsee, 24-17000-00-GM	Applied on Road				
	HMA Prime Coat		Lb	12,405.22		
	HMA Surface Rem. 2"		Sq Yd	27,567.15		
	HMA SC 2" Mix "C" N50		Ton	3,277.51		
G.	Grundy Co. 24-00000-00-GM	Applied on Road				
	Class D Patch SPL 4" Tp4		Sq Yd	2500		

The undersigned firm certifies that it has not been convicted of bribery or attempting to bribe an officer or employee of the State of Illinois, nor has the firm made an admission of guilt of such conduct which is a matter of record, nor has an official, agent, or employee of the firm committed bribery or attempted bribery on behalf of the firm and pursuant to the direction or authorization of a responsible official of the firm. The undersigned firm further certifies that it is not barred from contracting with any unit of State or local government as a result of a violation of State laws prohibiting bid-rigging or bid rotating.

Bidder Signature & Date

Address

City

State

Zip Code

Grundy County
Erienna Township

Contract Proposal Schedule of Quantities
24-03000-00 GM

Asphalt Patching

Stockdale Rd. Bridge East of Nettle School Rd.

200' x 21'

Asphalt Patches	
Class D Patch Special 4" Type 4	466.67 Sq Yds

Not
For
Bid

HMA Resurfacing

Hilltop Dr: Lakeside Dr. to Lincoln Lake Dr.

L=2,480

Average Width=22'

HMA Prime Coat	2809.20 Lbs
HMA Surface Rem. 2"	6242.67 Sq Yds
HMA SC 2" Mix "C"N50	699.18 Tons

Lincoln Lake Dr: Hilltop Dr. to Cul de Sac

L=960

Average Width=22'

HMA Prime Coat	1056.00 Lbs
HMA Surface Rem. 2"	2346.67 Sq Yds
HMA SC 2" Mix "C"N50	262.83 Tons

HMA Totals	
HMA Prime Coat	3865.20 Lbs
HMA Surface Rem. 2"	8589.33 Sq Yds
HMA SC 2" Mix "C"N50	962.01 Tons

Grundy County
Highland Township

Contract Proposal Schedule of Quantities
24-09000-00 GM

HMA Surface Removal Special

**Ransom Rd: Between Johnny Run & Swell
2,000' x 20'**

Surface Removal Special	
HMA Surface Rem. Spl.	4,500.00 Sq Yds

*Grind and leave in place.

Not
For
Bid

Grundy County
Norman Township

Contract Proposal Schedule of Quantities
24-14000-00 GM

Asphalt Patching

Kinsman Rd: South of Indian Trail Rd.

78' x 6'

Asphalt Patches	
Class D Patch SPL 4" Tp4	52.00 Sq Yds

Greer Rd: East of Buffalo Rd.

33' x 8'

Asphalt Patches	
Class D Patch SPL 4" Tp4	29.33 Sq Yds

Totals	
Class D Patch SPL 4" Tp4	81.33 Sq Yds

Not For Bid

HMA Resurfacing

Saratoga Rd: Rt.6 to Gore Rd.

L=5,500'

Average Width=20.5'

Asphalt Resurfacing		
HMA Prime Coat	5661.67	Lbs
HMA Butt Joints	300.00	Sq Yds
Surf. Rem. 1" Spl.	12581.48	Sq Yds
HMA LVL BC 1"	704.56	Tons
HMA SC 2" Mix "C" N50	1409.13	Tons
Agg. Wedge Should.	350.00	Tons

Gore Rd: Saratoga Rd. to Ashton Rd.

L=5,340'

Average Width=20'

Asphalt Resurfacing		
HMA Prime Coat	5413.33	Lbs
HMA Butt Joints	333.33	Sq Yds
Surf. Rem. 1" Spl.	12029.63	Sq Yds
HMA LVL BC 1"	673.66	Tons
HMA SC 2" Mix "C" N50	1347.32	Tons
Agg. Wedge Should.	350.00	Tons

Asphalt Patching

Ashley Rd: Bridge S. of Whitman Rd.

100' x 20'

Minooka Rd: Bridge West of Rt 47

100' x 20'

Asphalt Patches		
Class D Patch SPL 4" Tp4	222.22	Sq Yds
Class D Patch SPL 4" Tp4	222.22	Sq Yds

Totals		
HMA Prime Coat	11075.00	Lbs
HMA Butt Joints	633.33	Sq Yds
Surf. Rem. 1" Spl.	24611.11	Sq Yds
HMA LVL BC 1"	1378.22	Tons
HMA SC 2" Mix "C" N50	2756.45	Tons
Agg. Wedge Should.	700.00	Tons
Class D Patch SPL 4" Tp4	444.44	Sq Yds

HMA Resurfacing

Pine Bluff Rd: Rt 47 to Dwight Rd.

L=2,514

Average Width=24'

HMA	
HMA Prime Coat	3053.47 Lbs
HMA Surface Rem. 2"	6785.48 Sq Yds
HMA SC 2" Mix "C"N50	949.97 Tons

Dwight Rd: Pine Bluff Rd. to Southmor Rd.

L=2,634

Average Width=24'

HMA	
HMA Prime Coat	3160.80 Lbs
HMA Surface Rem. 2"	7024.00 Sq Yds
HMA SC 2" Mix "C"N50	786.69 Tons

Southmor Rd: Dwight Rd. to Rt 47

L=2,514

Average Width=24'

HMA	
HMA Prime Coat	3016.80 Lbs
HMA Surface Rem. 2"	6704.00 Sq Yds
HMA SC 2" Mix "C"N50	750.85 Tons

Baker Rd: Vanderpool Rd. south to twp. line

L=3,023

Average Width=21'

HMA	
HMA Prime Coat	3174.15 Lbs
HMA Surface Rem. 2"	7053.67 Sq Yds
HMA SC 2" Mix "C"N50	790.01 Tons

HMA Totals		
HMA Prime Coat	12405.22 Lbs	
HMA Surface Rem. 2"	27567.15 Sq Yds	
HMA SC 2" Mix "C"N50	3277.51 Tons	

Asphalt Patching

Broadway Rd: South of Reed Rd.

150' x 22'

150' x 22'

Asphalt Patches	
Class D Patch SPL 4" Tp4	733.33 Sq Yds

Kankakee Rd: Bridge North of Rice Rd.

60' x 22'

Asphalt Patches	
Class D Patch SPL 4" Tp4	146.67 Sq Yds

Gorman Rd: Bridge at Grand Ridge Rd.

150' x 22'

Asphalt Patches	
Class D Patch SPL 4" Tp4	366.67 Sq Yds

Lowery Rd: Inter. To Highway Dept. Rd.

50' x 24'

Asphalt Patches	
Class D Patch SPL 4" Tp4	133.33 Sq Yds

Dupont Rd: Bridge West of Gorham Rd.

100' x 22'

Asphalt Patches	
Class D Patch SPL 4" Tp4	244.44 Sq Yds

Dresden Rd:

Patches Between Pine Bluff Rd & Duck Pond Rd

Asphalt Patches	
Class D Patch SPL 4" Tp4	875.56 Sq Yds

Totals	
Class D Patch SPL 4" Tp4	2,500.00 Sq Yds



Check Sheet for Recurring Special Provisions

Local Public Agency

County

Section Number

Grundy County & Various Townships

Grundy

24-XX000-00-GM

☐ Check this box for lettings prior to 01/01/2024.

The Following Recurring Special Provisions Indicated By An "X" Are Applicable To This Contract And Are Included By Reference:

Recurring Special Provisions

Check Sheet #		Page No.
1	<input type="checkbox"/> Additional State Requirements for Federal-Aid Construction Contracts	59
2	<input type="checkbox"/> Subletting of Contracts (Federal-Aid Contracts)	62
3	<input type="checkbox"/> EEO	63
4	<input type="checkbox"/> Specific EEO Responsibilities Non Federal-Aid Contracts	73
5	<input type="checkbox"/> Required Provisions - State Contracts	78
6	<input type="checkbox"/> Asbestos Bearing Pad Removal	84
7	<input type="checkbox"/> Asbestos Waterproofing Membrane and Asbestos HMA Surface Removal	85
8	<input type="checkbox"/> Temporary Stream Crossings and In-Stream Work Pads	86
9	<input type="checkbox"/> Construction Layout Stakes	87
10	<input type="checkbox"/> Use of Geotextile Fabric for Railroad Crossing	90
11	<input type="checkbox"/> Subsealing of Concrete Pavements	92
12	<input type="checkbox"/> Hot-Mix Asphalt Surface Correction	96
13	<input type="checkbox"/> Pavement and Shoulder Resurfacing	98
14	<input type="checkbox"/> Patching with Hot-Mix Asphalt Overlay Removal	99
15	<input type="checkbox"/> Polymer Concrete	101
16	<input type="checkbox"/> Reserved	103
17	<input type="checkbox"/> Bicycle Racks	104
18	<input type="checkbox"/> Temporary Portable Bridge Traffic Signals	106
19	<input type="checkbox"/> Nighttime Inspection of Roadway Lighting	108
20	<input type="checkbox"/> English Substitution of Metric Bolts	109
21	<input type="checkbox"/> Calcium Chloride Accelerator for Portland Cement Concrete	110
22	<input type="checkbox"/> Quality Control of Concrete Mixtures at the Plant	111
23	<input type="checkbox"/> Quality Control/Quality Assurance of Concrete Mixtures	119
24	<input type="checkbox"/> Reserved	135
25	<input type="checkbox"/> Reserved	136
26	<input type="checkbox"/> Temporary Raised Pavement Markers	137
27	<input type="checkbox"/> Restoring Bridge Approach Pavements Using High-Density Foam	138
28	<input type="checkbox"/> Portland Cement Concrete Inlay or Overlay	141
29	<input type="checkbox"/> Portland Cement Concrete Partial Depth Hot-Mix Asphalt Patching	145
30	<input type="checkbox"/> Longitudinal Joint and Crack Patching	148
31	<input type="checkbox"/> Concrete Mix Design - Department Provided	150
32	<input type="checkbox"/> Station Numbers in Pavements or Overlays	151

The Following Local Roads And Streets Recurring Special Provisions Indicated By An "X" Are Applicable To This Contract And Are Included By Reference:

Local Roads And Streets Recurring Special Provisions

<u>Check Sheet #</u>		<u>Page No.</u>
LRS 1	Reserved	153
LRS 2	<input type="checkbox"/> Furnished Excavation	154
LRS 3	<input checked="" type="checkbox"/> Work Zone Traffic Control Surveillance	155
LRS 4	<input checked="" type="checkbox"/> Flaggers in Work Zones	156
LRS 5	<input checked="" type="checkbox"/> Contract Claims	157
LRS 6	<input checked="" type="checkbox"/> Bidding Requirements and Conditions for Contract Proposals	158
LRS 7	<input type="checkbox"/> Bidding Requirements and Conditions for Material Proposals	164
LRS 8	Reserved	170
LRS 9	<input checked="" type="checkbox"/> Bituminous Surface Treatments	171
LRS 10	Reserved	175
LRS 11	<input checked="" type="checkbox"/> Employment Practices	176
LRS 12	<input checked="" type="checkbox"/> Wages of Employees on Public Works	178
LRS 13	<input checked="" type="checkbox"/> Selection of Labor	180
LRS 14	<input type="checkbox"/> Paving Brick and Concrete Paver Pavements and Sidewalks	181
LRS 15	<input checked="" type="checkbox"/> Partial Payments	184
LRS 16	<input checked="" type="checkbox"/> Protests on Local Lettings	185
LRS 17	<input checked="" type="checkbox"/> Substance Abuse Prevention Program	186
LRS 18	<input type="checkbox"/> Multigrade Cold Mix Asphalt	187
LRS 19	<input type="checkbox"/> Reflective Crack Control Treatment	188



Local Public Agency	County	Street Name/Road Name	Section Number
Grundy County & Various Townships	Grundy	Various	24-XX000-00-GM

All contractors are required to complete the following certification

- ☒ For this contract proposal or for all bidding groups in this deliver and install proposal.
- ☐ For the following deliver and install bidding groups in this material proposal.

--

Illinois Department of Transportation policy, adopted in accordance with the provisions of the Illinois Highway Code, requires this contract to be awarded to the lowest responsive and responsible bidder. The award decision is subject to approval by the Department. In addition to all other responsibility factors, this contract or deliver and install proposal requires all bidders and all bidder's subcontractors to disclose participation in apprenticeship or training programs that are (1) approved by and registered with the United States Department of Labor's Bureau of Apprenticeship and Training, and (2) applicable to the work of the above indicated proposals or groups. Therefore, all bidders are required to complete the following certification:

1. Except as provided in paragraph 4 below, the undersigned bidder certifies that it is a participant, either as an individual or as part of a group program, in an approved apprenticeship or training program applicable to each type of work or craft that the bidder will perform with its own employees.
2. The undersigned bidder further certifies, for work to be performed by subcontract, that each of its subcontractors either (A) is, at the time of such bid, participating in an approved, applicable apprenticeship or training program; or (B) will, prior to commencement of performance of work pursuant to this contract, establish participation in an approved apprenticeship or training program applicable to the work of the subcontract.
3. The undersigned bidder, by inclusion in the list in the space below, certifies the official name of each program sponsor holding the Certificate of Registration for all of the types of work or crafts in which the bidder is a participant and that will be performed with the bidder's employees. Types of work or craft that will be subcontracted shall be included and listed as subcontract work. The list shall also indicate any type of work or craft job category for which there is no applicable apprenticeship or training program available.

--

4. Except for any work identified above, if any bidder or subcontractor shall perform all or part of the work of the contract or deliver and install proposal solely by individual owners, partners or members and not by employees to whom the payment of prevailing rates of wages would be required, check the following box, and identify the owner/operator workforces and positions of ownership. ☐

--

The requirements of this certification and disclosure are a material part of the contract, and the contractor shall require this certification provision to be included in all approved subcontracts. The bidder is responsible for making a complete report and shall make certain that each type of work or craft job category that will be utilized on the project is accounted for and listed. The Department at any time before or afterward may require the production of a copy of each applicable Certificate of Registration issued by the United States Department of Labor evidencing such participation by the contractor and any or all of its subcontractors. In order to fulfill the participation requirement, it shall not be necessary that any applicable program sponsor be currently taking or that it will take applications for apprenticeship, training or employment during the performance of the work of this contract or deliver and install proposal.

Bidder	Signature & Date						
<table border="1"><tr><td></td></tr></table>		<table border="1"><tr><td></td></tr></table>					
Title							
<table border="1"><tr><td></td></tr></table>							
Address	City	State	Zip Code				
<table border="1"><tr><td></td></tr></table>		<table border="1"><tr><td></td></tr></table>		<table border="1"><tr><td></td></tr></table>		<table border="1"><tr><td></td></tr></table>	



Affidavit of Illinois Business Office

Local Public Agency	County	Street Name/Road Name	Section Number
Grundy County & Various Townships	Grundy	Various	24-XX000-00-GM

I, _____ of _____, _____,
Name of Affiant City of Affiant State of Affiant
being first duly sworn upon oath, state as follows:

1. That I am the _____ of _____.
Officer or Position Bidder
2. That I have personal knowledge of the facts herein stated.
3. That, if selected under the proposal described above, _____, will maintain a business office in the
Bidder
State of Illinois, which will be located in _____ County, Illinois.
County
4. That this business office will serve as the primary place of employment for any persons employed in the construction contemplated by this proposal.
5. That this Affidavit is given as a requirement of state law as provided in Section 30-22(8) of the Illinois Procurement Code.

Signature & Date

Print Name of Affiant

Notary Public

State of IL

County _____

Signed (or subscribed or attested) before me on _____ by _____
(date)

_____, authorized agent(s) of _____
(name/s of person/s)

Bidder

Notary Public Signature & Date

(SEAL)

My commission expires _____



Local Public Agency	County	Section Number
Grundy County & Various Townships	Grundy	24-XX000-00-GM

The following Special Provision supplement the "Standard Specifications for Road and Bridge Construction", adopted

January 1, 2022, the latest edition of the "Manual on Uniform Traffic Control Devices for Streets and Highways", and the "Manual of Test Procedures of Materials" in effect on the date of invitation of bids, and the Supplemental Specification and Recurring Special Provisions indicated on the Check Sheet included here in which apply to and govern the construction of the above named section, and in case of conflict with any parts, or parts of said Specifications, the said Special Provisions shall take precedence and shall govern.

LOCATION OF WORK

See attached schedule of quantities and location maps.

PROSECUTION OF WORK

Add the following to the first paragraph of Article 108.06: "The contractor shall, at all times, employ sufficient labor and equipment to assure a minimum daily application rate of 400 tons for township projects and 1000 tons for county projects of Hot-Mix Asphalt. This minimum rate shall not be construed to have a bearing on the number of working days allotted in this contract."

RESPONSIBILITY OF THE CONTRACTOR

The contractor shall notify the Engineer and Highway Commissioner a minimum of 72 hours prior to the commencement of work when they plan to begin and/or the start of a new construction activity.

The contractor shall responsible to ensure that all utilities have been marked on site at least 48 hours prior to the start of construction or as required by law.

The contractor shall protect any existing drainage fixture and field tiles providing drainage whether marked or unmarked on the plans. Should damage occur due to the contractor's activities, the contractor shall repair said damage at the contractor's own expense unless the Engineer determines that the damage was unavoidable.

Should a conflict be discovered between these plans and conditions in the field, the contractor shall notify the Engineer immediately of the issue(s). No work that will directly affect or be affected by the conflict may proceed without the Engineer's approval.

KEEPING ROAD OPEN TO TRAFFIC

The roads involved in this Section shall be kept open to two-way traffic at all times except when construction operations require, as directed by the Engineer, temporarily closing to traffic in one direction. The Engineer will be the sole judge as to the necessity of lane closures and the length and duration of same. Should closure of road to all traffic be required, the contractor must obtain approval from the Engineer prior to the closure. The Engineer may add requirements and/or conditions for the closure as deemed necessary. The contractor shall maintain access to private property throughout the limits of the improvement in accordance with the applicable portions of Article 107.09 and Article 107.14 of the "Standard Specifications", and as directed by the Engineer.

CONSTRUCTION SIGNS AND BARRICADES

All temporary signs and barricades as specified in Article 107.14 and in the standards listed in the plans shall be furnished, erected and maintained by the contractor. The cost of said signs and barricades shall be included in the cost of Hot-Mix Asphalt and no extra compensation will be allowed.

MOBILIZATION

The provisions of Section 671 of the Standard Specifications are not applicable to this Proposal.

CONSTRUCTION DEBRIS

Add the following to the third paragraph of Article 202.03 of the Standard Specifications:

“ The contractor shall not conduct any generation, transportation or recycling of construction or demolition debris, clean or general or uncontaminated soil during construction, remodeling, repair or demolition of utilities, structures and roads that is not commingled with any waste, without the maintenance of documentation identifying the hauler, generator or place of origin of the debris or soil, the weight or volume of the debris or soil, and the location, owner and operator of the facility where debris or soil was transferred, disposed, recycled or treated, This documentation must be maintained by the Contractor for a minimum of three years after final acceptance of the project by the Department.”

BITUMINOUS MATERIALS (PRIME COAT)

1. Revise Article 406.02(b) Note 1 to read: “The prime coat used on brick, concrete, or Hot-Mix Asphalt bases shall be RC-70 or SS-1. Prime on aggregate bases shall be MC-30 or PEP”.
2. Add the following sentence to the end of the sixth paragraph of Article 406.05(b)(1) of the Standard Specifications: “The prime coat shall be placed no later than 5 p.m. unless otherwise directed by the Engineer.”

ALL HOT-MIX ASPHALT MIXTURES

Revise Article 1030.02(g) Note 2 to read: “All Hot-Mix Asphalt shall be PG64-22.

HOT-MIX ASPHALT, CUT OFF DATE

Placement of Hot-Mix Asphalt will not be permitted after October 5, unless approved, in writing, by the Engineer.

ALL HOT-MIX ASPHALT MIXTURES

If it is determined during mixture design that Anti-Stripping Additive is necessary, it shall conform to Article 1030.04. The cost of the additive will not be paid for separately but shall be included in the cost of Hot-Mix Asphalt.

INCIDENTAL HOT-MIX ASPHALT SURFACING

Mailbox turnouts and field entrances shall be placed with an extendible screed widener where possible. When an extendible screed widener is used, paving shall be considered and integral part of mainline paving and will not be measured for payment as INCIDENTAL HOT-MIX ASPHALT SURFACING.

SURFACE TESTS

Add the following after the table in the third paragraph of Article 406.11: “If more than 10 surface variations exceeding 3/16” are found on the entire project the deduction per variation shall be 4 tons.

QC/QA HOT-MIX ASPHALT

Test strips will not be required on this Contract.

HOT-MIX ASPHALT MIXTURES N50

Description. This work shall consist of constructing Hot-Mix Asphalt Surface Course Mix "C", N50, Leveling Binder (Machine Method), N50 and Hot-Mix Asphalt Binder Course IL 19.0L, N50 according to Section 1030 of the Standard Specifications.

QC/QA, Design and production shall be according to the Low ESAL requirements specified in the Standard Specifications for Road and Bridge Construction adopted January 1, 2022 and the Supplemental Specifications and Recurring Special Provision. At the discretion of the Engineer and QA Manager

Local Public Agency	County	Section Number
Grundy County & Various Townships	Grundy	24-XX000-00-GM

acceptance of the density of the mix may be based upon the Nuclear Density Growth Curve Method.

Basis of Payment, This work will be paid for at the contract unit price per ton for HOT-MIX ASPHALT SURFACE COURSE MIX "C" N50, LEVELING BINDER (MACHINE METHOD) N50, HOT-MIX ASPHALT BINDER COURSE IL-19.0L N50. Anti-strip if required shall be included in the unit price per ton.

TEMPORARY RAMPS

Temporary Ramps shall be constructed in accordance with Article 406.08 and shall be included in the cost of Hot-Mix Asphalt and no extra compensation will be allowed.

TRAFFIC CONTROL PLAN

Traffic control shall be in accordance with the applicable sections of the Standard Specification for Road and Bridge Construction, the applicable guidelines contained in the Illinois Manual on Uniform Traffic Control Devices for Street and Highways, these Special Provisions, and any special details and Highway standards contained herein and in the plans. Traffic control shall meet IDOT Standards outlined in packet. All costs for traffic control protection including labor, equipment, and material shall not be paid separately but shall be included in the contract pay items.

CLASS D PATCHES, 4 Inch (Special)

This work shall be done in accordance with Section 442 and 1030 of the Standard Specifications with the following exceptions: Preparation, Priming, and Leveling of HMA - The Tack Coat shall be applied per Article 406.05 of the Standard Specifications or to the satisfaction of the Engineer prior to placement of the Class D Patches, 4 Inch.

The HMA 4 Inch patches shall be placed in 2 lifts.

Article 442.11 Basis of Payment - This work shall be paid for at the contract unit price per square yard for Class D Patches, 4 Inch (Special) which price shall include Quality Control as per Section 1030 and all the work specified in this Special Provision.

PG Grade	PG 64-22
Design Air Voids	4% at N50
Mixture Composition	IL 9.5
Friction Aggregate	Mixture C

As an alternate, the Contractor may use an approved rotomill to remove existing pavement. Should the rotomill damage the pavement which are to remain in place, the Engineer will withdraw approval of this method.

Quantities are estimates prepared for the establishment of pay item prices and are the responsibility of the contractor to confirm prior to bidding. Quantities may be increased, decreased, or omitted to satisfactorily complete the project.

PREPARATION OF BASE

Revise the first sentence of the second paragraph of Article 358.04(b) to read: After the surface of the base course has been brought to a smooth grade and proper crown, each mile shall be compacted by repeated wetting and rolling with a pneumatic-tired roller for a period of not less than six (6) hours. A steel drum wheel roller may be used instead of a pneumatic-tired roller if approved by the Engineer.

Revise the third sentence of the second paragraph of Article 358.04(b) to read: Before a prime coat is applied, the base shall be surface dry, but at no time shall the period of drying be less than four (4) hours. No priming shall be performed after 7:00 P.M. The Engineer shall be the sole judge of drying time.



Local Public Agency	County	Section Number
Grundy County & Various Townships	Grundy	24-XX000-00-GM

The following Special Provision supplement the "Standard Specifications for Road and Bridge Construction", adopted

January 1, 2022

, the latest edition of the "Manual on Uniform Traffic Control Devices for Streets and Highways", and the "Manual of Test Procedures of Materials" in effect on the date of invitation of bids, and the Supplemental Specification and Recurring Special Provisions indicated on the Check Sheet included here in which apply to and govern the construction of the above named section, and in case of conflict with any parts, or parts of said Specifications, the said Special Provisions shall take precedence and shall govern.

***Contractor shall notify Highway Engineer and Highway Commissioner 72 hours prior to commencing operations.

1. Section: 24-03000-00-GM, Erienna Township:
 - A. Class D 4" Patch Special on various locations laid out on schedule of quantities.
2. Section: 24-07000-00-GM, Goose Lake Township:
 - A. HMA Surface Removal and Resurfacing of Hilltop Dr. and Lincoln Lake Dr. with Hot-Mix Asphalt.
3. Section: 24-09000-00-GM, Highland Township:
 - A. ***HMA Surface Removal Special: This work shall generally consist of milling the existing pavement to a depth of 3" while leaving the material in place. No material is expected to be removed from this section. This work shall be paid at the contract unit price per square yard for HMA Surface Removal Special.
4. Section: 24-14000-00-GM, Norman Township:
 - A. Class D 4" Patch Special on various locations laid out on schedule of quantities.
5. Section: 24-15000-00-GM, Saratoga Township:
 - A. Class D 4" Patch Special on various locations laid out on schedule of quantities.
 - B. HMA Surface Removal and Resurfacing of Saratoga Rd. and Gore Rd. with Hot-Mix Asphalt.
 - C. ***HMA Surface Removal 1" Special: This work shall generally consist of profile milling existing pavement to a depth of 1". Grinding material is not to be removed from these locations, but shall be broomed to the shoulder area to build up the existing shoulder. This work shall be paid for at the contract unit price for HMA Surface Removal Special 1".
 - D. ***Road Commissioner requests the use of asphalt grindings to be used for Aggregate Wedge Shoulder.
6. Section: 24-17000-00-GM, Wauponsee Township:
 - A. HMA Surface Removal and Resurfacing of Southmor Rd. Dwight Rd. Pine Bluff Rd. and Baker Rd.
7. Section: 24-00000-00-GM, Grundy County:
 - A. Class D 4" Patch Special on various locations laid out on schedule of quantities.

BDE SPECIAL PROVISIONS
For the January 19 and March 8, 2024 Lettings

The following special provisions indicated by a “check mark” are applicable to this contract and will be included by the Project Coordination and Implementation Section of the Bureau of Design & Environment (BDE).

File Name	#		Special Provision Title	Effective	Revised
	80099	1	<input type="checkbox"/> Accessible Pedestrian Signals (APS)	April 1, 2003	Jan. 1, 2022
	80274	2	<input type="checkbox"/> Aggregate Subgrade Improvement	April 1, 2012	April 1, 2022
	80192	3	<input type="checkbox"/> Automated Flagger Assistance Devices	Jan. 1, 2008	April 1, 2023
	80173	4	<input type="checkbox"/> Bituminous Materials Cost Adjustments	Nov. 2, 2006	Aug. 1, 2017
	80426	5	<input type="checkbox"/> Bituminous Surface Treatment with Fog Seal	Jan. 1, 2020	Jan. 1, 2022
*	80241	6	<input type="checkbox"/> Bridge Demolition Debris	July 1, 2009	
*	50531	7	<input type="checkbox"/> Building Removal	Sept. 1, 1990	Aug. 1, 2022
*	50261	8	<input type="checkbox"/> Building Removal with Asbestos Abatement	Sept. 1, 1990	Aug. 1, 2022
	80449	9	<input type="checkbox"/> Cement, Type IL	Aug. 1, 2023	
	80384	10	<input checked="" type="checkbox"/> Compensable Delay Costs	June 2, 2017	April 1, 2019
*	80198	11	<input checked="" type="checkbox"/> Completion Date (via calendar days)	April 1, 2008	
*	80199	12	<input type="checkbox"/> Completion Date (via calendar days) Plus Working Days	April 1, 2008	
	80453	13	<input type="checkbox"/> Concrete Sealer	Nov. 1, 2023	
	80261	14	<input type="checkbox"/> Construction Air Quality – Diesel Retrofit	June 1, 2010	Nov. 1, 2014
	80434	15	<input type="checkbox"/> Corrugated Plastic Pipe (Culvert and Storm Sewer)	Jan. 1, 2021	
*	80029	16	<input type="checkbox"/> Disadvantaged Business Enterprise Participation	Sept. 1, 2000	Mar. 2, 2019
	80229	17	<input type="checkbox"/> Fuel Cost Adjustment	April 1, 2009	Aug. 1, 2017
	80452	18	<input type="checkbox"/> Full Lane Sealant Waterproofing System	Nov. 1, 2023	
	80447	19	<input type="checkbox"/> Grading and Shaping Ditches	Jan. 1, 2023	
	80433	20	<input type="checkbox"/> Green Preformed Thermoplastic Pavement Markings	Jan. 1, 2021	Jan. 1, 2022
	80443	21	<input type="checkbox"/> High Tension Cable Median Barrier Removal	April 1, 2022	
	80456	22	<input type="checkbox"/> Hot-Mix Asphalt	Jan. 1, 2024	
	80446	23	<input type="checkbox"/> Hot-Mix Asphalt - Longitudinal Joint Sealant	Nov. 1, 2022	Aug. 1, 2023
	80438	24	<input type="checkbox"/> Illinois Works Apprenticeship Initiative – State Funded Contracts	June 2, 2021	Sept. 2, 2021
	80045	25	<input type="checkbox"/> Material Transfer Device	June 15, 1999	Jan. 1, 2022
	80450	26	<input type="checkbox"/> Mechanically Stabilized Earth Retaining Walls	Aug. 1, 2023	
	80441	27	<input type="checkbox"/> Performance Graded Asphalt Binder	Jan. 1, 2023	
	80451	28	<input type="checkbox"/> Portland Cement Concrete	Aug. 1, 2023	
*	34261	29	<input type="checkbox"/> Railroad Protective Liability Insurance	Dec. 1, 1986	Jan. 1, 2022
	80455	30	<input type="checkbox"/> Removal and Disposal of Regulated Substances	Jan. 1, 2024	
	80445	31	<input type="checkbox"/> Seeding	Nov. 1, 2022	
	80448	32	<input type="checkbox"/> Source of Supply and Quality Requirements	Jan. 2, 2023	
	80340	33	<input type="checkbox"/> Speed Display Trailer	April 2, 2014	Jan. 1, 2022
	80127	34	<input type="checkbox"/> Steel Cost Adjustment	April 2, 2004	Jan. 1, 2022
	80397	35	<input type="checkbox"/> Subcontractor and DBE Payment Reporting	April 2, 2018	
	80391	36	<input checked="" type="checkbox"/> Subcontractor Mobilization Payments	Nov. 2, 2017	April 1, 2019
	80437	37	<input type="checkbox"/> Submission of Payroll Records	April 1, 2021	Nov. 2, 2023
	80435	38	<input type="checkbox"/> Surface Testing of Pavements – IRI	Jan. 1, 2021	Jan. 1, 2023
	80410	39	<input type="checkbox"/> Traffic Spotters	Jan. 1, 2019	
*	20338	40	<input type="checkbox"/> Training Special Provisions	Oct. 15, 1975	Sept. 2, 2021
	80429	41	<input type="checkbox"/> Ultra-Thin Bonded Wearing Course	April 1, 2020	Jan. 1, 2022
	80439	42	<input type="checkbox"/> Vehicle and Equipment Warning Lights	Nov. 1, 2021	Nov. 1, 2022
	80302	43	<input type="checkbox"/> Weekly DBE Trucking Reports	June 2, 2012	Nov. 1, 2021
	80454	44	<input type="checkbox"/> Wood Sign Support	Nov. 1, 2023	
	80427	45	<input checked="" type="checkbox"/> Work Zone Traffic Control Devices	Mar. 2, 2020	
*	80071	46	<input type="checkbox"/> Working Days	Jan. 1, 2002	

Highlighted items indicate a new or revised special provision for the letting.

An * indicates the special provision requires additional information from the designer, which needs to be submitted separately. The Project Coordination and Implementation Section will then include the information in the applicable special provision.

The following special provisions are in the 2024 Supplemental Specifications and Recurring Special Provisions.

<u>File Name</u>	<u>Special Provision Title</u>	<u>New Location(s)</u>	<u>Effective</u>	<u>Revised</u>
80436	Blended Finely Divided Minerals	Articles 1010.01 & 1010.06	April 1, 2021	
80440	Waterproofing Membrane System	Article 1061.05	Nov. 1, 2021	

Not
For
Bid

All Regional Engineers

Scott E. Stitt

Special Provision for Completion Date (via calendar days)

January 14, 2011

This special provision was developed per the recommendations of an FHWA/IDOT Joint Process Review to establish a form of contract time which is based upon a set number of calendar days.

This special provision should be used at the district's discretion and per the guidance in Chapter 66 of the Bureau of Design and Environment Manual.

The districts should include the BDE Check Sheet marked with the applicable special provisions for the April 29, 2011, and subsequent lettings. The Project Development and Implementation Section will include a copy in the contract.

This special provision will be available on the transfer directory January 14, 2011.

80198m

COMPLETION DATE (VIA CALENDAR DAYS) (BDE)

Effective: April 1, 2008

The Contractor shall complete all work on or before the completion date of this contract which will be based upon 10 calendar days.

The completion date will be determined by adding the specified number of calendar days to the date the Contractor begins work, or to the date ten days after execution of the contract, whichever is the earlier, unless a delayed start is granted by the Engineer.

80198

Completion Date: October 5, 2024



Illinois Department of Transportation

Memorandum

To: Regional Engineers
From: Jack A. Elston 
Subject: Special Provision for Work Zone Traffic Control Devices
Date: January 10, 2020

This special provision was developed by the Bureau of Safety Programs and Engineering to update temporary traffic control devices to MASH-16 requirements in accordance with AASHTO and FHWA guidelines.

This special provision should be inserted into all contracts.

The districts should include the BDE Check Sheet marked with the applicable special provisions for the April 24, 2020 and subsequent lettings. The Project Coordination and Implementation Section will include a copy in the contract.

This special provision will be available on the transfer directory January 10, 2020.

80427m

WORK ZONE TRAFFIC CONTROL DEVICES (BDE)

Effective: March 2, 2020

Add the following to Article 701.03 of the Standard Specifications:

“(q) Temporary Sign Supports1106.02”

Revise the third paragraph of Article 701.14 of the Standard Specifications to read:

“For temporary sign supports, the Contractor shall provide a FHWA eligibility letter for each device used on the contract. The letter shall provide information for the set-up and use of the device as well as a detailed drawing of the device. The signs shall be supported within 20 degrees of vertical. Weights used to stabilize signs shall be attached to the sign support per the manufacturer’s specifications.”

Revise the first paragraph of Article 701.15 of the Standard Specifications to read:

“**701.15 Traffic Control Devices.** For devices that must meet crashworthiness standards, the Contractor shall provide a manufacturer’s self-certification or a FHWA eligibility letter for each Category 1 device and a FHWA eligibility letter for each Category 2 and Category 3 device used on the contract. The self-certification or letter shall provide information for the set-up and use of the device as well as a detailed drawing of the device.”

Revise the first six paragraphs of Article 1106.02 of the Standard Specifications to read:

“**1106.02 Devices.** Work zone traffic control devices and combinations of devices shall meet crashworthiness standards for their respective categories. The categories are as follows.

Category 1 includes small, lightweight, channelizing and delineating devices that have been in common use for many years and are known to be crashworthy by crash testing of similar devices or years of demonstrable safe performance. These include cones, tubular markers, plastic drums, and delineators, with no attachments (e.g. lights). Category 1 devices manufactured after December 31, 2019 shall be MASH-16 compliant. Category 1 devices manufactured on or before December 31, 2019, and compliant with NCHRP 350 or MASH 2009, may be used on contracts let before December 31, 2024.

Category 2 includes devices that are not expected to produce significant vehicular velocity change but may otherwise be hazardous. These include vertical panels with lights, barricades, temporary sign supports, and Category 1 devices with attachments (e.g. drums with lights). Category 2 devices manufactured after December 31, 2019 shall be MASH-16 compliant. Category 2 devices manufactured on or before December 31, 2019, and compliant with NCHRP 350 or MASH 2009, may be used on contracts let before December 31, 2024.

Category 3 includes devices that are expected to cause significant velocity changes or other potentially harmful reactions to impacting vehicles. These include crash cushions (impact

attenuators), truck mounted attenuators, and other devices not meeting the definitions of Category 1 or 2. Category 3 devices manufactured after December 31, 2019 shall be MASH-16 compliant. Category 3 devices manufactured on or before December 31, 2019, and compliant with NCHRP 350 or MASH 2009, may be used on contracts let before December 31, 2029. Category 3 devices shall be crash tested for Test Level 3 or the test level specified.

Category 4 includes portable or trailer-mounted devices such as arrow boards, changeable message signs, temporary traffic signals, and area lighting supports. It is preferable for Category 4 devices manufactured after December 31, 2019 to be MASH-16 compliant; however, there are currently no crash tested devices in this category, so it remains exempt from the NCHRP 350 or MASH compliance requirement.

For each type of device, when no more than one MASH-16 compliant is available, an NCHRP 350 or MASH-2009 compliant device may be used, even if manufactured after December 31, 2019.”

Revise Articles 1106.02(g), 1106.02(k), and 1106.02(l) to read:

- “(g) Truck Mounted/Trailer Mounted Attenuators. The attenuator shall be approved for use at Test Level 3. Test Level 2 may be used for normal posted speeds less than or equal to 45 mph.
- (k) Temporary Water Filled Barrier. The water filled barrier shall be a lightweight plastic shell designed to accept water ballast and be on the Department’s qualified product list.

Shop drawings shall be furnished by the manufacturer and shall indicate the deflection of the barrier as determined by acceptance testing; the configuration of the barrier in that test; and the vehicle weight, velocity, and angle of impact of the deflection test. The Engineer shall be provided one copy of the shop drawings.

- (l) Movable Traffic Barrier. The movable traffic barrier shall be on the Department’s qualified product list.

Shop drawings shall be furnished by the manufacturer and shall indicate the deflection of the barrier as determined by acceptance testing; the configuration of the barrier in that test; and the vehicle weight, velocity, and angle of impact of the deflection test. The Engineer shall be provided one copy of the shop drawings. The barrier shall be capable of being moved on and off the roadway on a daily basis.”



Illinois Department of Transportation

Memorandum

To: Regional Engineers
From: Jack A. Elston 
Subject: Special Provision for Compensable Delay Costs
Date: January 11, 2019

This special provision was developed to allow the department to pay for escalated material costs, escalated labor costs, extended project overhead, and extended traffic control when a contract delay meets certain criteria. It has been revised to remove the extended traffic control adjustment equations for completion date contracts and simply refer to Article 109.04

This special provision should be inserted into all contracts.

The districts should include the BDE Check Sheet marked with the applicable special provisions for the April 26, 2019 and subsequent lettings. The Project Coordination and Implementation Section will include a copy in the contract.

This special provision will be available on the transfer directory January 11, 2019.

80384m

COMPENSABLE DELAY COSTS (BDE)

Effective: June 2, 2017

Revised: April 1, 2019

Revise Article 107.40(b) of the Standard Specifications to read:

“(b) Compensation. Compensation will not be allowed for delays, inconveniences, or damages sustained by the Contractor from conflicts with facilities not meeting the above definition; or if a conflict with a utility in an unanticipated location does not cause a shutdown of the work or a documentable reduction in the rate of progress exceeding the limits set herein. The provisions of Article 104.03 notwithstanding, compensation for delays caused by a utility in an unanticipated location will be paid according to the provisions of this Article governing minor and major delays or reduced rate of production which are defined as follows.

- (1) Minor Delay. A minor delay occurs when the work in conflict with the utility in an unanticipated location is completely stopped for more than two hours, but not to exceed two weeks.
- (2) Major Delay. A major delay occurs when the work in conflict with the utility in an unanticipated location is completely stopped for more than two weeks.
- (3) Reduced Rate of Production Delay. A reduced rate of production delay occurs when the rate of production on the work in conflict with the utility in an unanticipated location decreases by more than 25 percent and lasts longer than seven calendar days.”

Revise Article 107.40(c) of the Standard Specifications to read:

“(c) Payment. Payment for Minor, Major, and Reduced Rate of Production Delays will be made as follows.

- (1) Minor Delay. Labor idled which cannot be used on other work will be paid for according to Article 109.04(b)(1) and (2) for the time between start of the delay and the minimum remaining hours in the work shift required by the prevailing practice in the area.

Equipment idled which cannot be used on other work, and which is authorized to standby on the project site by the Engineer, will be paid for according to Article 109.04(b)(4).

- (2) Major Delay. Labor will be the same as for a minor delay.

Equipment will be the same as for a minor delay, except Contractor-owned equipment will be limited to two weeks plus the cost of move-out to either the

Contractor's yard or another job and the cost to re-mobilize, whichever is less. Rental equipment may be paid for longer than two weeks provided the Contractor presents adequate support to the Department (including lease agreement) to show retaining equipment on the job is the most economical course to follow and in the public interest.

- (3) Reduced Rate of Production Delay. The Contractor will be compensated for the reduced productivity for labor and equipment time in excess of the 25 percent threshold for that portion of the delay in excess of seven calendar days. Determination of compensation will be in accordance with Article 104.02, except labor and material additives will not be permitted.

Payment for escalated material costs, escalated labor costs, extended project overhead, and extended traffic control will be determined according to Article 109.13."

Revise Article 108.04(b) of the Standard Specifications to read:

"(b) No working day will be charged under the following conditions.

- (1) When adverse weather prevents work on the controlling item.
- (2) When job conditions due to recent weather prevent work on the controlling item.
- (3) When conduct or lack of conduct by the Department or its consultants, representatives, officers, agents, or employees; delay by the Department in making the site available; or delay in furnishing any items required to be furnished to the Contractor by the Department prevents work on the controlling item.
- (4) When delays caused by utility or railroad adjustments prevent work on the controlling item.
- (5) When strikes, lock-outs, extraordinary delays in transportation, or inability to procure critical materials prevent work on the controlling item, as long as these delays are not due to any fault of the Contractor.
- (6) When any condition over which the Contractor has no control prevents work on the controlling item."

Revise Article 109.09(f) of the Standard Specifications to read:

- "(f) Basis of Payment. After resolution of a claim in favor of the Contractor, any adjustment in time required for the work will be made according to Section 108. Any adjustment in the costs to be paid will be made for direct labor, direct materials, direct equipment, direct jobsite overhead, direct offsite overhead, and other direct costs allowed by the resolution. Adjustments in costs will not be made for interest charges, loss of anticipated profit, undocumented loss of efficiency, home office overhead and unabsorbed overhead

other than as allowed by Article 109.13, lost opportunity, preparation of claim expenses and other consequential indirect costs regardless of method of calculation.

The above Basis of Payment is an essential element of the contract and the claim cost recovery of the Contractor shall be so limited.”

Add the following to Section 109 of the Standard Specifications.

“109.13 Payment for Contract Delay. Compensation for escalated material costs, escalated labor costs, extended project overhead, and extended traffic control will be allowed when such costs result from a delay meeting the criteria in the following table.

Contract Type	Cause of Delay	Length of Delay
Working Days	Article 108.04(b)(3) or Article 108.04(b)(4)	No working days have been charged for two consecutive weeks.
Completion Date	Article 108.08(b)(1) or Article 108.08(b)(7)	The Contractor has been granted a minimum two week extension of contract time, according to Article 108.08.

Payment for each of the various costs will be according to the following.

- (a) Escalated Material and/or Labor Costs. When the delay causes work, which would have otherwise been completed, to be done after material and/or labor costs have increased, such increases will be paid. Payment for escalated material costs will be limited to the increased costs substantiated by documentation furnished by the Contractor. Payment for escalated labor costs will be limited to those items in Article 109.04(b)(1) and (2), except the 35 percent and 10 percent additives will not be permitted.
- (b) Extended Project Overhead. For the duration of the delay, payment for extended project overhead will be paid as follows.
 - (1) Direct Jobsite and Offsite Overhead. Payment for documented direct jobsite overhead and documented direct offsite overhead, including onsite supervisory and administrative personnel, will be allowed according to the following table.

Original Contract Amount	Supervisory and Administrative Personnel
Up to \$5,000,000	One Project Superintendent
Over \$ 5,000,000 - up to \$25,000,000	One Project Manager, One Project Superintendent or Engineer, and One Clerk
Over \$25,000,000 - up to \$50,000,000	One Project Manager, One Project Superintendent, One Engineer, and

	One Clerk
Over \$50,000,000	One Project Manager, Two Project Superintendents, One Engineer, and One Clerk

(2) Home Office and Unabsorbed Overhead. Payment for home office and unabsorbed overhead will be calculated as 8 percent of the total delay cost.

(c) Extended Traffic Control. Traffic control required for an extended period of time due to the delay will be paid for according to Article 109.04.

When an extended traffic control adjustment is paid under this provision, an adjusted unit price as provided for in Article 701.20(a) for increase or decrease in the value of work by more than ten percent will not be paid.

Upon payment for a contract delay under this provision, the Contractor shall assign subrogation rights to the Department for the Department's efforts of recovery from any other party for monies paid by the Department as a result of any claim under this provision. The Contractor shall fully cooperate with the Department in its efforts to recover from another party any money paid to the Contractor for delay damages under this provision."

80384

State of Illinois
DEPARTMENT OF TRANSPORTATION
Bureau of Local Roads & Streets

SPECIAL PROVISION
FOR
EMULSIFIED ASPHALTS

Effective: January 1, 2007
Revised: February 7, 2008

All references to Sections and Articles in this Special Provision shall be construed to mean specific Sections and Articles in the Standard Specifications for Road and Bridge Construction adopted by the Department of Transportation.

Replace the table after Note 2 in Article 403.02 with the following:

Type of Construction	Bituminous Materials Recommended for Weather Conditions Indicated	
	Warm [15 °C to 30 °C]* [(60 °F to 85 °F)]*	Hot [30 °C Plus]* [(85 °F Plus)]*
Prime	MC-30, PEP	MC-30, PEP
Cover Coat and Seal Coat	RS-2, CRS-2, RC-800, RC-3000, MC-800, MC-3000, SC-3000, HFE-90, HFE-150, HFE-300, HFRS-2, PEA**	RS-2, CRS-2, RC-800, RC-3000, MC-800, MC-3000, SC-3000, PG46-28, PG52-28, HFE-90, HFE-150, HFE-300, HFRS-2, PEA**

* Temperature of the air in the shade at the time of application.

** PEA is only allowed on roads with low traffic volumes

Replace the table after Note 2 in Article 406.02 with the following:

Type of Construction	Bituminous Materials Recommended
Prime (tack) on Brick, Concrete, or Bituminous Bases (Note 3)	SS-1, SS-1h, CSS-1, CSS-1h, HFE-90, RC-70
Prime on Aggregate Bases (Note 4)	MC-30, PEP
Mixture for Cracks, Joints, and Flangeways	PG58-22, PG64-22

Note 3. When emulsified asphalts are used, they shall be diluted with an equal volume of potable water. HFE emulsions shall be diluted by the manufacturer. The diluted material shall be thoroughly agitated within 24 hours of application and show no separation of water and emulsion. The diluted material shall not be returned to an approved emulsion storage tank.

Note 4. Preparation of the bituminous PEP shall be as specified in Article 403.05.

Replace the table in Article 1032.04 with the following:

Spraying Application Temperature Ranges		
Type and Grade of Bituminous Material	Temperature Ranges	
	°F min. - max.	°C min. - max.
PEP	60 - 130	15 - 55
PEA	140 - 190	60 - 88
MC-30	85 - 190	30 - 90
MC-70, RC-70, SC-70	120 - 225	50 - 105
MC-250, SC-250	165 - 270	75 - 130
MC-800, SC-800	200 - 305	95 - 150
MC-3000, SC-3000	230 - 345	110 - 175
PG46-28	275 - 385	135 - 195
PG52-28	285 - 395	140 - 200
RS-2, CRS-2	110 - 160	45 - 70
SS-1, SS-1h, CSS-1, CSS-1h	75 - 130	25 - 55
SS-1hP, CSS-1hP	75 - 130	25 - 55
HFE-90, HFE-150, HFE-300	150 - 180	65 - 80
HFP, CRSP, HFRS-2	150 - 180	65 - 80
E-2	85 - 190	30 - 90
E-3	120 - 225	50 - 105
E-4	165 - 270	75 - 130

Add subparagraph (g) to Article 1032.06:

- (g) Penetrating Emulsified Asphalt (PEA). The penetrating emulsified asphalt shall meet the following requirements when tested according to AASHTO T59:

Viscosity, Saybolt Fural @ 25°C (77°F),	sec:	20 - 500
Sieve Test, retained on 850 µm (No. 20) sieve, maximum,	%:	0.10
Storage Stability Test, 1 day, maximum,	%:	1
Float Test @ 60°C (140°F), minimum,	sec:	150
Stone Coating Test, 3 minutes,	:	Stone Coated Thoroughly
Particle Charge	:	Negative
pH, minimum	:	7.3
Distillation Test:		
Distillation to 260°C (500°F) Residue, minimum	%:	65
Oil Distillate by Volume, maximum	%:	3
Test on residue from distillation:		
Penetration @ 25°C (77°F), 100 g, 5 sec, minimum	dmm:	300

Replace the last sentence and table of Article 1032.06 with the following:

The different grades are, in general, used for the following.

Grade	Use
SS-1, SS-1h, CSS-1, CSS-1h, HFE 90, SS-1hP, CSS-1hP	Tack or fog seal
PEP	Bituminous surface treatment prime
RS-2, HFE 90, HFE 150, HFE 300, CRSP, HFP, CRS-2, HFRS-2, PEA	Bituminous surface treatment
CSS-1h Latex Modified	Microsurfacing

State of Illinois
Department of Transportation
Bureau of Local Roads and Streets
SPECIAL PROVISION
FOR
CONSTRUCTION AND MAINTENANCE SIGNS

Effective: January 1, 2004
Revised: June 1, 2007

All references to Sections or Articles in this specification shall be construed to mean a specific Section or Article of the Standard Specifications for Road and Bridge Construction, adopted by the Department of Transportation.

701.14. Signs. Add the following paragraph to Article 701.14:

All warning signs shall have minimum dimensions of 1200 mm x 1200 mm (48" x 48") and have a black legend on a fluorescent orange reflectorized background, meeting, as a minimum, Type AP reflectivity requirements of Table 1091-2 in Article 1091.02.

State of Illinois
Department of Transportation
Bureau of Local Roads and Streets

SPECIAL PROVISION
FOR
INSURANCE

Effective: February 1, 2007

Revised: August 1, 2007

All references to Sections or Articles in this specification shall be construed to mean specific Section or Article of the Standard Specifications for Road and Bridge Construction, adopted by the Department of Transportation.

The Contractor shall name the following entities as additional insured under the Contractor's general liability insurance policy in accordance with Article 107.27:

Erienna Township

Goose Lake Township

Highland Township

Norman Township

Saratoga Township

Wauponsee Township

Grundy County

The entities listed above and their officers, employees, and agents shall be indemnified and held harmless in accordance with Article 107.26.

Grundy County Prevailing Wage Rates posted on 1/16/2024

Trade Title	Rg	Type	C	Base	Foreman	Overtime					H/W	Pension	Vac	Other		Add OT 1.5x owed	Add OT 2.0x owed
						M-F	Sa	Su	Hol	Trng				Ins			
ASBESTOS ABT-GEN	All	ALL		48.90	49.90	1.5	1.5	2.0	2.0	17.37	15.91	0.00	0.91			0.00	0.00
ASBESTOS ABT-MEC	All	BLD		40.59	43.84	1.5	1.5	2.0	2.0	15.22	15.16	0.00	0.88			2.80	5.60
BOILERMAKER	All	BLD		54.71	59.63	2.0	2.0	2.0	2.0	6.97	25.06	0.00	2.83			0.00	0.00
BRICK MASON	All	BLD		50.81	55.89	1.5	1.5	2.0	2.0	12.50	23.01	0.00	1.16	0.00		0.00	0.00
CARPENTER	All	ALL		53.51	58.86	1.5	1.5	2.0	2.0	12.29	25.77	1.20	0.81			0.00	0.00
CEMENT MASON	All	ALL		46.25	48.25	2.0	1.5	2.0	2.0	12.39	31.82	0.00	0.80	0.00		0.00	0.00
CERAMIC TILE FINISHER	All	BLD		45.62	45.62	1.5	1.5	2.0	2.0	12.75	15.64	0.00	1.04	0.00		0.00	0.00
CERAMIC TILE LAYER	All	BLD		53.14	58.14	1.5	1.5	2.0	2.0	12.75	19.41	0.00	1.12	0.00		0.00	0.00
COMMUNICATION TECHNICIAN	All	BLD		43.00	47.30	1.5	1.5	2.0	2.0	16.89	16.10	0.00	0.75	2.37		0.00	0.00
ELECTRIC PWR EQMT OP	All	ALL		60.15	66.00	1.5	1.5	2.0	2.0	13.08	20.29	0.00	3.25	0.00		0.00	0.00
ELECTRIC PWR GRNDMAN	All	ALL		46.92	66.00	1.5	1.5	2.0	2.0	10.21	15.83	0.00	2.54	0.00		0.00	0.00
ELECTRIC PWR LINEMAN	All	ALL		60.15	66.00	1.5	1.5	2.0	2.0	13.08	20.29	0.00	3.25	0.00		0.00	0.00
ELECTRICIAN	All	BLD		52.00	56.68	1.5	1.5	2.0	2.0	17.34	21.56	0.00	1.35	4.76		0.00	0.00
ELEVATOR CONSTRUCTOR	All	BLD		55.57	62.52	2.0	2.0	2.0	2.0	16.17	20.96	4.45	0.75			0.00	0.00
GLAZIER	All	BLD		49.75	51.25	1.5	2.0	2.0	2.0	15.44	25.36	0.00	2.07	0.00		0.00	0.00
HEAT/FROST INSULATOR	All	BLD		54.12	57.37	1.5	1.5	2.0	2.0	15.22	17.86	0.00	0.88			4.15	8.30
IRON WORKER	All	ALL		49.00	53.90	2.0	2.0	2.0	2.0	13.81	29.18	0.00	1.00	0.00		0.00	0.00
LABORER	All	ALL		48.90	49.65	1.5	1.5	2.0	2.0	17.37	15.91	0.00	0.91			0.00	0.00
LATHER	All	ALL		53.51	58.86	1.5	1.5	2.0	2.0	12.29	25.77	1.20	0.81			0.00	0.00
MACHINIST	All	BLD		55.74	59.74	1.5	1.5	2.0	2.0	9.93	8.95	1.85	1.47			0.00	0.00
MARBLE FINISHER	All	ALL		38.75	52.46	1.5	1.5	2.0	2.0	12.50	20.95	0.00	0.66	0.00		0.00	0.00
MARBLE SETTER	All	BLD		49.96	54.96	1.5	1.5	2.0	2.0	12.50	22.31	0.00	0.85	0.00		0.00	0.00
MATERIAL TESTER I	All	ALL		38.90		1.5	1.5	2.0	2.0	17.37	15.91	0.00	0.91			0.00	0.00
MATERIALS TESTER II	All	ALL		43.90		1.5	1.5	2.0	2.0	17.37	15.91	0.00	0.91			0.00	0.00
MILLWRIGHT	All	ALL		53.51	58.86	1.5	1.5	2.0	2.0	12.29	25.77	1.20	0.81			0.00	0.00
OPERATING ENGINEER	All	BLD	1	56.60	60.60	2.0	2.0	2.0	2.0	22.95	20.05	2.00	2.70			0.00	0.00

Grundy County Prevailing Wage Rates posted on 1/16/2024

OPERATING ENGINEER	All	BLD	2	55.30	60.60	2.0	2.0	2.0	2.0	2.0	2.0	22.95	20.05	2.00	2.70		0.00	0.00
OPERATING ENGINEER	All	BLD	3	52.75	60.60	2.0	2.0	2.0	2.0	2.0	2.0	22.95	20.05	2.00	2.70		0.00	0.00
OPERATING ENGINEER	All	BLD	4	51.00	60.60	2.0	2.0	2.0	2.0	2.0	2.0	22.95	20.05	2.00	2.70		0.00	0.00
OPERATING ENGINEER	All	BLD	5	60.35	60.60	2.0	2.0	2.0	2.0	2.0	2.0	22.95	20.05	2.00	2.70		0.00	0.00
OPERATING ENGINEER	All	BLD	6	57.60	60.60	2.0	2.0	2.0	2.0	2.0	2.0	22.95	20.05	2.00	2.70		0.00	0.00
OPERATING ENGINEER	All	BLD	7	59.60	60.60	2.0	2.0	2.0	2.0	2.0	2.0	22.95	20.05	2.00	2.70		0.00	0.00
OPERATING ENGINEER	All	HWY	1	54.80	58.80	1.5	1.5	2.0	2.0	2.0	2.0	22.95	20.05	2.00	2.70		0.00	0.00
OPERATING ENGINEER	All	HWY	2	54.25	58.80	1.5	1.5	2.0	2.0	2.0	2.0	22.95	20.05	2.00	2.70		0.00	0.00
OPERATING ENGINEER	All	HWY	3	52.20	58.80	1.5	1.5	2.0	2.0	2.0	2.0	22.95	20.05	2.00	2.70		0.00	0.00
OPERATING ENGINEER	All	HWY	4	50.80	58.80	1.5	1.5	2.0	2.0	2.0	2.0	22.95	20.05	2.00	2.70		0.00	0.00
OPERATING ENGINEER	All	HWY	5	49.60	58.80	1.5	1.5	2.0	2.0	2.0	2.0	22.95	20.05	2.00	2.70		0.00	0.00
OPERATING ENGINEER	All	HWY	6	57.80	58.80	1.5	1.5	2.0	2.0	2.0	2.0	22.95	20.05	2.00	2.70		0.00	0.00
OPERATING ENGINEER	All	HWY	7	55.80	58.80	1.5	1.5	2.0	2.0	2.0	2.0	22.95	20.05	2.00	2.70		0.00	0.00
PAINTER	All	ALL		51.55	57.99	1.5	1.5	1.5	2.0	2.0	15.69	14.76	15.69	0.00	1.86	0.00	0.00	0.00
PAINTER - SIGNS	All	BLD		45.49	51.09	1.5	1.5	2.0	2.0	2.0	8.20	16.81	0.00	0.00	0.00	0.00	0.00	0.00
PILEDRIVER	All	ALL		53.51	58.86	1.5	1.5	2.0	2.0	2.0	25.77	12.29	1.20	0.81		0.00	0.00	0.00
PIPEFITTER	All	BLD		55.00	58.00	1.5	1.5	2.0	2.0	2.0	22.85	12.65	0.00	3.12	0.00	0.00	0.00	0.00
PLASTERER	All	BLD		48.75	51.68	1.5	1.5	2.0	2.0	2.0	17.33	20.33	0.00	1.15	0.00	0.00	0.00	0.00
PLUMBER	All	BLD		56.80	60.20	1.5	1.5	2.0	2.0	2.0	17.00	17.29	0.00	1.73		0.00	0.00	0.00
ROOFER	All	BLD		38.00	40.00	1.5	1.5	2.0	2.0	2.0	11.83	13.76	0.00	0.64		0.00	0.00	0.00
SHEETMETAL WORKER	All	BLD		54.25	56.96	1.5	1.5	2.0	2.0	2.0	13.60	19.43	0.00	1.59	2.62	0.00	0.00	0.00
STONE MASON	All	BLD		50.81	55.89	1.5	1.5	2.0	2.0	2.0	12.50	23.01	0.00	1.16	0.00	0.00	0.00	0.00
TERRAZZO FINISHER	All	BLD		46.94	46.94	1.5	1.5	2.0	2.0	2.0	12.75	17.73	0.00	1.07	0.00	0.00	0.00	0.00
TERRAZZO MECHANIC	All	BLD		50.85	54.35	1.5	1.5	2.0	2.0	2.0	12.75	19.12	0.00	1.10	0.00	0.00	0.00	0.00
TRUCK DRIVER	All	ALL	1	43.70	44.25	1.5	1.5	2.0	2.0	2.0	11.15	13.26	0.00	0.15	0.00	0.00	0.00	0.00
TRUCK DRIVER	All	ALL	2	43.85	44.25	1.5	1.5	2.0	2.0	2.0	11.15	13.26	0.00	0.15	0.00	0.00	0.00	0.00
TRUCK DRIVER	All	ALL	3	44.05	44.25	1.5	1.5	2.0	2.0	2.0	11.15	13.26	0.00	0.15	0.00	0.00	0.00	0.00
TRUCK DRIVER	All	ALL	4	44.25	44.25	1.5	1.5	2.0	2.0	2.0	11.15	13.26	0.00	0.15	0.00	0.00	0.00	0.00
TUCKPOINTER	All	BLD		50.53	51.53	1.5	1.5	2.0	2.0	2.0	9.55	21.72	0.00	1.11	0.00	0.00	0.00	0.00

Grundy County Prevailing Wage Rates posted on 1/16/2024

Legend

Rg Region

Type Trade Type - All,Highway,Building,Floating,Oil & Chip,Rivers

C Class

Base Base Wage Rate

OT M-F Unless otherwise noted, OT pay is required for any hour greater than 8 worked each day, Mon through Fri. The number listed is the multiple of the base wage.

OT Sa Overtime pay required for every hour worked on Saturdays

OT Su Overtime pay required for every hour worked on Sundays

OT Hol Overtime pay required for every hour worked on Holidays

H/W Health/Welfare benefit

Vac Vacation

Trng Training

Other Ins Employer hourly cost for any other type(s) of insurance provided for benefit of worker.

Explanations GRUNDY COUNTY

PLUMBERS & PIPEFITTERS (WEST) - That part of the county West of Rt. 47 excluding the City of Morris.

The following list is considered as those days for which holiday rates of wages for work performed apply: New Years Day, Memorial Day, Fourth of July, Labor Day, Thanksgiving Day, Christmas Day and Veterans Day in some classifications/counties. Generally, any of these holidays which fall on a Sunday is celebrated on the following Monday. This then makes work performed on that Monday payable at the appropriate overtime rate for holiday pay. Common practice in a given local may alter certain days of celebration. If in doubt, please check with IDOL.

EXPLANATION OF CLASSES

ASBESTOS - GENERAL - removal of asbestos material/mold and hazardous materials from any place in a building, including mechanical systems where those mechanical systems are to be removed. This includes the removal of asbestos materials/mold and hazardous materials from ductwork or pipes in a building when the building is to be demolished at the time or at some close future date.

ASBESTOS - MECHANICAL - removal of asbestos material from mechanical systems, such as pipes, ducts, and boilers, where the mechanical systems are to remain.

CERAMIC TILE FINISHER

The grouting, cleaning, and polishing of all classes of tile, whether for interior or exterior purposes, all burned, glazed or unglazed products; all composition materials, granite tiles, warning detectable tiles, cement tiles, epoxy composite materials, pavers, glass, mosaics, fiberglass, and all substitute materials, for tile made in tile-like units; all mixtures in tile like form of cement, metals, and other materials that are for and intended for use as a finished floor surface, stair treads, promenade roofs, walks, walls, ceilings,

Grundy County Prevailing Wage Rates posted on 1/16/2024

swimming pools, and all other places where tile is to form a finished interior or exterior. The mixing of all setting mortars including but not limited to thin-set mortars, epoxies, wall mud, and any other sand and cement mixtures or adhesives when used in the preparation, installation, repair, or maintenance of tile and/or similar materials. The handling and unloading of all sand, cement, lime, tile, fixtures, equipment, adhesives, or any other materials to be used in the preparation, installation, repair, or maintenance of tile and/or similar materials. Ceramic Tile Finishers shall fill all joints and voids regardless of method on all tile work, particularly and especially after installation of said tile work. Application of any and all protective coverings to all types of tile installations including, but not be limited to, all soap compounds, paper products, tapes, and all polyethylene coverings, plywood, masonite, cardboard, and any new type of products that may be used to protect tile installations. Blastac equipment, and all floor scarifying equipment used in preparing floors to receive tile. The clean up and removal of all waste and materials. All demolition of existing tile floors and walls to be re-tiled.

COMMUNICATIONS TECHNICIAN

Installation, operation, inspection, maintenance, repair and service of radio, television, recording, voice, sound and vision production and reproduction, telephone and telephone interconnect, facsimile, equipment and appliances used for domestic, commercial, educational and entertainment purposes, pulling of wire through conduit but not the installation of conduit.

MARBLE FINISHER

Loading and unloading trucks, distribution of all materials (all stone, sand, etc.), stocking of floors with material, performing all rigging for heavy work, the handling of all material that may be needed for the installation of such materials, building of scaffolding, polishing if needed, patching, waxing of material if damaged, pointing up, caulking, grouting and cleaning of marble, holding water on diamond or Carborundum blade or saw for setters cutting, use of tub saw or any other saw needed for preparation of material, drilling of holes for wires that anchor material set by setters, mixing up of molding plaster for installation of material, mixing up thin set for the installation of material, mixing up of sand to cement for the installation of material and such other work as may be required in helping a Marble Setter in the handling of all material in the erection or installation of interior marble, slate, travertine, art marble, serpentine, alberene stone, blue stone, granite and other stones (meaning as to stone any foreign or domestic materials as are specified and used in building interiors and exteriors and customarily known as stone in the trade), carrara, sanionyx, vitrolite and similar opaque glass and the laying of all marble tile, terrazzo tile, slate tile and precast tile, steps, risers treads, base, or any other materials that may be used as substitutes for any of the aforementioned materials and which are used on interior and exterior which are installed in a similar manner.

MATERIAL TESTER I: Hand coring and drilling for testing of materials; field inspection of uncured concrete and asphalt.

MATERIAL TESTER II: Field inspection of welds, structural steel, fireproofing, masonry, soil, facade, reinforcing steel, formwork, cured concrete, and concrete and asphalt batch plants; adjusting proportions of bituminous mixtures.

OPERATING ENGINEER - BUILDING

Class 1. Asphalt Plant; Asphalt Spreader; Autograde; Backhoes with Caisson Attachment; Batch Plant; Benoto (requires Two Engineers); Boiler and Throttle Valve; Caisson Rigs; Central Redi-Mix Plant; Combination Back Hoe Front End-loader Machine; Compressor and Throttle Valve; Concrete Breaker (Truck Mounted); Concrete Conveyor; Concrete Conveyor (Truck Mounted);

Grundy County Prevailing Wage Rates posted on 1/16/2024

Concrete Paver Over 27E cu. ft.; Concrete Paver 27E cu. ft. and Under; Concrete Placer; Concrete Placing Boom; Concrete Pump (Truck Mounted); Concrete Tower; Cranes, All; Cranes, Hammerhead; Cranes, (GCI and similar Type); Creter Crane; Spider Crane; Crusher, Stone, etc.; Derricks, All; Derricks, Traveling; Formless Curb and Gutter Machine; Grader, Elevating; Grouting Machines; Heavy Duty Self-Propelled Transporter or Prime Mover; Hightift Shovels or Front Endloader 2-1/4 yd. and over; Hoists, Elevators, outside type rack and pinion and similar machines; Hoists, One, Two and Three Drum, Hoists, Two Tugger One Floor; Hydraulic Backhoes; Hydraulic Boom Trucks; Hydro Vac (and similar equipment); Locomotives, All; Motor Patrol; Lubrication Technician; Manipulators; Pile Drivers and Skid Rig; Post Hole Digger; Pre-Stress Machine; Pump Cretes Dual Ram; Pump Cretes: Squeeze Cretes-Screw Type Pumps; Gypsum Bulker and Pump; Raised and Blind Hole Drill; Roto Mill Grinder; Scoops - Tractor Drawn; Slip-Form Paver; Straddle Buggies; Operation of Tie Back Machine; Tournapull; Tractor with Boom and Side Boom; Trenching Machines.

Class 2. Boilers; Broom, All Power Propelled; Bulldozers; Concrete Mixer (Two Bag and Over); Conveyor, Portable; Forklift Trucks; Hightift Shovels or Front Endloaders under 2-1/4 yd.; Hoists, Automatic; Hoists, Inside Elevators; Hoists, Sewer Dragging Machine; Hoists, Tugger Single Drum; Laser Screed; Rock Drill (Self-Propelled); Rock Drill (Truck Mounted); Rollers, All; Steam Generators; Tractors, All; Tractor Drawn Vibratory Roller; Winch Trucks with "A" Frame.

Class 3. Air Compressor; Combination Small Equipment Operator; Generators; Heaters, Mechanical; Hoists, Inside Elevators (remodeling or renovation work); Hydraulic Power Units (Pile Driving, Extracting, and Drilling); Pumps, over 3" (1 to 3 not to exceed a total of 300 ft.); Low Boys; Pumps, Well Points; Welding Machines (2 through 5); Winches, 4 Small Electric Drill Winches.

Class 4. Bobcats and/or other Skid Steer Loaders; Oilers; and Brick Forklift.

Class 5. Assistant Craft Foreman.

Class 6. Gradall.

Class 7. Mechanics; Welders.

OPERATING ENGINEERS - HIGHWAY CONSTRUCTION

Class 1. Asphalt Plant; Asphalt Heater and Planer Combination; Asphalt Heater Scarfire; Asphalt Spreader; Autograder/GOMACO or other similar type machines; ABG Paver; Backhoes with Caisson Attachment; Ballast Regulator; Belt Loader; Caisson Rigs; Car Dumper; Central Redi-Mix Plant; Combination Backhoe Front Endloader Machine; (1 cu. yd. Backhoe Bucket or over or with attachments); Concrete Breaker (Truck Mounted); Concrete Conveyor; Concrete Paver over 27E cu. ft.; Concrete Placer; Concrete Tube Float; Cranes, all attachments; Cranes, Tower Cranes of all types; Creter Crane; Spider Crane; Crusher, Stone, etc.; Derricks, All; Derrick Boats; Derricks, Traveling; Dredges; Elevators, Outside type Rack & Pinion and Similar Machines; Formless Curb and Gutter Machine; Grader, Elevating; Grader, Motor Grader, Motor Patrol, Auto Patrol, Form Grader, Pull Grader, Subgrader; Guard Rail Post Driver Truck Mounted; Hoists, One, Two and Three Drum; Heavy Duty Self-Propelled Transporter or Prime Mover; Hydraulic Backhoes; Backhoes with shear attachments up to 40' of boom reach; Lubrication Technician; Manipulators; Mucking Machine; Pile Drivers and Skid Rig; Pre-Stress Machine; Pump Cretes Dual Ram; Rock Drill - Crawler or Skid Rig; Rock Drill - Truck Mounted; Rock/Track Tamper; Roto Mill Grinder; Slip-Form Paver; Snow Melters; Soil Test Drill Rig (Truck Mounted); Straddle Buggies; Hydraulic Telescoping Form (Tunnel); Operation of Tieback Machine; Tractor Drawn Belt Loader; Tractor Drawn Belt

Grundy County Prevailing Wage Rates posted on 1/16/2024

Loader (with attached pusher - two engineers); Tractor with Boom; Tractaire with Attachments; Traffic Barrier Transfer Machine; Trenching; Truck Mounted Concrete Pump with Boom; Raised or Blind Hole Drills (Tunnel Shaft); Underground Boring and/or Mining Machines 5 ft. in diameter and over tunnel, etc; Underground Boring and/or Mining Machines under 5 ft. in diameter; Wheel Excavator; Widener (APSCO).

Class 2. Batch Plant; Bituminous Mixer; Boiler and Throttle Valve; Bulldozers; Car Loader Trailing Conveyors; Combination Backhoe Front Endloader Machine (Less than 1 cu. yd. Backhoe Bucket or over or with attachments); Compressor and Throttle Valve; Compressor, Common Receiver (3); Concrete Breaker or Hydro Hammer; Concrete Grinding Machine; Concrete Mixer or Paver 75 Series to and including 27 cu. ft.; Concrete Spreader; Concrete Curing Machine, Burlap Machine, Belting Machine and Sealing Machine; Concrete Wheel Saw, Conveyor Muck Cars (Haglund or Similar Type); Drills, All; Finishing Machine - Concrete; Highlift Shovels or Front Endloader; Hoist - Sewer Dragging Machine; Hydraulic Boom Trucks (All Attachments); Hydro-Blaster; Hydro Excavating (excluding hose work); Laser Screed; All Locomotives, Dinky; Off-Road Hauling Units (including articulating) Non Self-Loading Ejection Dump; Pump Cretes; Squeeze Cretes - Screw Type Pumps, Gypsum Bulker and Pump; Roller, Asphalt; Rotary Snow Plows; Rototiller, Seaman, etc, self-propelled; Self-Propelled Compactor; Spreader - Chip - Stone, etc.; Scraper - Single/Twin Engine/Push and Pull; Scraper - Prime Mover in Tandem (Regardless of Size); Tractors pulling attachments, Sheeps Foot, Disc, Compactor, etc.; Tug Boats.

Class 3. Boilers; Brooms, All Power Propelled; Cement Supply Tender; Compressor, Common Receiver (2); Concrete Mixer (Two Bag and Over); Conveyor, Portable, Farm-Type Tractors Used for Mowing, Seeding, etc.; Forklift Trucks; Grouting Machine; Hoists, Automatic; Hoists, All Elevators; Hoists, Tugger Single Drum; Jeep Diggers; Low Boys; Pipe Jacking Machines; Post-Hole Digger; Power Saw, Concrete Power Driven; Pug Mills; Rollers, other than Asphalt; Seed and Straw Blower; Steam Generators; Stump Machine; Winch Trucks with "A" Frame; Work Boats; Tamper-Form-Motor Driven.

Class 4. Air Compressor; Combination - Small Equipment Operator; Directional Boring Machine; Generators; Heaters, Mechanical; Hydraulic Power Unit (Pile Driving, Extracting, or Drilling); Light Plants, All (1 through 5); Pumps, over 3" (1 to 3 not to exceed a total of 300 ft.); Pumps, Well Points; Vacuum Trucks (excluding hose work); Welding Machines (2 through 5); Winches, 4 Small Electric Drill Winches.

Class 5. SkidSteer Loader (all); Brick Forklifts; Oilers.

Class 6. Field Mechanics and Field Welders

Class 7. Dowell Machine with Air Compressor; Gradall and machines of like nature.

OPERATING ENGINEERS - FLOATING

Diver. Diver Wet Tender, Diver Tender, ROV Pilot, ROV Tender

TRUCK DRIVER - BUILDING, HEAVY AND HIGHWAY CONSTRUCTION Class 1. Two or three Axle Trucks. A-frame Truck when used for transportation purposes; Air Compressors and Welding Machines, including those pulled by cars, pick-up trucks and tractors; Ambulances; Batch Gate Lockers; Batch Hopperman; Car and Truck Washers; Carry-alls; Fork Lifts and Hoisters; Helpers; Mechanics Helpers and Greasers; Oil Distributors 2-man operation; Pavement Breakers; Pole Trailer, up to 40 feet; Power Mower

Grundy County Prevailing Wage Rates posted on 1/16/2024

Tractors; Self-propelled Chip Spreader; Skipman; Slurry Trucks, 2-man operation; Slurry Truck Conveyor Operation, 2 or 3 man; Teamsters Unskilled dumpman; and Truck Drivers hauling warning lights, barricades, and portable toilets on the job site.

Class 2. Four axle trucks; Dump Crets and Adgetors under 7 yards; Dumpsters, Track Trucks, Euclids, Hug Bottom Dump Turnapulls or Turnatraliers when pulling other than self-loading equipment or similar equipment under 16 cubic yards; Mixer Trucks under 7 yards; Ready-mix Plant Hopper Operator, and Winch Trucks, 2 Axles.

Class 3. Five axle trucks; Dump Crets and Adgetors 7 yards and over; Dumpsters, Track Trucks, Euclids, Hug Bottom Dump Turnatraliers or turnapulls when pulling other than self-loading equipment or similar equipment over 16 cubic yards; Explosives and/or Fission Material Trucks; Mixer Trucks 7 yards or over; Mobile Cranes while in transit; Oil Distributors, 1-man operation; Pole Trailer, over 40 feet; Pole and Expandable Trailers hauling material over 50 feet long; Slurry trucks, 1-man operation; Winch trucks, 3 axles or more; Mechanic--Truck Welder and Truck Painter.

Class 4. Six axle trucks; Dual-purpose vehicles, such as mounted crane trucks with hoist and accessories; Foreman; Master Mechanic; Self-loading equipment like P.B. and trucks with scoops on the front.

TERRAZZO FINISHER

The handling of sand, cement, marble chips, and all other materials that may be used by the Mosaic Terrazzo Mechanic, and the mixing, grinding, grouting, cleaning and sealing of all Marble, Mosaic, and Terrazzo work, floors, base, stairs, and wainscoting by hand or machine, and in addition, assisting and aiding Marble, Masonic, and Terrazzo Mechanics.

Other Classifications of Work:

For definitions of classifications not otherwise set out, the Department generally has on file such definitions which are available. If a task to be performed is not subject to one of the classifications of pay set out, the Department will upon being contacted state which neighboring county has such a classification and provide such rate, such rate being deemed to exist by reference in this document. If no neighboring county rate applies to the task, the Department shall undertake a special determination, such special determination being then deemed to have existed under this determination. If a project requires these, or any classification not listed, please contact IDOL at 217-782-1710 for wage rates or clarifications.

LANDSCAPING

Landscaping work falls under the existing classifications for laborer, operating engineer and truck driver. The work performed by landscape plantsman and landscape laborer is covered by the existing classification of laborer. The work performed by landscape operators (regardless of equipment used or its size) is covered by the classifications of operating engineer. The work performed by landscape truck drivers (regardless of size of truck driven) is covered by the classifications of truck driver.

MATERIAL TESTER & MATERIAL TESTER/INSPECTOR I AND II

Notwithstanding the difference in the classification title, the classification entitled "Material Tester I" involves the same job duties as the classification entitled "Material Tester/Inspector I". Likewise, the classification entitled "Material Tester II" involves the same job duties as the classification entitled "Material Tester/Inspector II".

Not
For
Bid

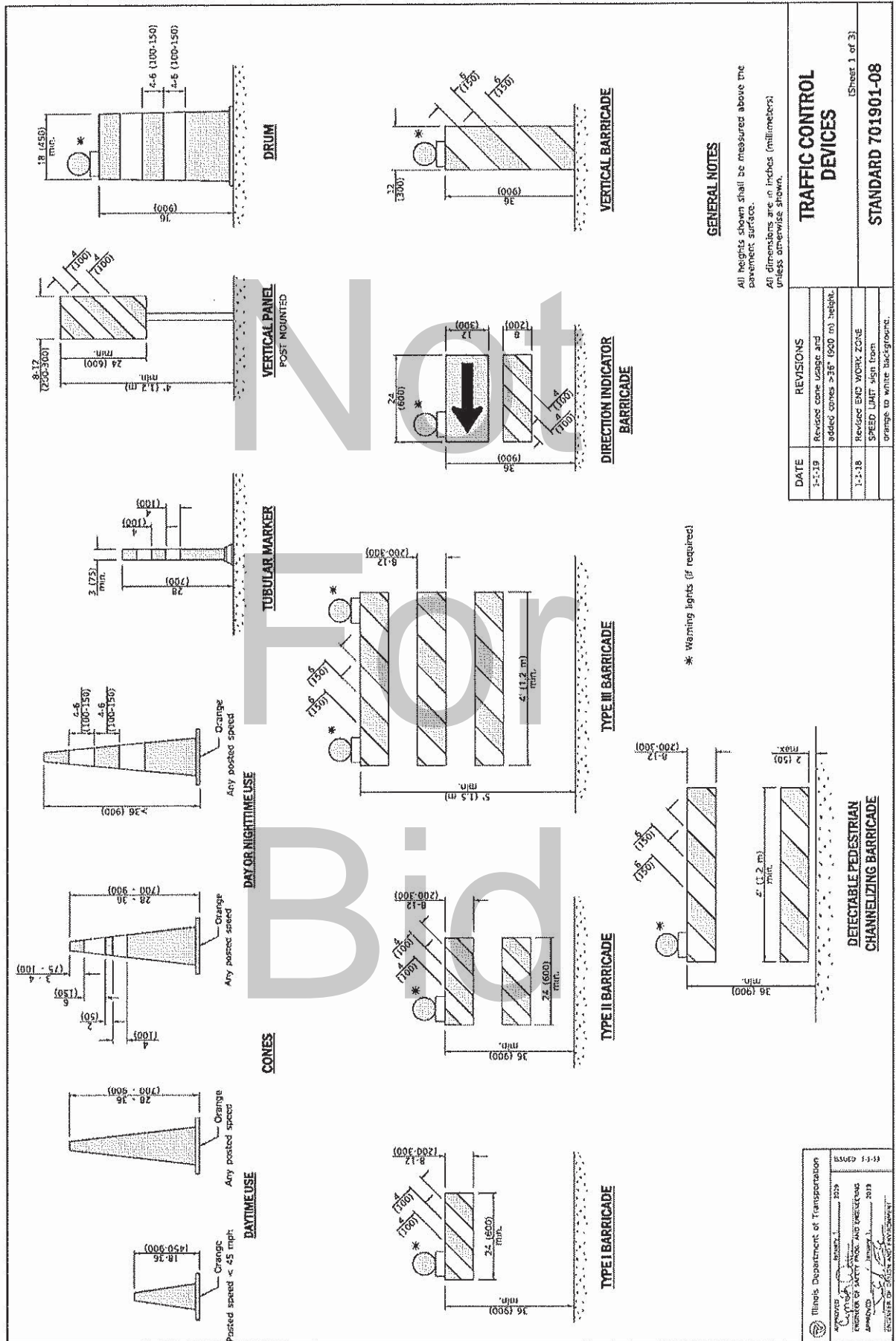

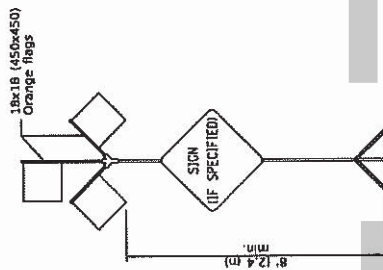
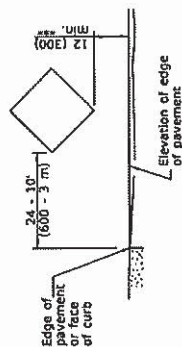
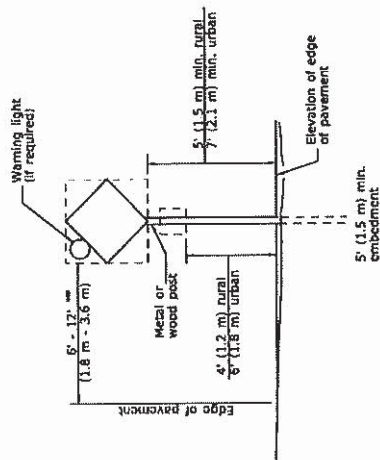

POST MOUNTED SIGNS

When curb or paved shoulder are present this dimension shall be 24 (600) to the face of curb or 6' (1.8 m) to the outside edge of the paved shoulder.

SIGNS ON TEMPORARY SUPPORTS

When work operations exceed four days, this dimension shall be 5' (1.5 m) min. If located behind other devices, the height shall be sufficient to be seen completely above the devices.

HIGH LEVEL WARNING DEVICE

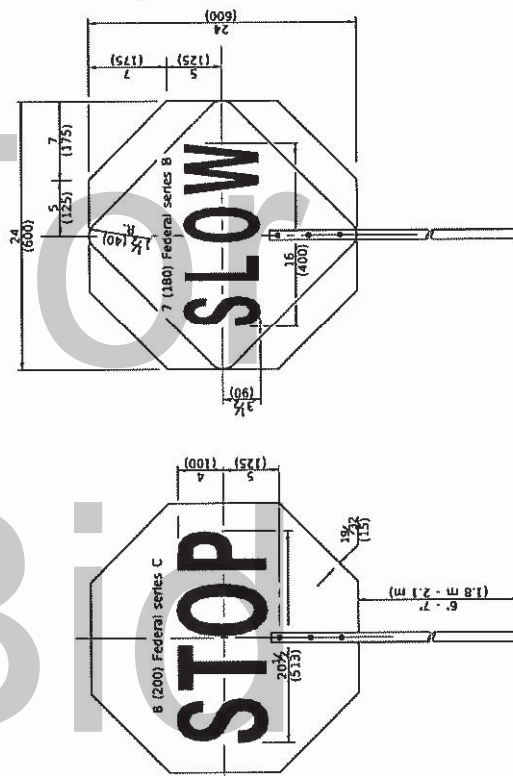

W12-1103-4848

WIDTH RESTRICTION SIGN

XX'-XX" width and X miles are variable.

ROAD
CONSTRUCTION
NEXT X MILES
G20-1104(0)-6036

END
CONSTRUCTION
G20-1305(0)-6024

This signing is required for all projects 2 miles (3200 m) or more in length.

ROAD CONSTRUCTION NEXT X MILES sign shall be placed 500' (150 m) in advance of project limits.

END CONSTRUCTION sign shall be erected at the end of the job unless another job is within 2 miles (3200 m).

Dual sign displays shall be utilized on multi-lane highways.

WORK LIMIT SIGNING

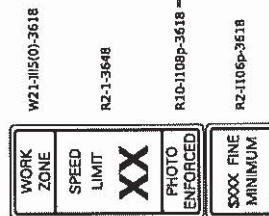

Sign assembly as shown on Standards
or as allowed by District Operations.



This sign shall be used when the above sign assembly is used.

**HIGHWAY CONSTRUCTION
SPEED ZONE SIGNS**

§ 110-108p shall only be used along roadways under the jurisdiction of the State.

TRAFFIC CONTROL DEVICES

(Sheet 2 of 3)

STANDARD 701901-08

FLAGGER TRAFFIC CONTROL SIGN

Illinois Department of Transportation

ISSUED 1-1-13

APPROVED January 1, 2018
Cynthia D. Riddle
ENGINEER OF SAFETY PROG. AND ENGINEERING

APPROVED January 2, 2018
Seth E. Eise
[Signature]

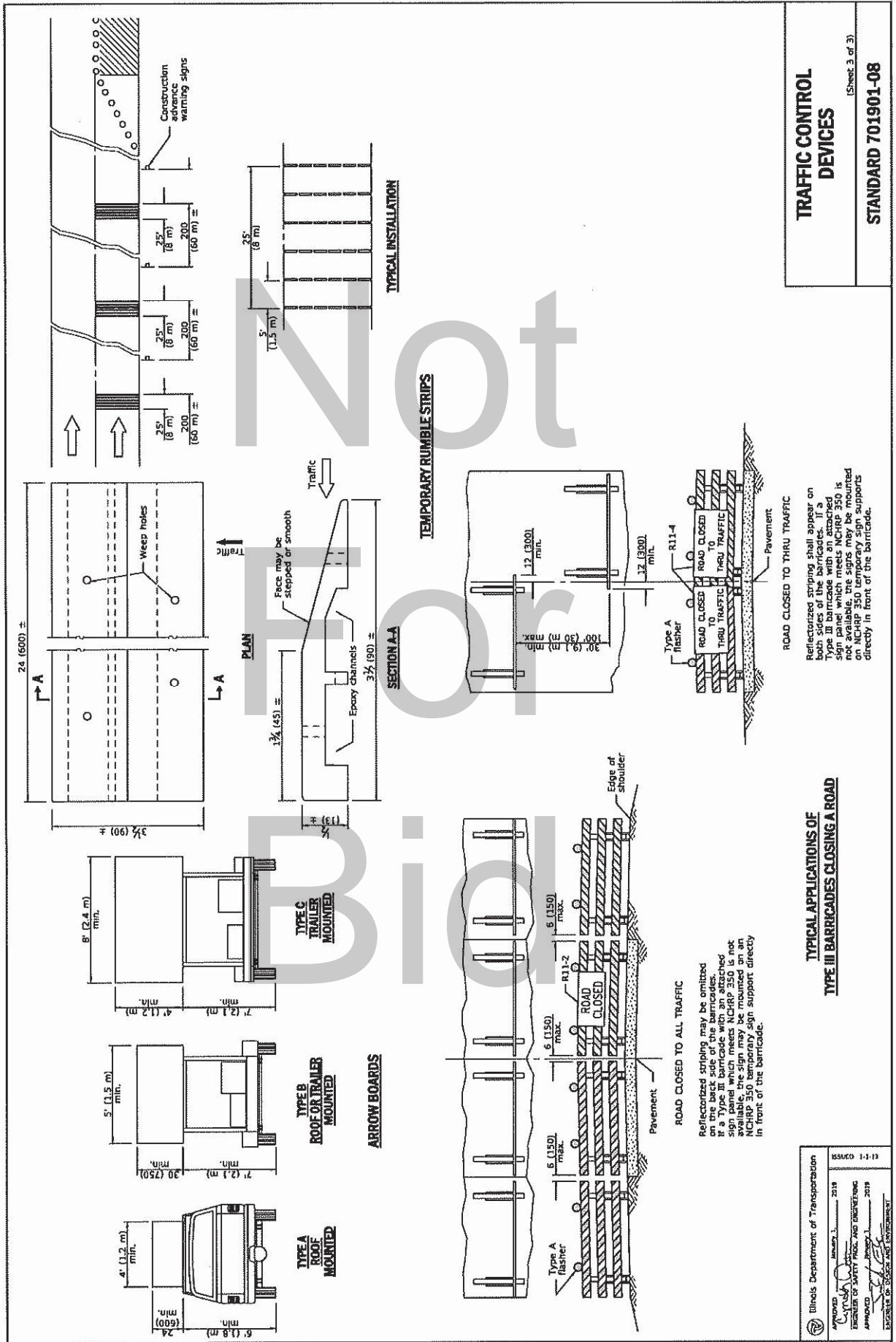

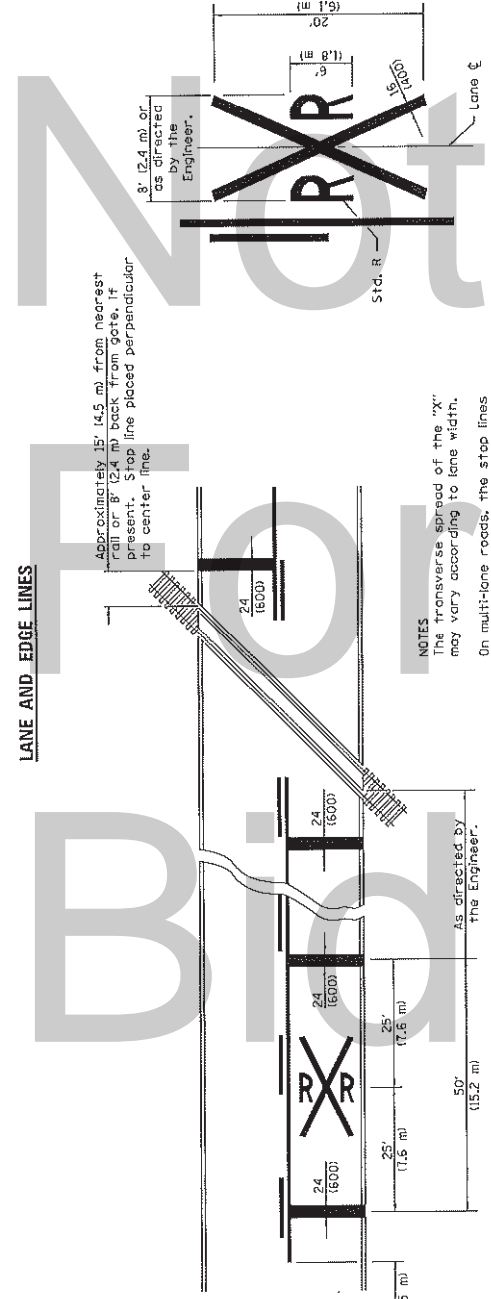
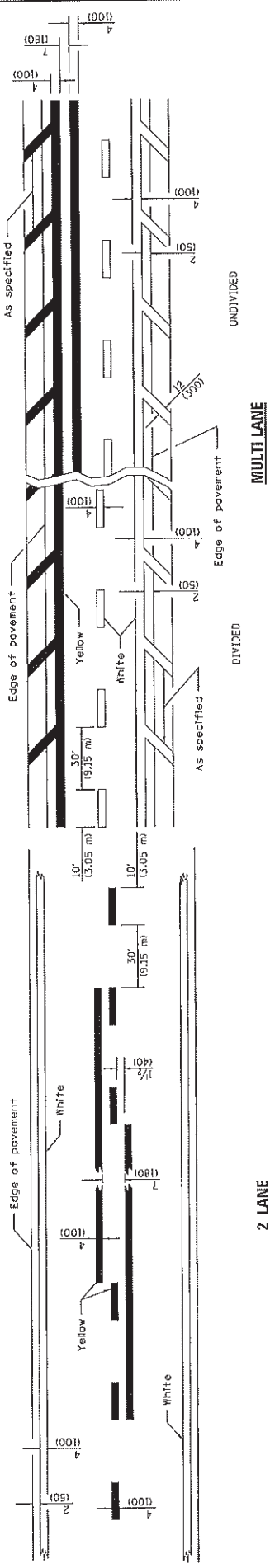

NOTES
 The transverse spread of the "X" may vary according to lane width.
 On multi-lane roads, the stop lines shall extend across all approach lanes and separate RRR symbols shall be placed adjacent to each other in each lane.
 When the pavement marking symbol is used, a portion of the symbol shall be located directly adjacent to the Advance Warning Sign (W10-1) as placed by Table 2C-4, Condition B of the MUTCD.

PAVEMENT MARKINGS AT RAILROAD-HIGHWAY GRADE CROSSING		TYPICAL PAVEMENT MARKINGS	
DATE	REVISIONS	DATE	REVISIONS
1-1-15	Added symbols. Revised bike symbol. Revised note for stop line at RR crossing.	1-1-15	Added symbols. Revised bike symbol. Revised note for stop line at RR crossing.
1-1-14	Added bike symbol. Renamed "LANE DROP ARROW" detail to "LANE-REDUCTION ARROW".	1-1-14	Added bike symbol. Renamed "LANE DROP ARROW" detail to "LANE-REDUCTION ARROW".

Illinois Department of Transportation
 APPROVED January 1, 2015
 ENGINEER OF OPERATIONS
 APPROVED January 1, 2015
 ENGINEER OF DESIGN AND ENVIRONMENT

STANDARD 780001-05
 (Sheet 1 of 3)

All dimensions are in inches (millimeters) unless otherwise shown.

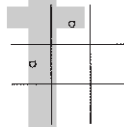
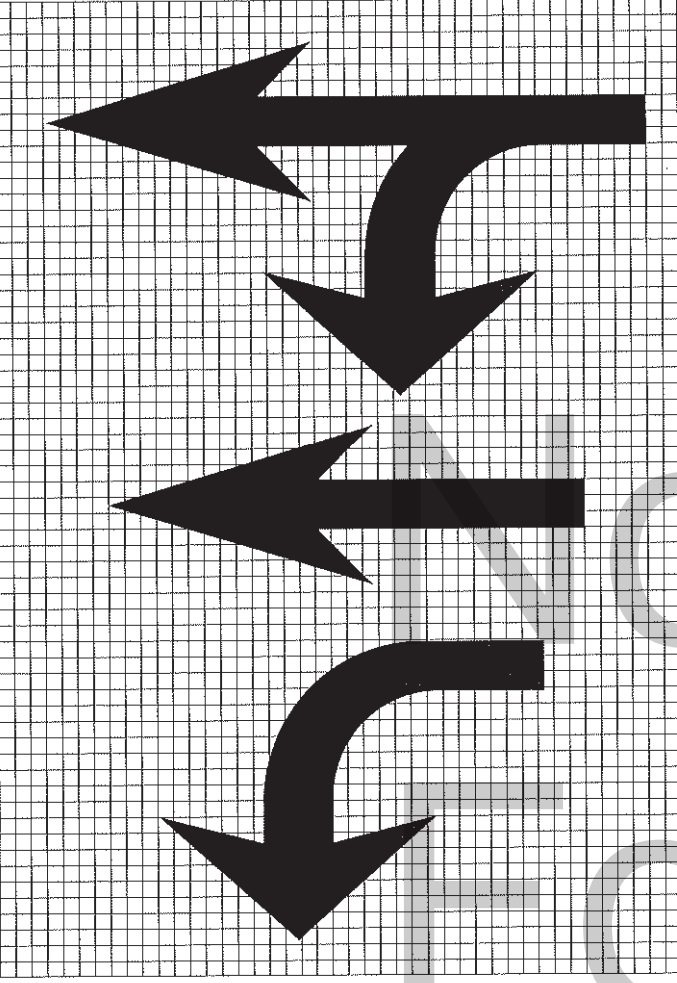
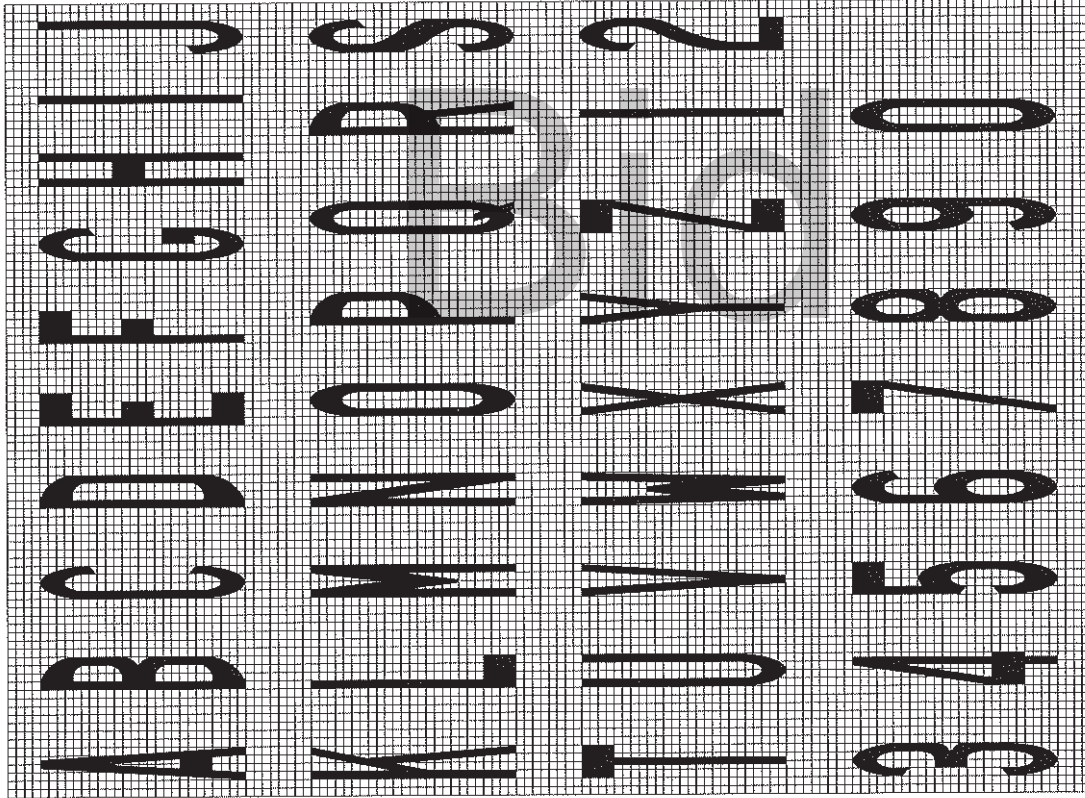

Legend Height	Arrow Size	a
5' (1.8 m)	Small	2.9 (74)
8' (2.4 m)	Large	3.8 (96)

The space between adjacent letters or numerals should be approximately 3 (75) for 5' (1.8 m) legend and 4 (100) for 8' (2.4 m) legend.

LETTER AND ARROW GRID SCALE

TYPICAL PAVEMENT
MARKINGS

STANDARD 780001-05

Illinois Department of Transportation

ISSUED 1-1-97

APPROVED

DESIGNED BY L. 2015

ENGINEER OF OPERATIONS

APPROVED

ENGINEER OF DESIGN AND ENVIRONMENT

DESIGNED BY L. 2015

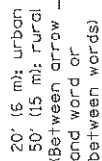
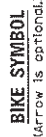

Right lane-reduction arrow shown.
Use mirror image for left lane.



TYPICAL PAVEMENT MARKINGS

(Sheet 3 of 3)

STANDARD 780001-05

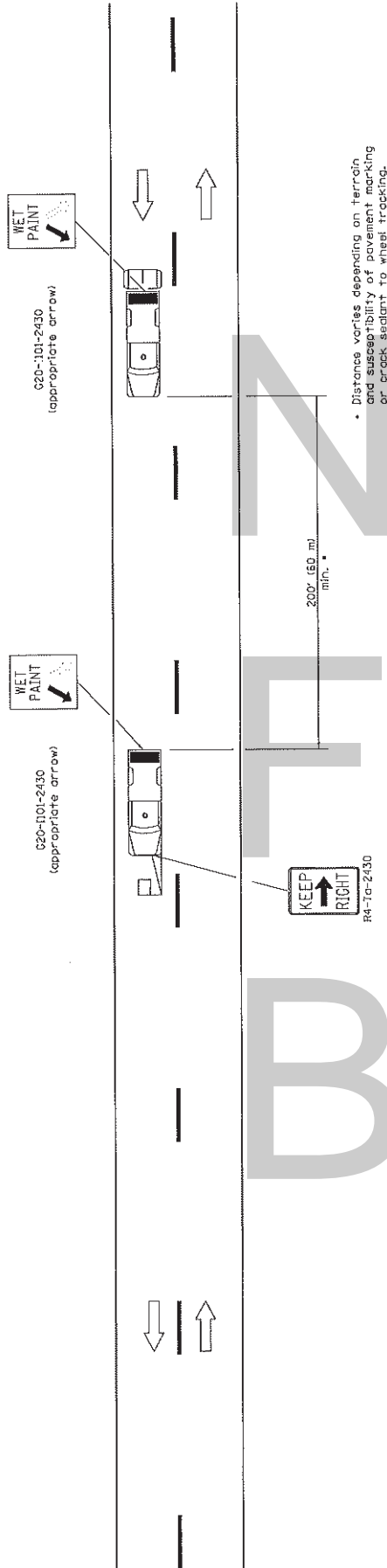

TYPICAL APPLICATIONS

- Landscaping work
- Utility work
- Pavement marking
- Weed spraying
- Roadmeter measurements
- Debris cleanup
- Crack pouring

SYMBOLS

Arrow board (Hazard Mode only)
Truck with headlights, emergency flashers and flashing amber light. (Visible from all directions)
18x18 (450x450) min. orange flag use when guide wheel is used
Truck mounted attenuator

GENERAL NOTES

This Standard is used where any vehicle, equipment, workers or their activities will require a continuous moving operation where the average speed is greater than 3 mph (5 km/h).

For shoulder operations not encroaching on the pavement, use DETAIL A, Standard 701426. All dimensions are in inches (millimeters) unless otherwise shown.

DATE	REVISIONS	LANE CLOSURE 2L 2W MOVING OPERATIONS— DAY ONLY
1-1-09	Switched units to English metric. Omitted Pass with Core sign.	STANDARD 701311-03
1-1-00	Elim. speed restrictions in Standard title.	

Illinois Department of Transportation		ISSUED 1-1-97
APPROVED	JANUARY 1, 2009	
ENGINEER OF OPERATIONS		
APPROVED	JANUARY 1, 2009	
ENGINEER OF DESIGN AND ENVIRONMENT		



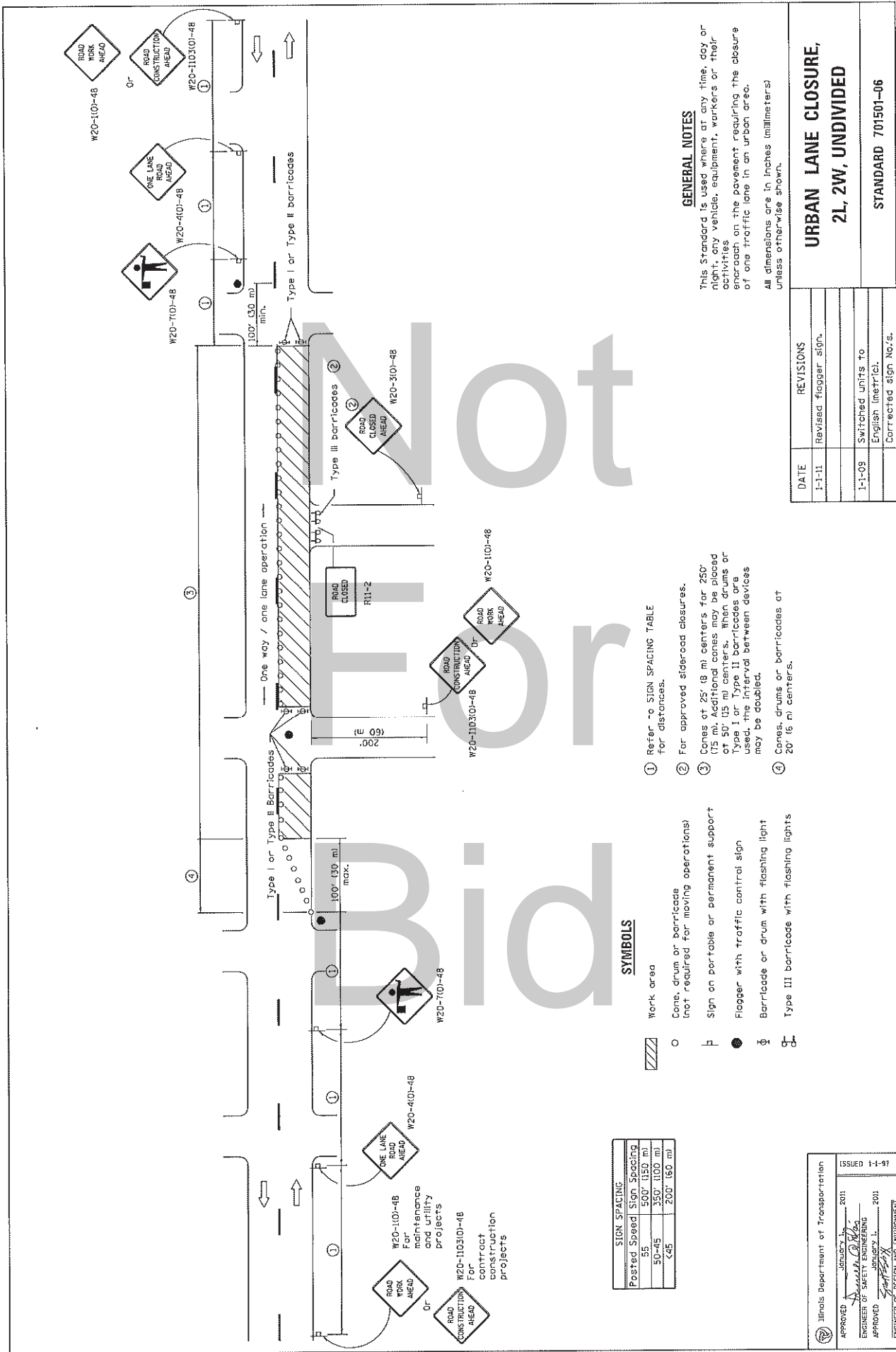

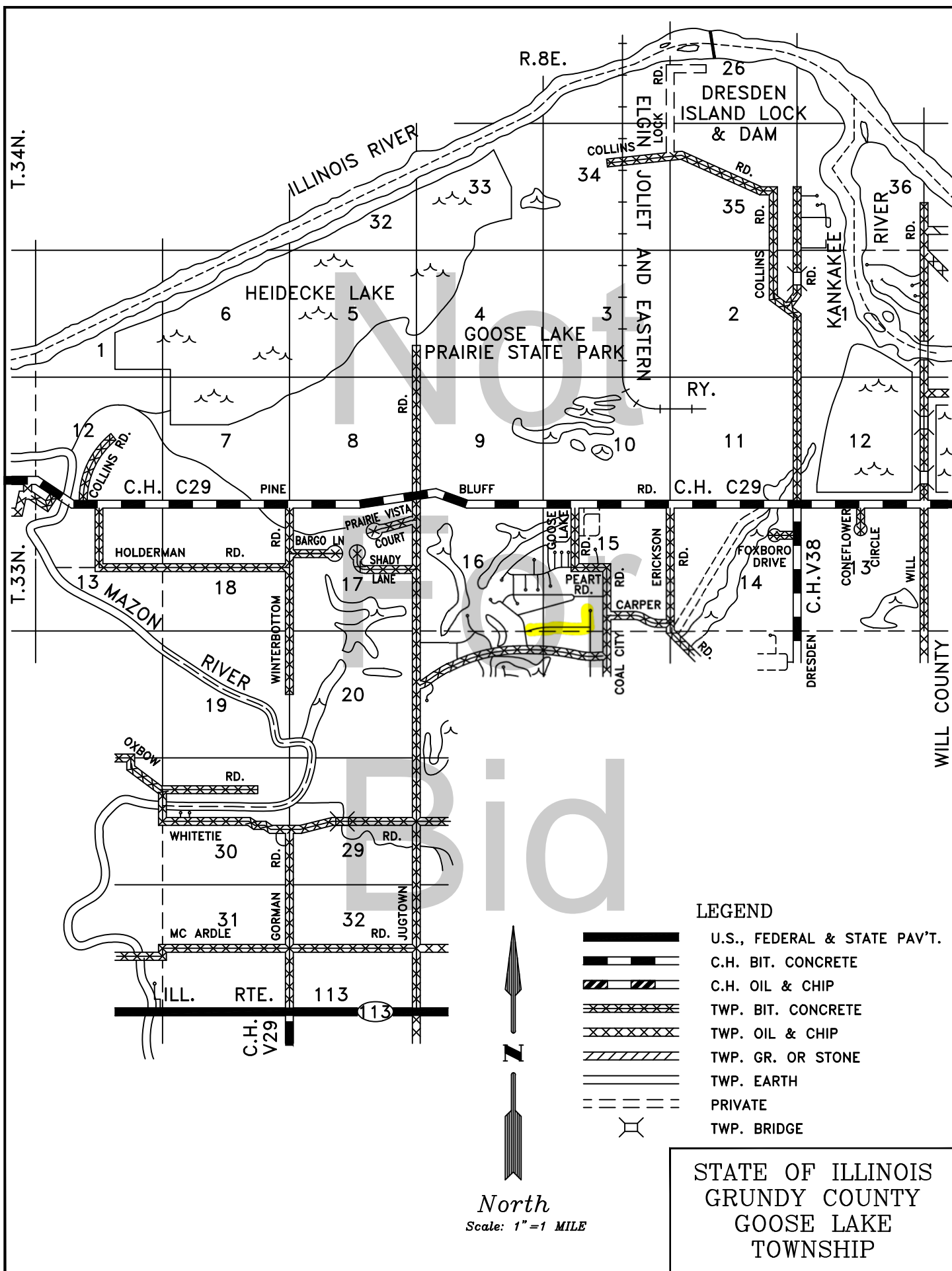

Department of Transportation

Bureau of Local Roads and Streets

Plans for Proposed

Road District Improvement

Scales { Plan 1 inch = Ft.
Profile, Horizontal 1 inch = Ft.
Profile, Vertical 1 inch = Ft.

LOCATIONS
Hilltop Dr: Lakeside Dr. to
Lincoln Lake Dr.

Lincoln Lake Dr: Hilltop Dr. to
Cul de Sac

County Grundy
Road District Goose Lake Township
Section 24 - 07 000 - 00 - GM, Group IV

Typical Cross Section

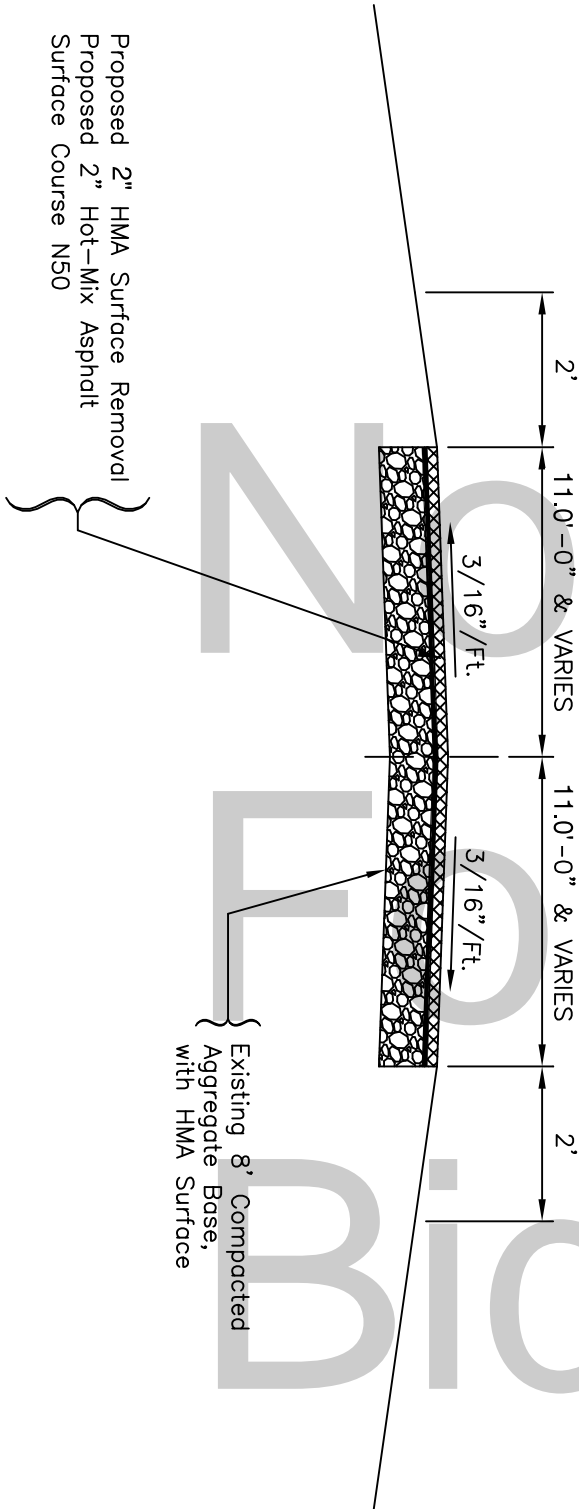

PG Grade For Hot-Mix Asphalt

Mix	PG Grade
Level Binder	64 - 22
Binder Course	64 - 22
Surface Course	64 - 22
Patching	64 - 22
Base Course and Widening	64 - 22

* See Proposal for Specifications

Proposed 2" HMA Surface Removal
Proposed 2" Hot-Mix Asphalt
Surface Course N50

Approved _____, 2024

District/Regional Engineer

Submitted _____, 2024

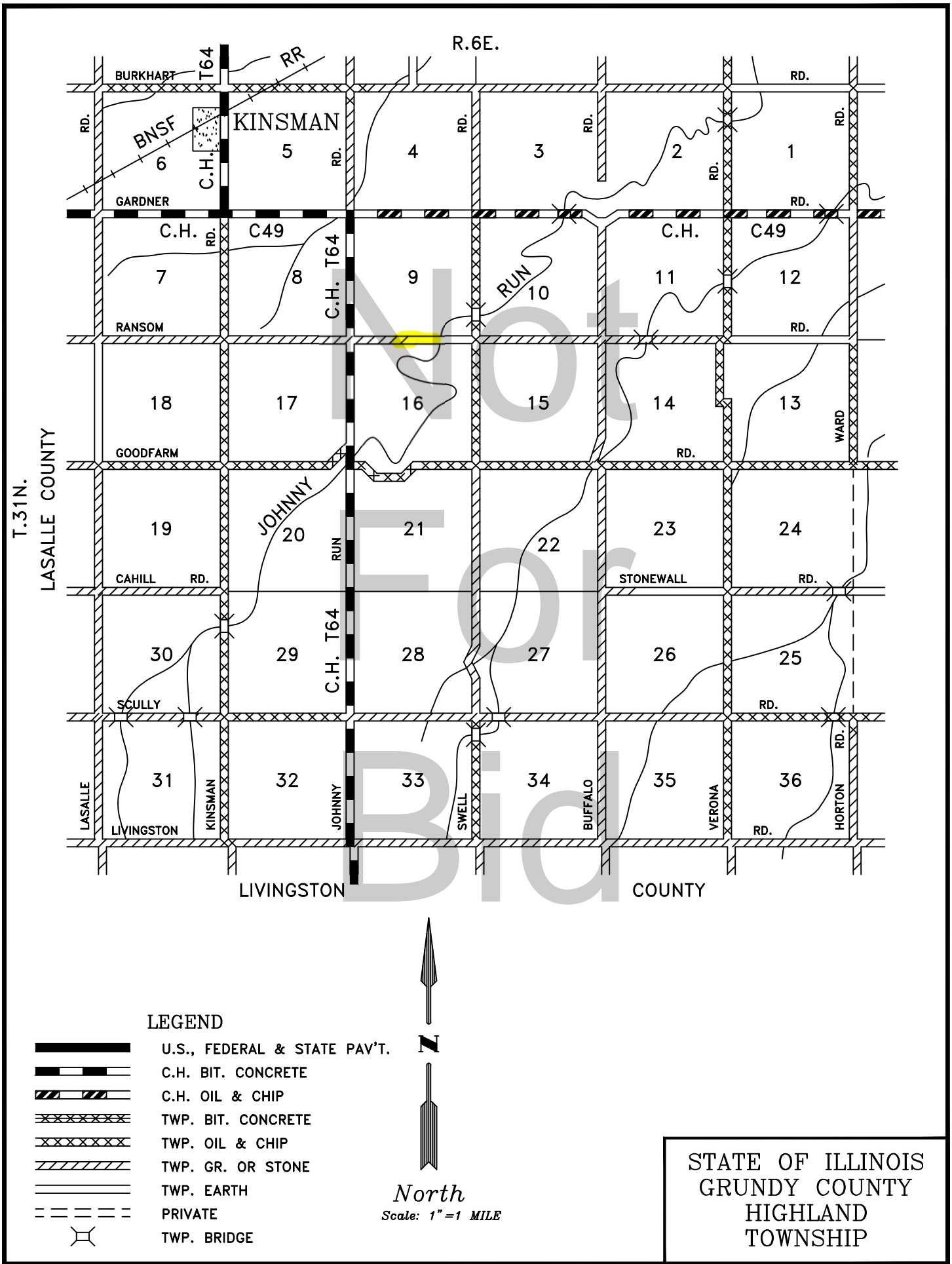

Braceville Township Highway Commissioner

Grundy County Engineer

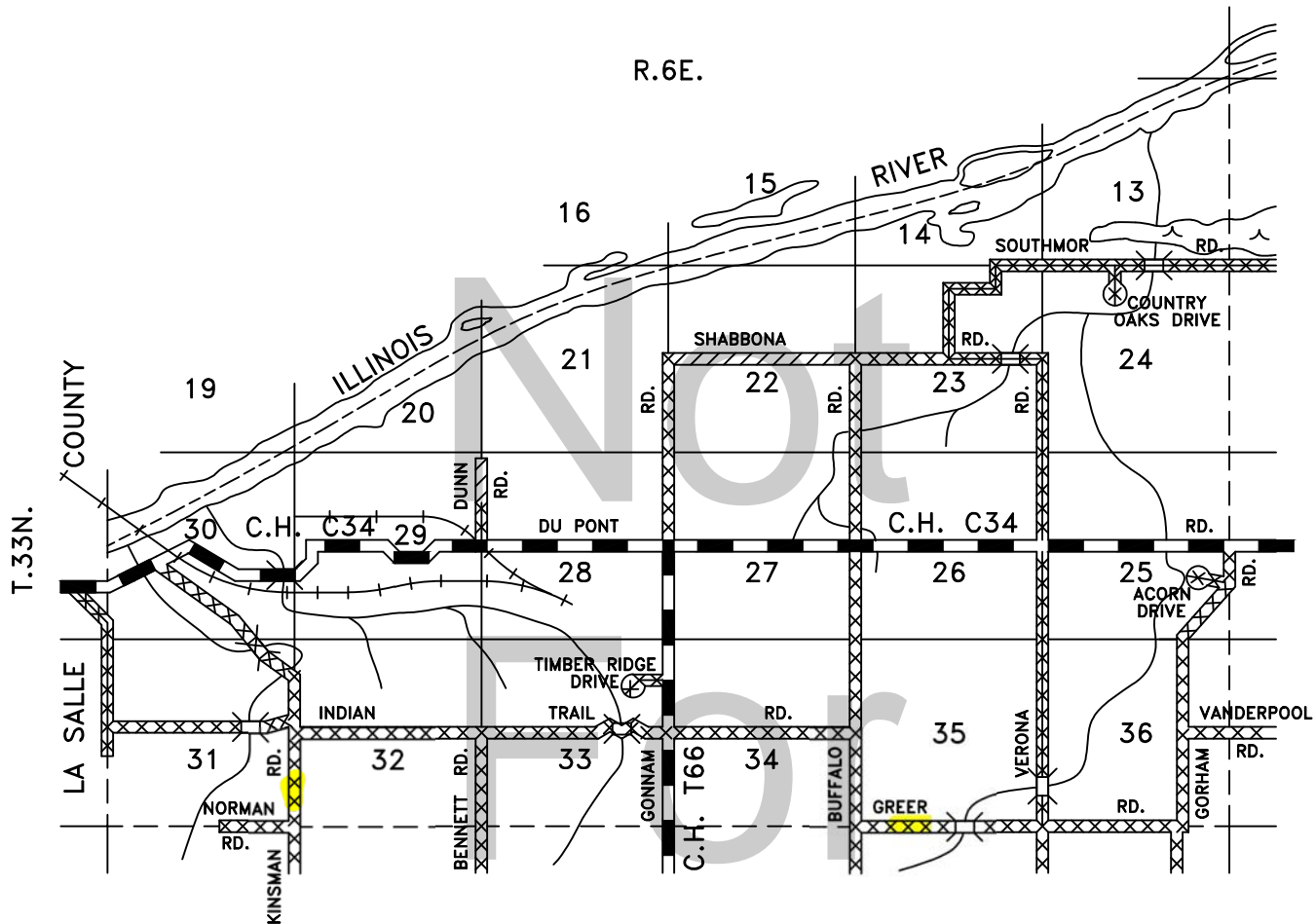

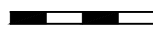
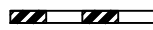
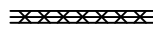
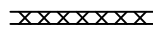
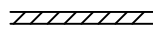
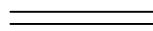
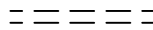

LEGEND

-  U.S., FEDERAL & STATE PAV'T.
-  C.H. BIT. CONCRETE
-  C.H. OIL & CHIP
-  TWP. BIT. CONCRETE
-  TWP. OIL & CHIP
-  TWP. GR. OR STONE
-  TWP. EARTH
-  PRIVATE
-  TWP. BRIDGE









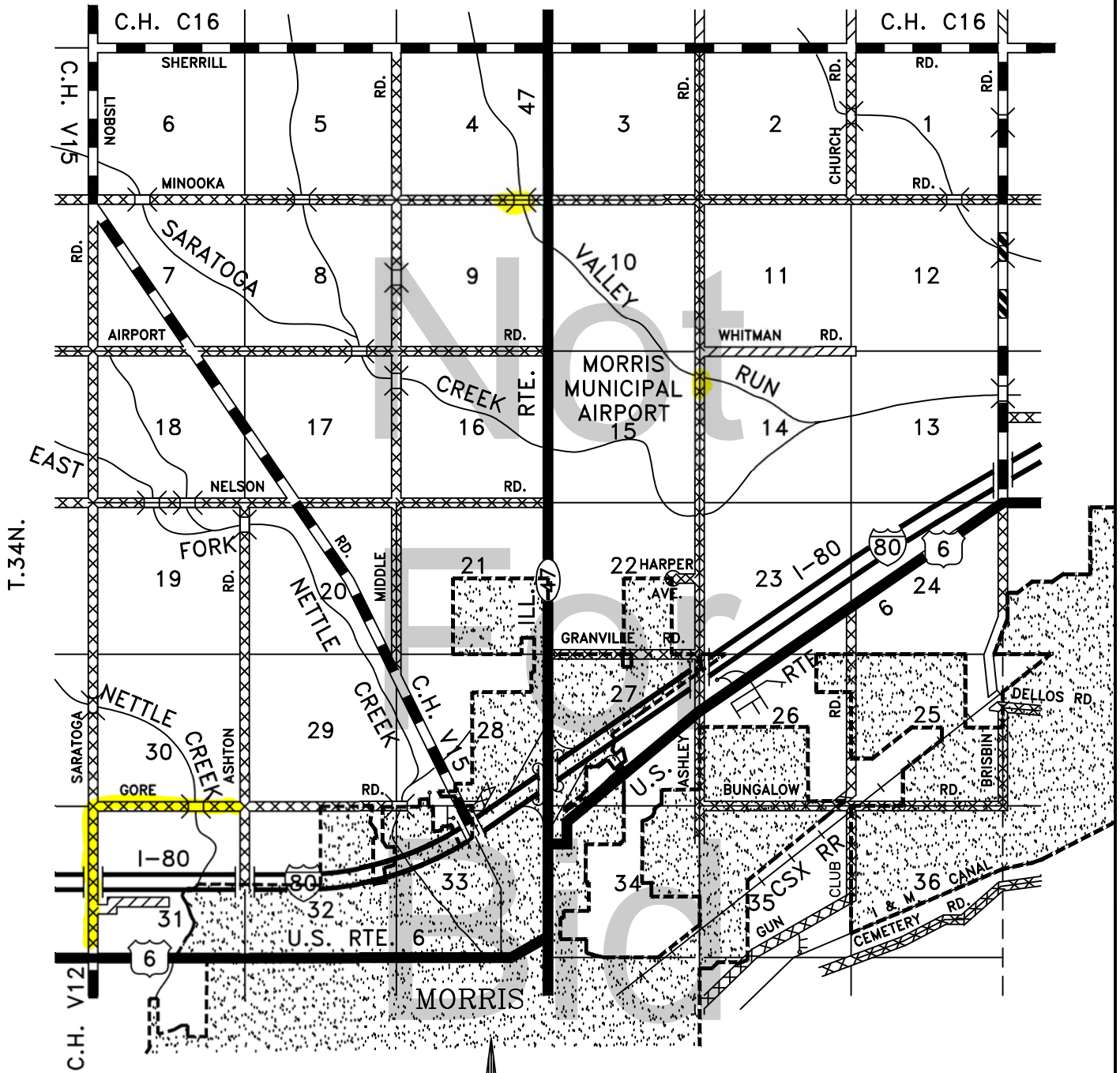

North
Scale: 1"=1 MILE

STATE OF ILLINOIS
GRUNDY COUNTY
NORMAN
TOWNSHIP

R.7E.
KENDALL COUNTY



LEGEND

- | | |
|---|------------------------------|
|  | U.S., FEDERAL & STATE PAV'T. |
|  | C.H. BIT. CONCRETE |
|  | C.H. OIL & CHIP |
|  | TWP. BIT. CONCRETE |
|  | TWP. OIL & CHIP |
|  | TWP. GR. OR STONE |
|  | TWP. EARTH |
|  | PRIVATE |
|  | TWP. BRIDGE |



North
Scale: 1"=1 MILE

STATE OF ILLINOIS
GRUNDY COUNTY
SARATOGA
TOWNSHIP

Department of Transportation

Bureau of Local Roads and Streets

Plans for Proposed

Road District Improvement

Scales { Plan 1 inch = Ft.
Profile, Horizontal 1 inch = Ft.
Profile, Vertical 1 inch = Ft.

LOCATIONS
Saratoga Rd. Rt 6 to Gore Rd.

Gore Rd. Saratoga Rd. to
Ashton Rd.

County Grundy
Road District Saratoga Township
Section 24 - 15 000 - 00 - GM, Group IV

Typical Cross Section

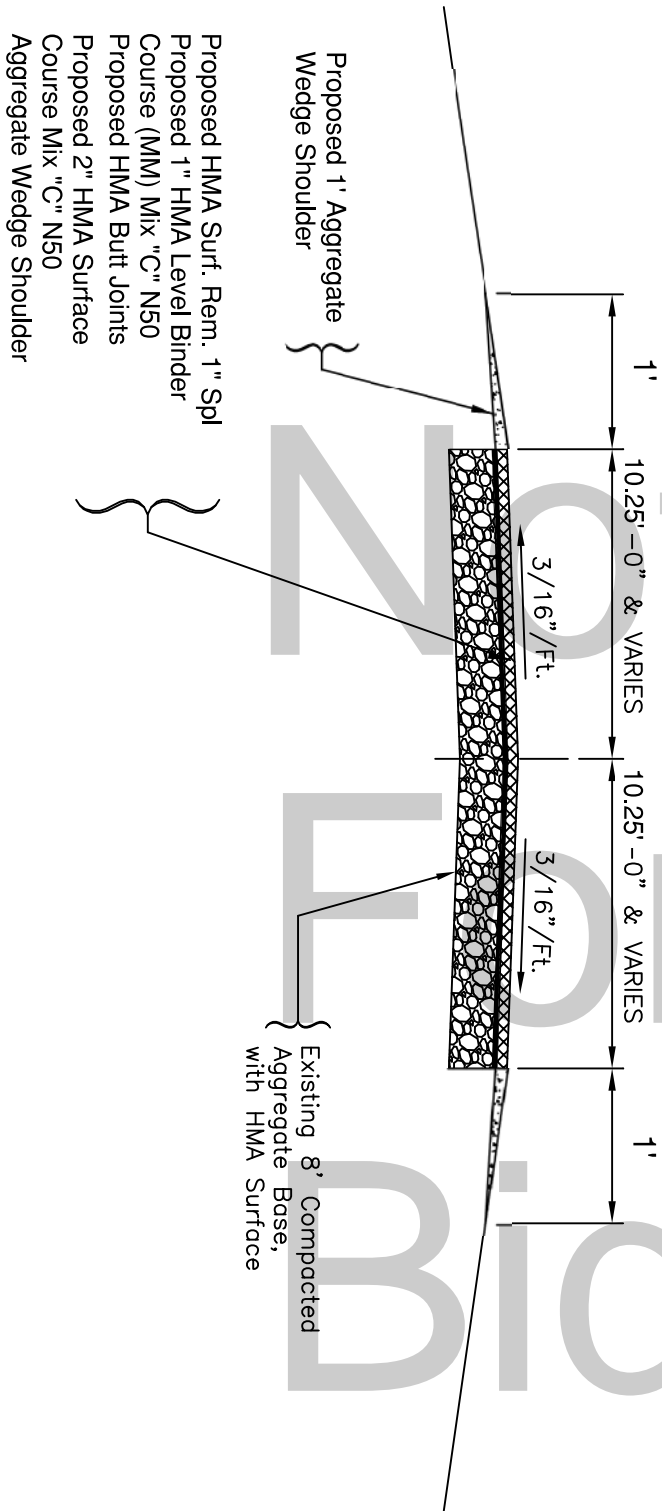

PG Grade For Hot-Mix Asphalt

Mix	PG Grade
Level Binder	64 - 22
Binder Course	64 - 22
Surface Course	64 - 22
Patching	64 - 22
Base Course and Widening	64 - 22

* See Proposal for Specifications

Approved _____, 2024

District/Regional Engineer

Submitted _____, 2024

Braceville Township Highway Commissioner

Grundy County Engineer

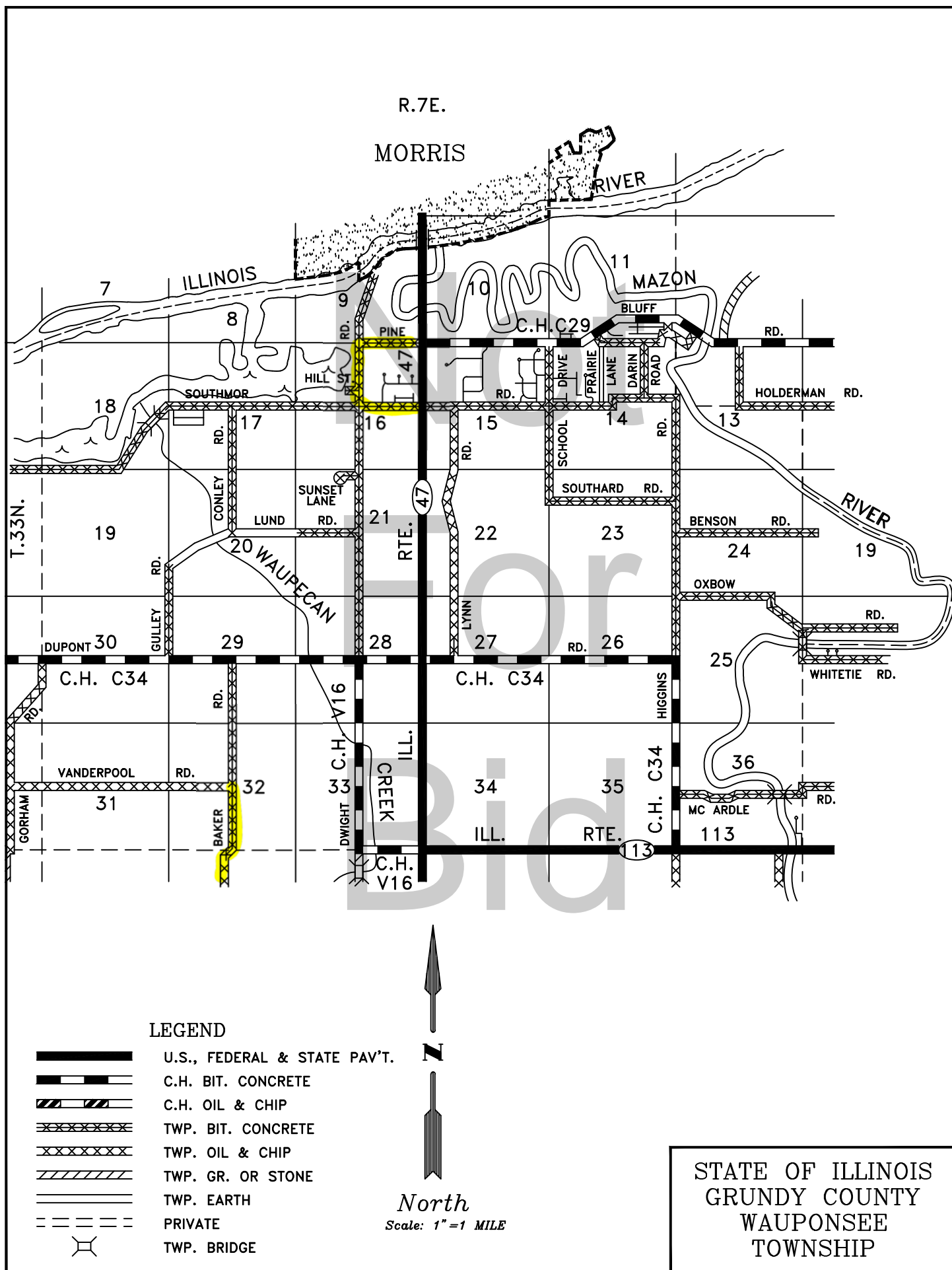

Department of Transportation

Bureau of Local Roads and Streets

Plans for Proposed

Road District Improvement

Scales { Plan 1 inch = Ft.
Profile, Horizontal 1 inch = Ft.
Profile, Vertical 1 inch = Ft.

LOCATIONS
Pine Bluff Rd: Rt 47 to Dwight Rd.
Dwight Rd: Pine Bluff Rd. to Southmor Rd.
Southmor Rd: Rt 47 to Dwight Rd.
Baker Rd: Vanderpool Rd. to Twp. Line

County Grundy
Road District Wauponsee Township
Section 24 - 17 000 - 00 - GM, Group IV

Typical Cross Section

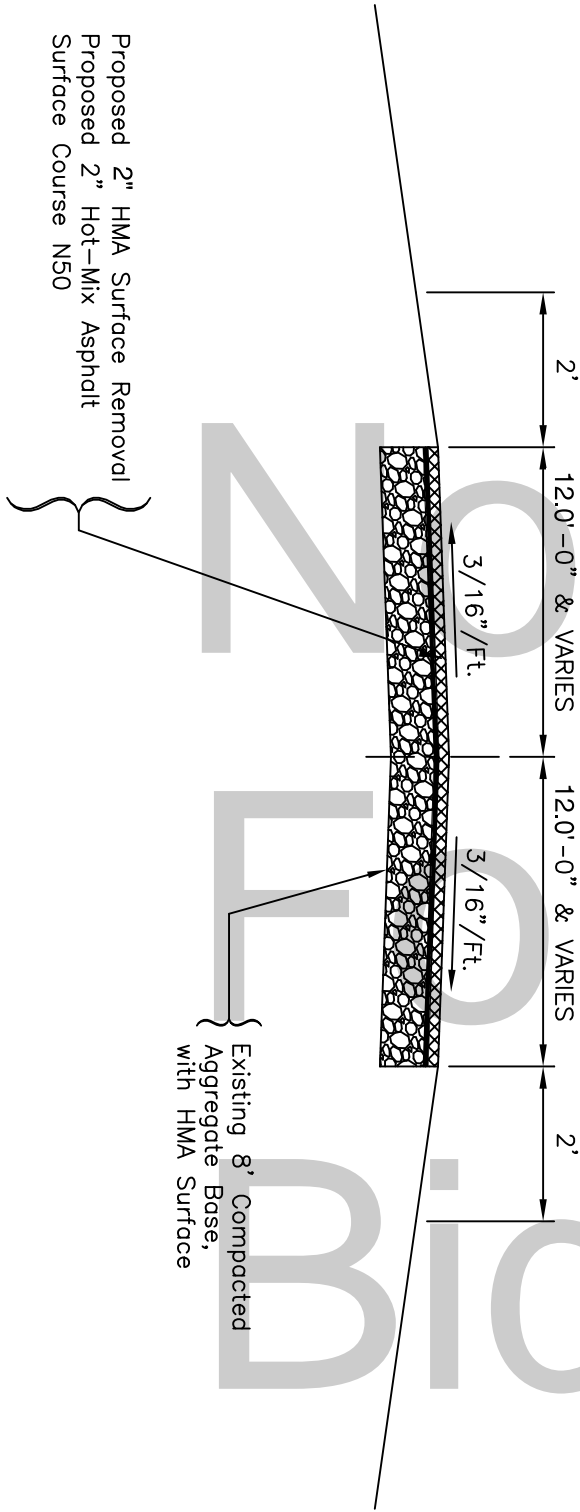

PG Grade For Hot-Mix Asphalt

Mix	PG Grade
Level Binder	64 - 22
Binder Course	64 - 22
Surface Course	64 - 22
Patching	64 - 22
Base Course and Widening	64 - 22

* See Proposal for Specifications

Approved _____, 2024

District/Regional Engineer

Submitted _____, 2024

Braceville Township Highway Commissioner

Grundy County Engineer

Grundy County, Illinois

