

MANCHESTER - HOOKSETT 42753 BRIDGE PRESERVATION PROJECT

**Town of Hooksett
Town Council Meeting**

September 14, 2022

David Scott, PE - NHDOT Project Manager

Email: David.L.Scott@dot.nh.gov

Phone: (603) 271-2731



PRESENTATION GOALS

MANCHESTER - HOOKSETT 42753

- Work Effort Overview
- Provide Construction Schedule
- Share Traffic Control Concepts
- Obtain Feedback & Answer Questions

WORK OVERVIEW

MANCHESTER - HOOKSETT 42753

- Included Efforts
 - Replacement of Bridge Pavement and Membrane Waterproofing
 - Repairs to Concrete Deck
 - Repairs to Bridge Curb and Bridge Rail
 - Replacement of Bridge Deck Joints
- Excluded Efforts
 - Drainage Improvements
 - Guardrail or Approach Rail Work
 - Permanent Pavement Beyond Bridge Preservation Needs

I-93 NORTHBOUND BRIDGE LOCATIONS

MANCHESTER - HOOKSETT 42753

US 3 Bridge

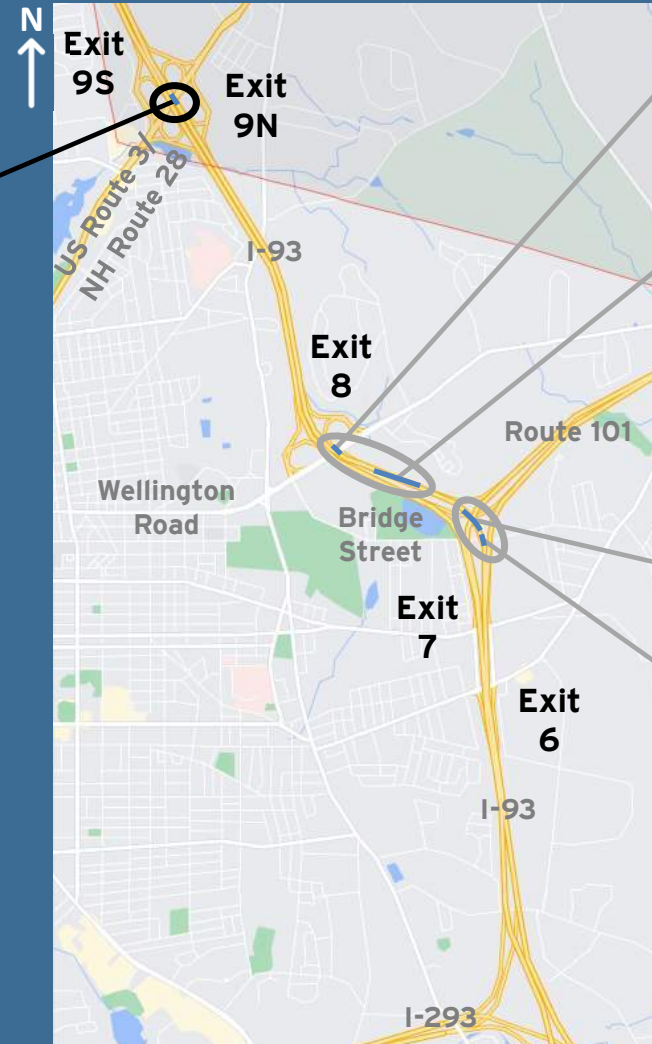

Wellington
Road Bridge

Stevens
Pond Bridge

Stack Bridge

Bridge Street
Bridge

New Hampshire
DOT
Department of Transportation

HNTB

CONSTRUCTION SCHEDULE

MANCHESTER - HOOKSETT 42753



5

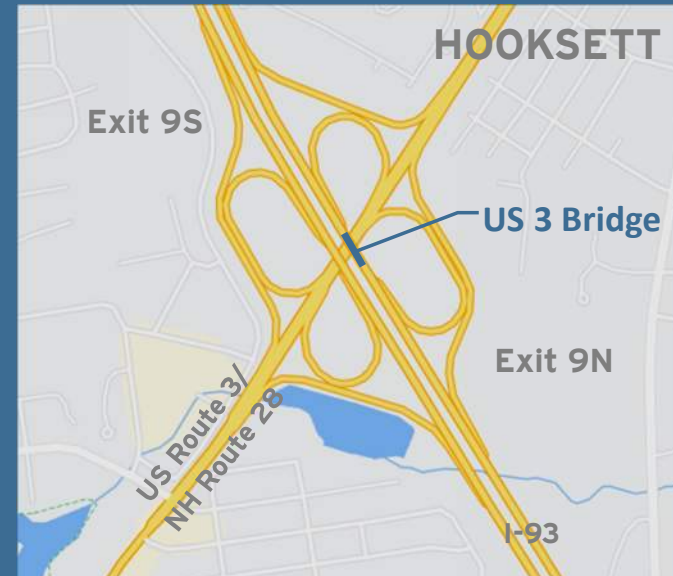

2 Construction Seasons* (April - October)

- Season 1 - 2024
- Season 2 - 2025

*Note: Order of Seasons may be Reversed
Based on Contractor Preference

New Hampshire
DOT
Department of Transportation

HNTB

LOCATIONS OF INTEREST

MANCHESTER - HOOKSETT 42753



LOCATION A

6A

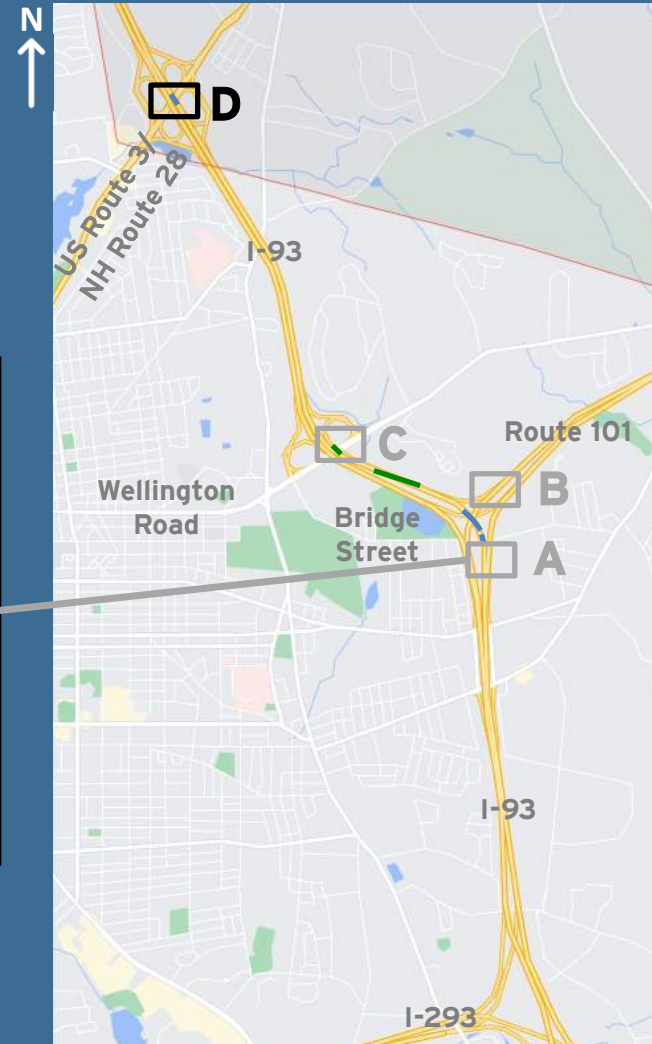

LOCATIONS OF INTEREST

MANCHESTER - HOOKSETT 42753

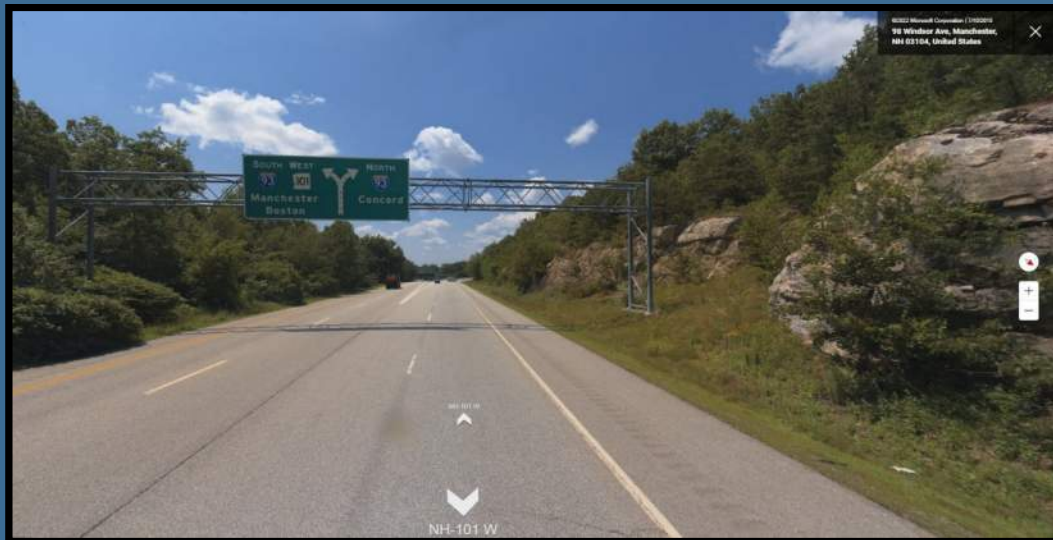

LOCATION B

6B

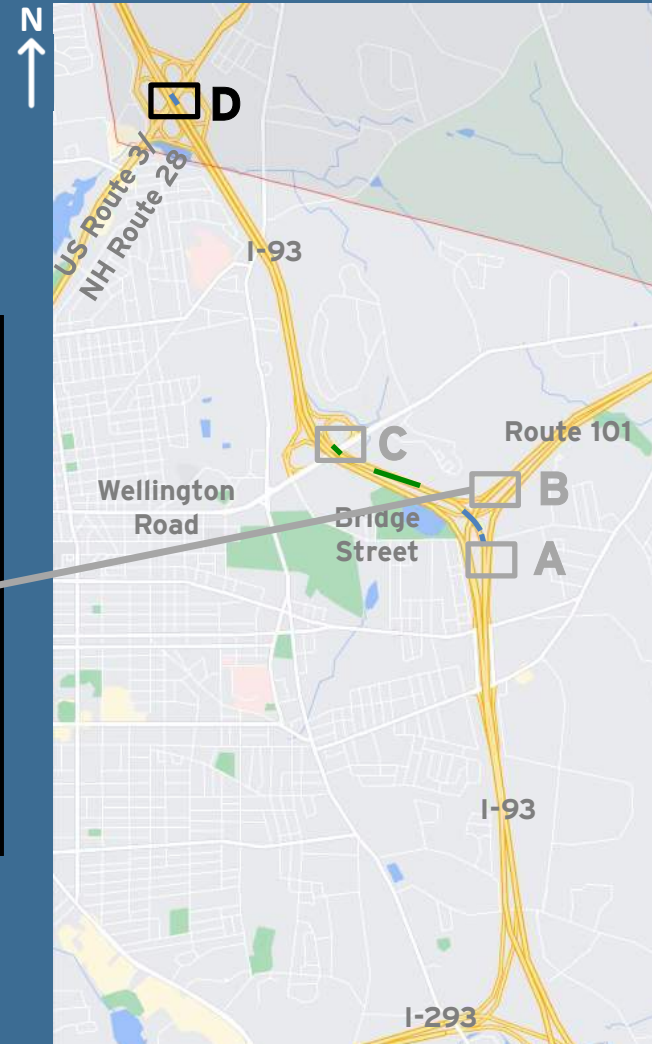

LOCATIONS OF INTEREST

MANCHESTER - HOOKSETT 42753



LOCATION C

6C

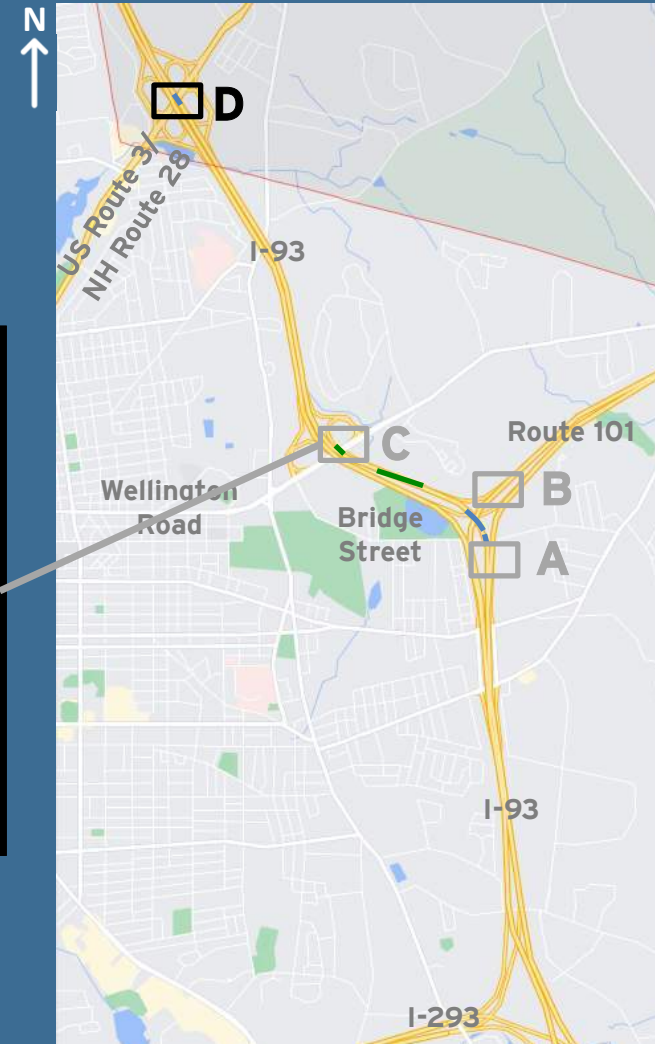

LOCATIONS OF INTEREST

MANCHESTER - HOOKSETT 42753



LOCATION D

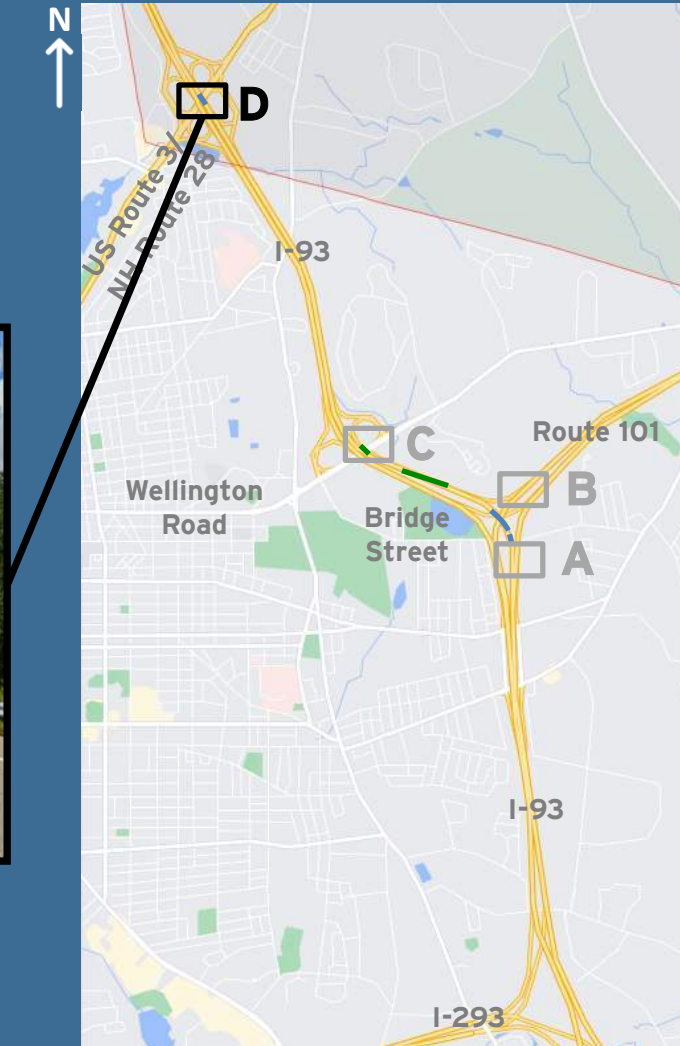

LOCATION D - Exit 9S

MANCHESTER - HOOKSETT 42753



EXISTING



DURING CONSTRUCTION

DURATION - APPROX. 3 MONTHS

LOCATION D - Exit 9S

MANCHESTER - HOOKSETT 42753



EXISTING

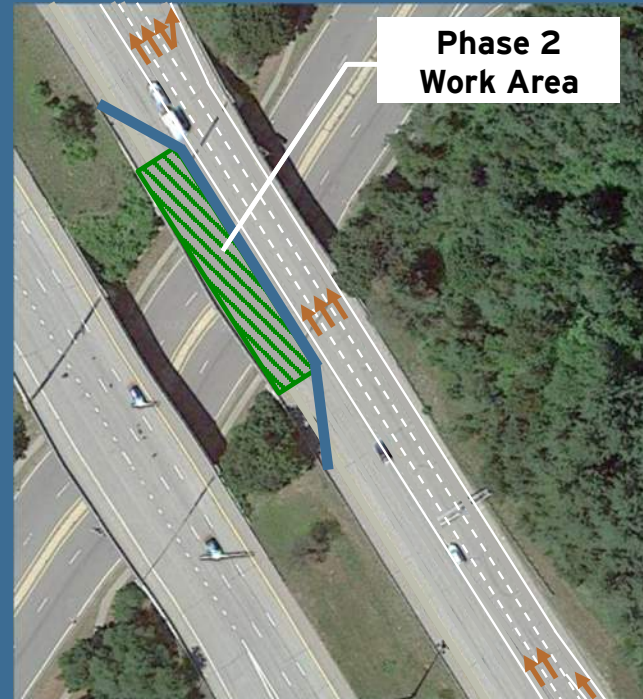

DURING CONSTRUCTION

DURATION - APPROX. 3 MONTHS

New Hampshire
DOT
Department of Transportation

HNTB

LOCATION D - Exit 9S

MANCHESTER - HOOKSETT 42753



EXISTING

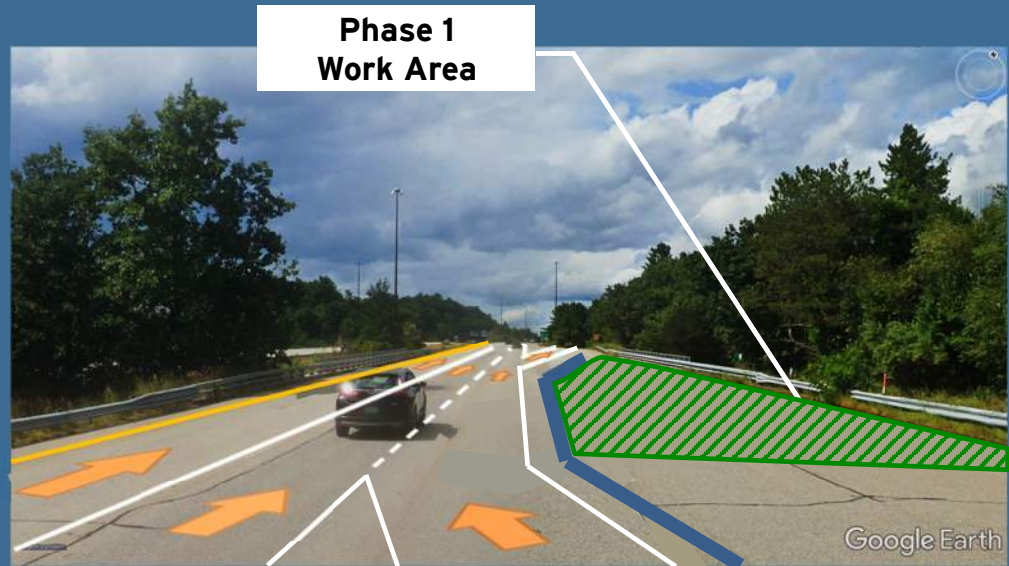

DURING CONSTRUCTION

DURATION - APPROX. 6 MONTHS
(3 Months Each Phase)

LOCATIONS OF INTEREST

MANCHESTER - HOOKSETT 42753



LOCATION A

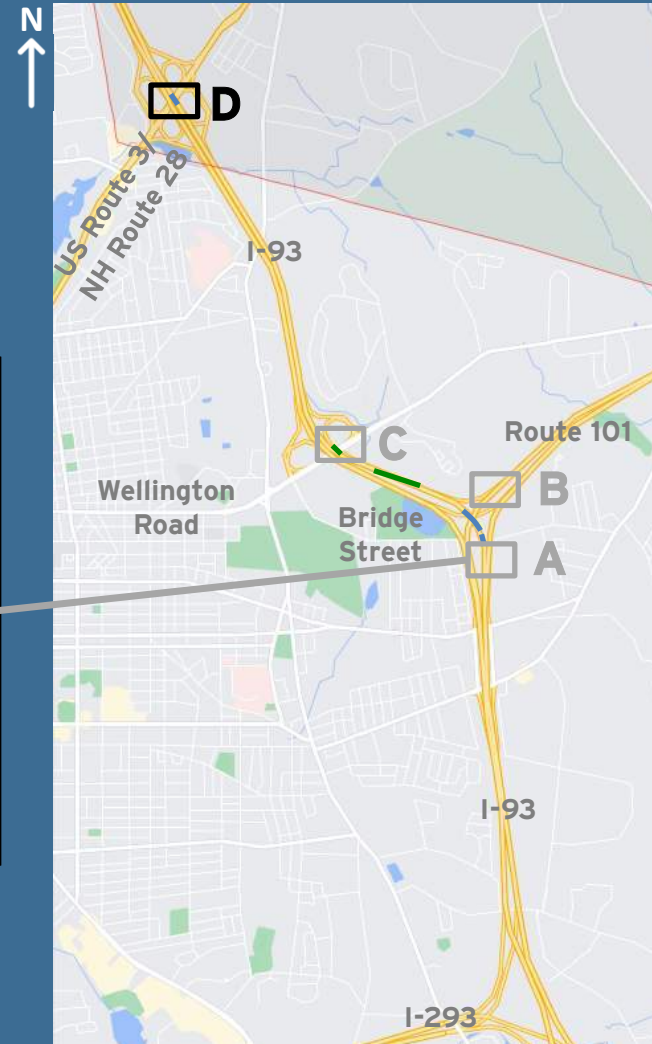

LOCATION A - Exit 7 Approach

MANCHESTER - HOOKSETT 42753



EXISTING

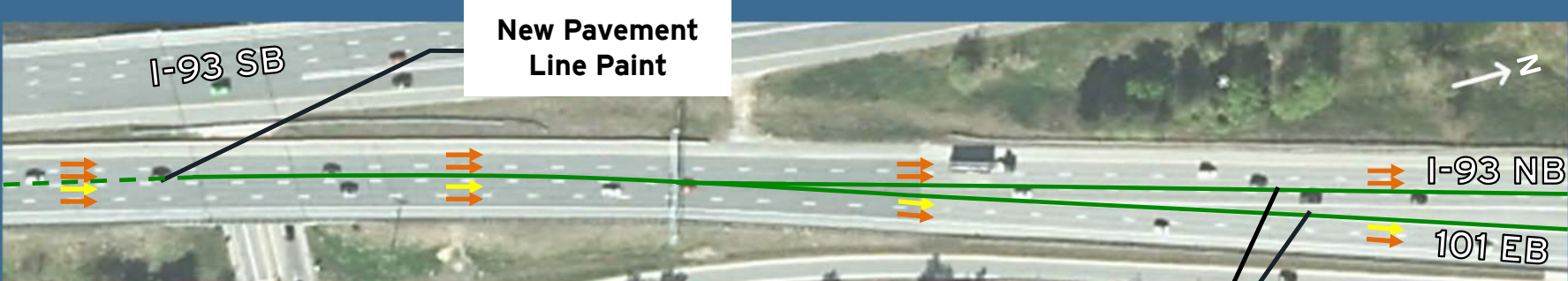

DURING CONSTRUCTION

LOCATION A - Exit 7 Approach

MANCHESTER - HOOKSETT 42753



EXISTING

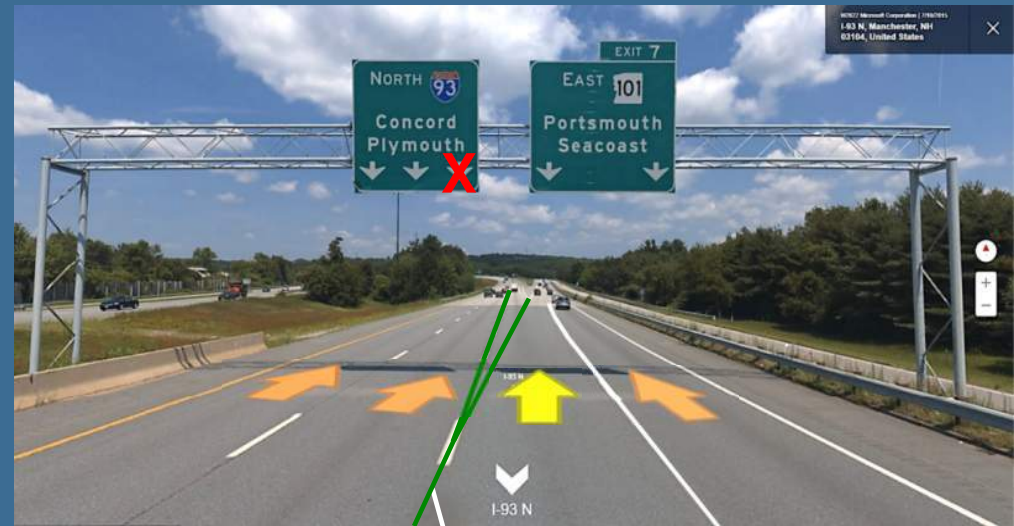

DURING CONSTRUCTION

New Pavement
Line Paint

DURATION - APPROX. 2 YEARS

(Both Construction Seasons - Non-Winter Months)

New Hampshire
DOT
Department of Transportation

HNTB

LOCATIONS OF INTEREST

MANCHESTER - HOOKSETT 42753

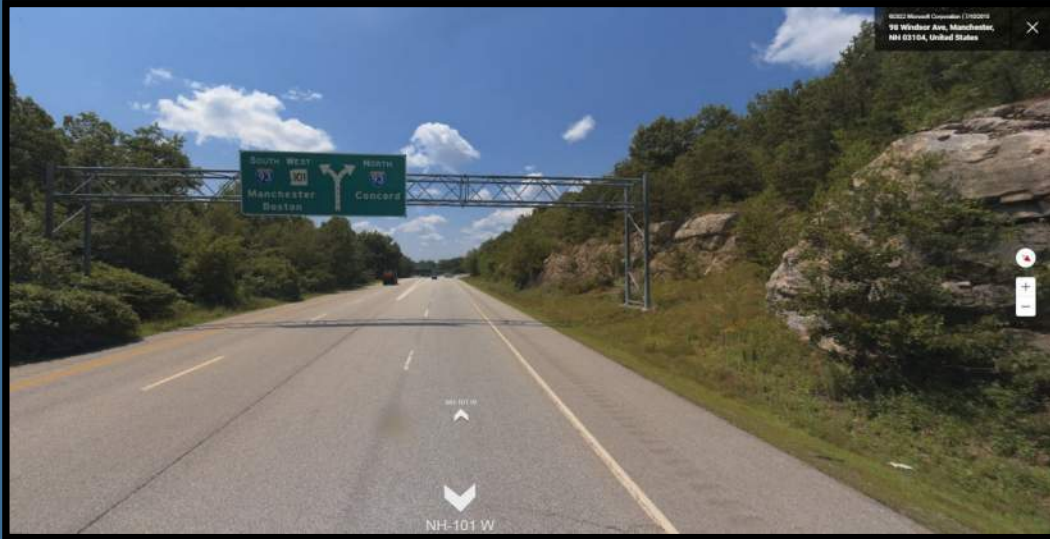

LOCATION B

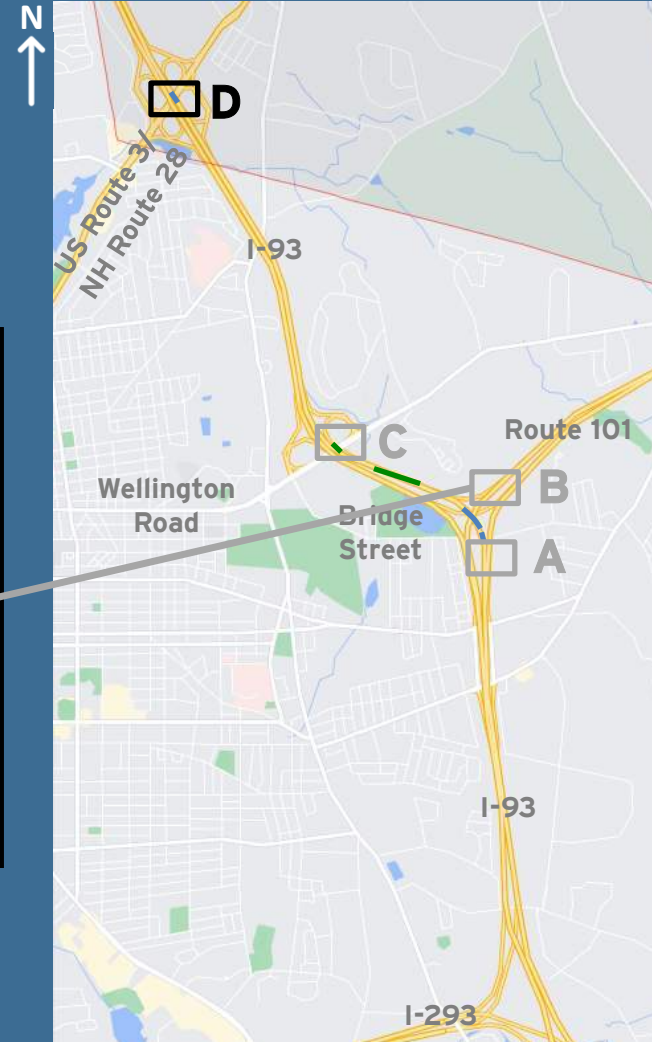

LOCATION B - Rt. 101 WB/I-93 NB Merge

MANCHESTER - HOOKSETT 42753



EXISTING

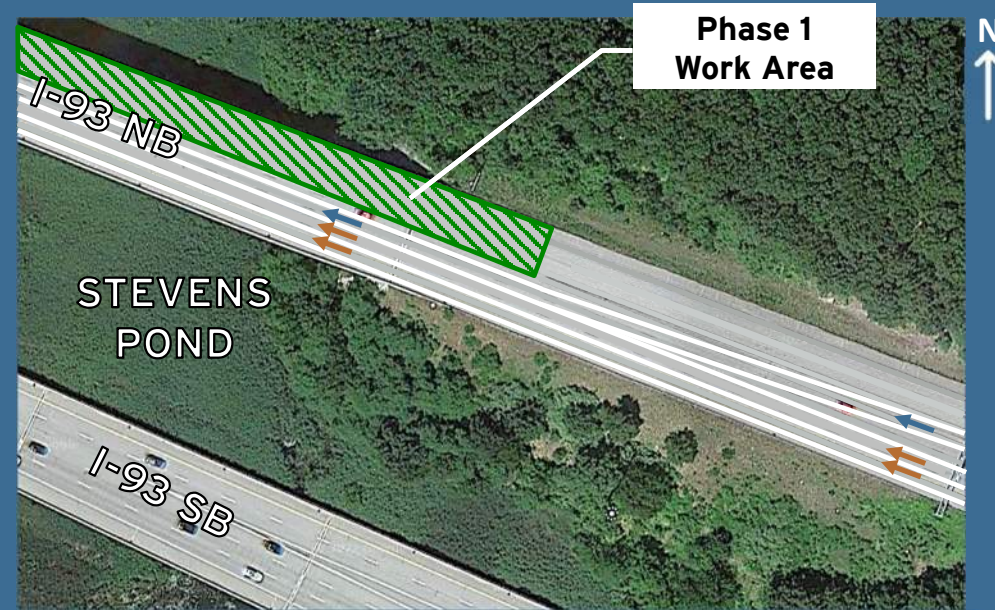

DURING CONSTRUCTION

DURATION - APPROX. 8 MONTHS
(4 Months Each Phase)

LOCATION B - Rt. 101 WB/I-93 NB Split

MANCHESTER - HOOKSETT 42753



EXISTING

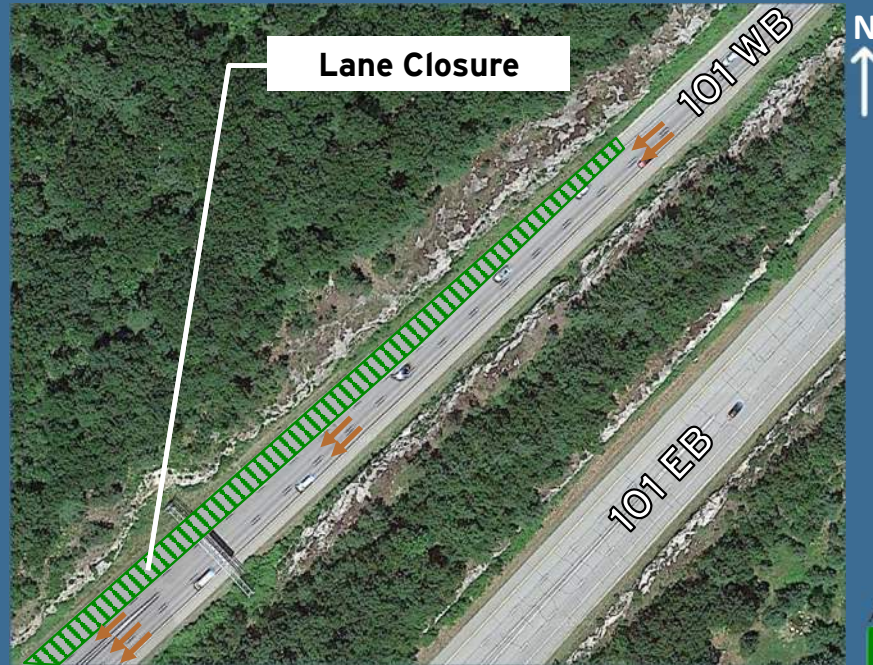

DURING CONSTRUCTION

DURATION - APPROX. 8 MONTHS

LOCATION B - Rt. 101 WB/I-93 NB Split

MANCHESTER - HOOKSETT 42753



EXISTING



DURING CONSTRUCTION

DURATION - APPROX. 8 MONTHS
(4 Months Each Phase)

LOCATIONS OF INTEREST

MANCHESTER - HOOKSETT 42753



LOCATION C

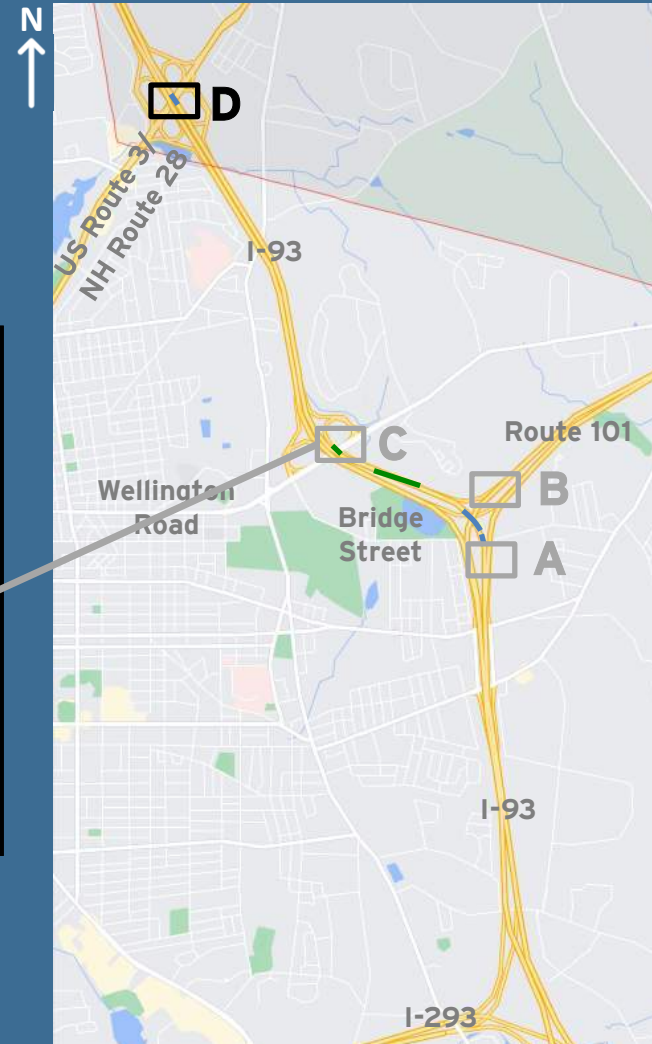

LOCATION C - Exit 8 (Phase 1)

MANCHESTER - HOOKSETT 42753

Temporary Off Ramp

- Temporary Exit 8 Ramp to be Open at Reduced Speeds
- Allows Interchange to Remain Open During Construction

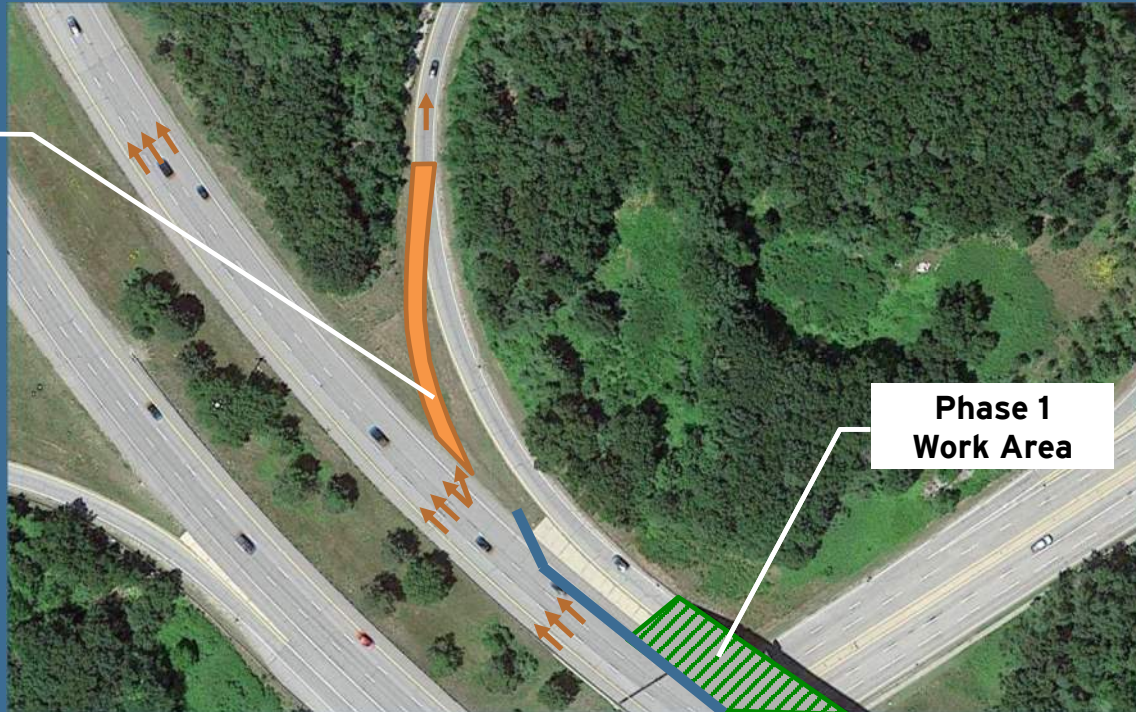

DURATION - APPROX. 4 MONTHS

LOCATION C - Exit 8 (Phase 2)

MANCHESTER - HOOKSETT 42753

Existing Ramp Used



DURATION - APPROX. 4 MONTHS

LOCATION C - Exit 8 (Phase 1)

MANCHESTER - HOOKSETT 42753



EXISTING

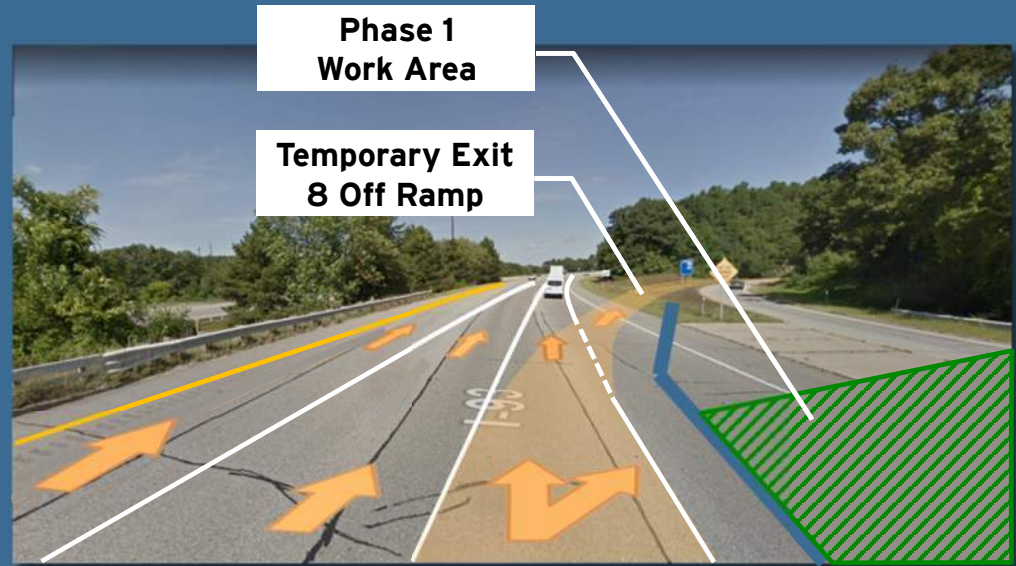

DURING CONSTRUCTION

DURATION - APPROX. 8 MONTHS
(4 Months Each Phase)

Thank you

Questions & Comments

David Scott - NHDOT Project Manager

Email: David.L.Scott@dot.nh.gov

Phone: (603) 271-2731

Copy of the presentation can be found at:

[https://www.nh.gov/dot/projects/
manchesterhooksett42753/index.htm](https://www.nh.gov/dot/projects/manchesterhooksett42753/index.htm)

