

August 14, 2014

**Official Proceedings
Pontiac City Council
34th Session of the Ninth Council**

A Regular Meeting of the City Council of Pontiac, Michigan was called to order in City Hall, Thursday, August 14, 2014 at 5:30 P.M. by President Patrice Waterman.

Invocation – Mark Holland

Pledge of Allegiance

Roll Call

Members Present: Carter, Holland, Pietila, Taylor-Burks, Waterman, Williams and Woodward.
Mayor Waterman was absent.
Clerk announced a quorum.

14-312 **Approval of the Agenda.** Moved by Councilperson Woodward and supported by Councilperson Holland.

Ayes: Carter, Holland, Pietila, Taylor-Burks, Waterman, Williams and Woodward
No: None
Motion Carried.

14-313 **Journal of August 7, 2014.** Moved by Councilperson Pietila and supported by Councilperson Taylor-Burks.

Ayes: Carter, Holland, Pietila, Taylor-Burks, Waterman, Williams and Woodward
No: None
Motion Carried.

Special Presentation – Pastor Jones (Dream Cruise)

Community Announcement – Lee Crump (Loving My Life Fitness Center) and Quincy Stewart

There were 8 individuals who addressed the body during public comments.

14-314 **Report received from the City Administrator concerning a resolution for the amendment to existing IDD for 220 E. Columbia. (aka 170 E. Beverly)** Moved by Councilperson Woodward and supported by Councilperson Taylor-Burks.

Whereas, pursuant to PA 198 of 1974, as amended, this city council has the authority to establish “Industrial Development Districts” within the City of Pontiac; and
Whereas, the City of Pontiac on its own initiative seeks to establish an Industrial Development District on property located within the City of Pontiac boundaries; and

August 14, 2014

Whereas, construction, acquisition, alteration, or installation of a proposed facility has not commenced at the time of filing the request to establish this district; and
Whereas, written notice has been given by mail to all owners of real property located within the district, and to the public by newspaper advertisement in the Oakland Press and/or public posting of the hearing on the establishment of the proposed district; and
Whereas, on August 7, 2014 a public hearing was held at which all owners of real property within the proposed Industrial Development District and all residents and taxpayers of the City of Pontiac were afforded an opportunity to be heard thereon; and
Whereas, the City Council deems it to be in the public interest of the City of Pontiac to establish the Industrial Development District as proposed; and
Now, Therefore, Be It Resolved by the City Council of the City of Pontiac that the following described parcel of land situated in the City of Pontiac, County of Oakland, and State of Michigan, to wit:

A PARCEL OF LAND DESCRIBED AS BEGINNING AT THE INTERSECTION OF EAST LINE OF THE PO&N RAILROAD AND THE NORTH LINE OF MONTCALM STREET; THENCE NORTH ALONG THE EAST LINE OF THE PO&N RAILROAD RIGHT-OF-WAY LINE 6300 FEET TO A POINT; THENCE EASTERLY 700 FEET TO A POINT; THENCE SOUTHERLY 2400 FEET TO A POINT; THENCE EASTERLY 625 FEET TO A POINT ON THE WEST RIGHT-OF-WAY LINE OF HIGHWOOD BOULEVARD; THENCE SOUTHERLY ALONG THE WEST RIGHT-OF-WAY OF HIGHWOOD BOULEVARD 600 FEET TO A POINT, SAID POINT BEING THE INTERSECTION OF THE WEST RIGHT-OF-WAY OF HIGHWOOD BOULEVARD AND THE SOUTH RIGHT-OF-WAY OF BEVERLY AVENUE; THENCE EASTERLY ALONG THE SOUTH RIGHT-OF-WAY OF BEVERLY AVENUE 1250 FEET TO A POINT, SAID POINT BEING THE INTERSECTION OF THE SOUTH RIGHT-OF-WAY OF BEVERLY AVENUE AND THE WEST RIGHT-OF-WAY OF GLENWOOD BOULEVARD; THENCE SOUTHERLY ALONG THE WEST RIGHT-OF-WAY OF GLENWOOD BOULEVARD 900 FEET TO A POINT; THENCE EASTERLY 125 FEET TO A POINT; THENCE SOUTHERLY 525 FEET TO A POINT; THENCE WESTERLY 100 FEET TO A POINT ON THE WEST RIGHT-OF-WAY LINE OF GLENWOOD BOULEVARD; THENCE SOUTHERLY ALONG THE WEST RIGHT-OF-WAY LINE OF GLENWOOD BOULEVARD 50 FEET TO A POINT; THENCE WESTERLY 550 FEET TO A POINT; THENCE SOUTHERLY 1900 FEET TO A POINT ON THE NORTH RIGHT-OF-WAY LINE OF MONTCALM STREET; THENCE WESTERLY ALONG THE NORTH RIGHT-OF-WAY LINE OF MONTCALM STREET 2100 FEET TO THE POINT OF BEGINNING.

is established as an Industrial Development District pursuant to the provision of PA 198 of 1974, as amended, to be known as Pontiac Industrial Development District No. 2014-1.

Ayes: Holland, Pietila, Taylor-Burks, Waterman, and Woodward

No: Carter

Resolution Adopted.

Councilman Williams was temporarily excused.

Memorandum

To: Pontiac City Council

From: Joseph M. Sobota, M.P.A., City Administrator 

Date: July 15, 2014

Re: Amendment to existing IFT for 220 E. Columbia (aka 170 E. Beverly)

In 1977, the City of Pontiac created an Industrial Development District (IDD) that included several parcels off of E. Columbia. The primary beneficiary of the district was the General Motors Corporation. General Motors recently approached the City and requested that the existing district boundaries be amended to incorporate the complete parcel that is currently owned by General Motors as the current district only incorporates a portion of the parcel that is currently owned by General Motors.

The law concerning the amendment of an existing IDD is not very clear. In a series of communication with the State Tax Commission (STC), the STC has recommended that the document that is considered by the City clearly demonstrates the existing district boundaries, the area proposed to be amended, and the new district boundaries as amended.

General Motors engaged the services of Nowak and Fraus to prepare the required legal descriptions (and a reference map attached).

The process to amend an IDD is the same process that is used to create a new IDD and is described in MCL 207.554.

For this purpose, the IDD will be amended upon the initiative of the City. At the time of this district establishment, no construction, acquisition, alteration, or installation for a proposed replacement facility or new facility has commenced.

The law requires that before the City considers a resolution establishing the industrial development district, that the City Council must give written notice by certified mail to the owners of all real property within the proposed industrial development district and hold a public hearing on the establishment (amendment) of the proposed district (amended district) at which hearing those owners and other taxpayers have the right to appear and be heard. Fourteen days notice is recommended.

To meet various State deadlines, City Council is requested to take final action on the resolution presented below to create (amend) the district no later than Thursday, August 7, thus requiring the notice of the public hearing to be published no later than July 24, meaning that City Council is requested to set the date and time of the public hearing at your meeting of Thursday, July 17.

After the public hearing, the City Council is requested to adopt the following resolution:

[Redacted area]

WHEREAS, pursuant to PA 198 of 1974, as amended, this city council has the authority to establish "Industrial Development Districts" within the City of Pontiac; and

WHEREAS, the City of Pontiac on its own initiative seeks to establish an Industrial Development District on property located within the City of Pontiac boundaries; and,

WHEREAS, construction, acquisition, alteration, or installation of a proposed facility has not commenced at the time of filing the request to establish this district; and

WHEREAS, written notice has been given by mail to all owners of real property located within the district, and to the public by newspaper advertisement in the Oakland Press and/or public posting of the hearing on the establishment of the proposed district; and

WHEREAS, on (date) a public hearing was held at which all owners of real property within the proposed Industrial Development District and all residents and taxpayers of the City of Pontiac were afforded an opportunity to be heard thereon; and

WHEREAS, the City Council deems it to be in the public interest of the City of Pontiac to establish the Industrial Development District as proposed; and

NOW, THEREFORE, BE IT RESOLVED by the City Council of the City of Pontiac that the following described parcel of land situated in the City of Pontiac, County of Oakland, and State of Michigan, to wit:

A PARCEL OF LAND DESCRIBED AS BEGINNING AT THE INTERSECTION OF EAST LINE OF THE PO&N RAILROAD AND THE NORTH LINE OF MONTCALM STREET; THENCE NORTH ALONG THE EAST LINE OF THE PO&N RAILROAD RIGHT-OF-WAY LINE 6300 FEET TO A POINT; THENCE EASTERLY 700 FEET TO A POINT; THENCE SOUTHERLY 2400 FEET TO A POINT; THENCE EASTERLY 625 FEET TO A POINT ON THE WEST RIGHT-OF-WAY LINE OF HIGHWOOD BOULEVARD; THENCE SOUTHERLY ALONG THE WEST RIGHT-OF-WAY OF HIGHWOOD BOULEVARD 600 FEET TO A POINT, SAID POINT BEING THE INTERSECTION OF THE WEST RIGHT-OF-WAY OF HIGHWOOD BOULEVARD AND THE SOUTH RIGHT-OF-WAY OF BEVERLY AVENUE; THENCE EASTERLY ALONG THE SOUTH RIGHT-OF-WAY OF BEVERLY AVENUE 1250 FEET TO A POINT, SAID POINT BEING THE INTERSECTION OF THE SOUTH RIGHT-OF-WAY OF BEVERLY AVENUE AND THE WEST RIGHT-OF-WAY OF GLENWOOD BOULEVARD; THENCE SOUTHERLY ALONG THE WEST RIGHT-OF-

July 15, 2014

WAY OF GLENWOOD BOULEVARD 900 FEET TO A POINT; THENCE
EASTERLY 125 FEET TO A POINT; THENCE SOUTHERLY 525 FEET TO
A POINT; THENCE WESTERLY 100 FEET TO A POINT ON THE WEST
RIGHT-OF-WAY LINE OF GLENWOOD BOULEVARD; THENCE
SOUTHERLY ALONG THE WEST RIGHT-OF-WAY LINE OF GLENWOOD
BOULEVARD 50 FEET TO A POINT; THENCE WESTERLY 550 FEET TO
A POINT; THENCE SOUTHERLY 1900 FEET TO A POINT ON THE
NORTH RIGHT-OF-WAY LINE OF MONTCALM STREET; THENCE
WESTERLY ALONG THE NORTH RIGHT-OF-WAY LINE OF MONTCALM
STREET 2100 FEET TO THE POINT OF BEGINNING.

*is established as an Industrial Development District pursuant to the
provisions of PA 198 of 1974, as amended, to be known as Pontiac Industrial
Development District No. 2014-1.*

Exhibit A

DESCRIPTIONS - EXISTING INDUSTRIAL DEVELOPMENT DISTRICT AND PROPOSED ADDITIONS TO DISTRICT

LEGAL DESCRIPTION - EXISTING INDUSTRIAL DEVELOPMENT DISTRICT (I.D.D.)

THE LEGAL DESCRIPTION OF THE REAL PROPERTY LOCATED WITHIN THE BOUNDARY OF AN INDUSTRIAL DEVELOPMENT DISTRICT ESTABLISHED JUNE 28, 1977, SITUATED IN THE CITY OF PONTIAC, OAKLAND COUNTY, MICHIGAN, AND DESCRIBED AS:

A PARCEL OF LAND DESCRIBED AS BEGINNING AT THE INTERSECTION OF EAST LINE OF THE PO&N RAILROAD AND THE NORTH LINE OF MONTCALM AVENUE; THENCE NORTH ALONG THE EAST LINE OF THE PO&N RAILROAD RIGHT-OF-WAY LINE 6300 FEET TO A POINT; THENCE EASTERLY 700 FEET TO A POINT; THENCE SOUTHERLY 3275 FEET TO A POINT; THENCE EASTERLY 1300 FEET TO A POINT; THENCE THENCE SOUTHERLY 600 FEET TO A POINT; THENCE EASTERLY 700 FEET TO A POINT; THENCE SOUTHERLY 525 FEET TO A POINT; THENCE WESTERLY 650 FEET TO A POINT; THENCE SOUTHERLY 1900 FEET TO A POINT ON THE NORTH RIGHT-OF-WAY LINE OF MONTCALM AVENUE; THENCE WESTERLY ALONG THE NORTH RIGHT-OF-WAY LINE OF MONTCALM AVENUE 2100 FEET TO THE POINT OF BEGINNING.

LEGAL DESCRIPTION - PROPOSED I.D.D. EXPANSION PARCEL 1

THE LEGAL DESCRIPTION OF THE REAL PROPERTY ADDED TO AN INDUSTRIAL DEVELOPMENT DISTRICT ESTABLISHED JUNE 28, 1977, SITUATED IN THE CITY OF PONTIAC, OAKLAND COUNTY, MICHIGAN, AND DESCRIBED AS:

A PARCEL OF LAND DESCRIBED AS COMMENCING AT THE INTERSECTION OF EAST LINE OF THE PO&N RAILROAD AND THE NORTH LINE OF MONTCALM AVENUE; THENCE NORTH ALONG THE EAST LINE OF THE PO&N RAILROAD RIGHT-OF-WAY LINE 6300 FEET TO A POINT; THENCE EASTERLY 700 FEET TO A POINT; THENCE SOUTHERLY 2400 FEET TO A POINT, SAID POINT BEING THE POINT OF BEGINNING; THENCE EASTERLY 625 FEET TO A POINT ON THE WEST RIGHT-OF-WAY LINE OF HIGHWOOD BOULEVARD; THENCE SOUTHERLY ALONG THE WEST RIGHT-OF-WAY LINE OF HIGHWOOD BOULEVARD 600 FEET TO A POINT, SAID POINT BEING THE INTERSECTION OF THE WEST RIGHT-OF-WAY LINE OF HIGHWOOD BOULEVARD AND THE SOUTH RIGHT-OF-WAY LINE OF BEVERLY AVENUE; THENCE EASTERLY ALONG THE SOUTH RIGHT-OF-WAY LINE OF BEVERLY AVENUE 1250 FEET TO A POINT, SAID POINT BEING THE INTERSECTION OF THE WEST RIGHT-OF-WAY LINE OF GLENWOOD BOULEVARD AND THE SOUTH RIGHT-OF-WAY LINE OF BEVERLY AVENUE; THENCE SOUTHERLY ALONG THE WEST RIGHT-OF-WAY LINE OF GLENWOOD BOULEVARD 900 FEET TO A POINT ON THE EXISTING INDUSTRIAL DEVELOPMENT DISTRICT (I.D.D.) BOUNDARY; THENCE WESTERLY ALONG SAID I.D.D. BOUNDARY 575 FEET TO A POINT; THENCE NORTHERLY ALONG SAID I.D.D. BOUNDARY 600 FEET TO A POINT; THENCE CONTINUING WESTERLY ALONG SAID EXISTING I.D.D. BOUNDARY 1300 FEET TO A POINT; THENCE NORTHERLY ALONG SAID I.D.D. BOUNDARY 875 FEET TO THE POINT OF BEGINNING.

LEGAL DESCRIPTION - PROPOSED I.D.D. EXPANSION PARCEL 2

THE LEGAL DESCRIPTION OF THE REAL PROPERTY ADDED TO AN INDUSTRIAL DEVELOPMENT DISTRICT ESTABLISHED JUNE 28, 1977, SITUATED IN THE CITY OF PONTIAC, OAKLAND COUNTY, MICHIGAN, AND DESCRIBED AS:

A PARCEL OF LAND DESCRIBED AS BEGINNING AT THE INTERSECTION OF EAST LINE OF THE PO&N RAILROAD AND THE NORTH LINE OF MONTCALM STREET; THENCE EASTERLY ALONG SAID NORTH RIGHT-OF-WAY LINE OF MONTCALM STREET 2100 FEET TO A POINT; THENCE NORTHERLY 1850 FEET TO A POINT, SAID POINT BEING ON THE EXISTING INDUSTRIAL DEVELOPMENT DISTRICT (I.D.D.) BOUNDARY AND BEING THE POINT OF BEGINNING; THENCE NORTHERLY ALONG SAID I.D.D. BOUNDARY 50 FEET TO A POINT; THENCE EASTERLY ALONG SAID I.D.D. BOUNDARY 550 FEET TO A POINT ON THE WEST RIGHT-OF-WAY LINE OF GLENWOOD BOULEVARD; THENCE SOUTHERLY ALONG THE WEST RIGHT-OF-WAY LINE OF GLENWOOD BOULEVARD 50 FEET TO A POINT; THENCE WESTERLY 550 FEET TO THE POINT OF BEGINNING.



CIVIL ENGINEERS
LAND SURVEYORS
LAND PLANNERS

4677 WOODWARD AVENUE, PONTIAC, MI 48342-5032
TEL (248) 332-7931 FAX (248) 332-8257

DATED 07-11-14 JOB NO. H192 SCALE N/A
CLIENT GENERAL MOTORS CORPORATION SHEET NO. 1 of 4

Note:
06/28/99 - 509
THOUGH
CORRECTED
08/2008 - 08-598

Exhibit A

DESCRIPTIONS - PROPOSED INDUSTRIAL DEVELOPMENT DISTRICT

LEGAL DESCRIPTION - PROPOSED INDUSTRIAL DEVELOPMENT DISTRICT (I.D.D.)

THE LEGAL DESCRIPTION OF THE REAL PROPERTY LOCATED WITHIN THE BOUNDARY OF AN INDUSTRIAL DEVELOPMENT DISTRICT ORIGINALLY ESTABLISHED JUNE 28, 1977, SITUATED IN THE CITY OF PONTIAC, OAKLAND COUNTY, MICHIGAN, AND DESCRIBED AS:

A PARCEL OF LAND DESCRIBED AS BEGINNING AT THE INTERSECTION OF EAST LINE OF THE PO&N RAILROAD AND THE NORTH LINE OF MONTCALM STREET; THENCE NORTH ALONG THE EAST LINE OF THE PO&N RAILROAD RIGHT-OF-WAY LINE 6300 FEET TO A POINT; THENCE EASTERLY 700 FEET TO A POINT; THENCE SOUTHERLY 2400 FEET TO A POINT; THENCE EASTERLY 625 FEET TO A POINT ON THE WEST RIGHT-OF-WAY LINE OF HIGHWOOD BOULEVARD; THENCE SOUTHERLY ALONG THE WEST RIGHT-OF-WAY OF HIGHWOOD BOULEVARD 600 FEET TO A POINT, SAID POINT BEING THE INTERSECTION OF THE WEST RIGHT-OF-WAY OF HIGHWOOD BOULEVARD AND THE SOUTH RIGHT-OF-WAY OF BEVERLY AVENUE; THENCE EASTERLY ALONG THE SOUTH RIGHT-OF-WAY OF BEVERLY AVENUE 1250 FEET TO A POINT, SAID POINT BEING THE INTERSECTION OF THE SOUTH RIGHT-OF-WAY OF BEVERLY AVENUE AND THE WEST RIGHT-OF-WAY OF GLENWOOD BOULEVARD; THENCE SOUTHERLY ALONG THE WEST RIGHT-OF-WAY OF GLENWOOD BOULEVARD 900 FEET TO A POINT; THENCE EASTERLY 125 FEET TO A POINT; THENCE SOUTHERLY 525 FEET TO A POINT; THENCE WESTERLY 100 FEET TO A POINT ON THE WEST RIGHT-OF-WAY LINE OF GLENWOOD BOULEVARD; THENCE SOUTHERLY ALONG THE WEST RIGHT-OF-WAY LINE OF GLENWOOD BOULEVARD 50 FEET TO A POINT; THENCE WESTERLY 550 FEET TO A POINT; THENCE SOUTHERLY 1900 FEET TO A POINT ON THE NORTH RIGHT-OF-WAY LINE OF MONTCALM STREET; THENCE WESTERLY ALONG THE NORTH RIGHT-OF-WAY LINE OF MONTCALM STREET 2100 FEET TO THE POINT OF BEGINNING.



ENGINEERS

CIVIL ENGINEERS
LAND SURVEYORS
LAND PLANNERS

46777 WOODWARD AVENUE, PONTIAC, MI 48342-5032
TEL (248) 332-7931 FAX (248) 332-8257

DATED 07-11-14 JOB NO. H192 SCALE N/A
CLIENT GENERAL MOTORS CORPORATION SHEET NO. 3 of 4

Exhibit A

PROPOSED INDUSTRIAL DEVELOPMENT DISTRICT

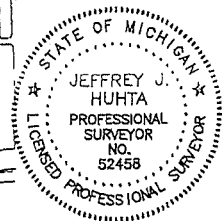
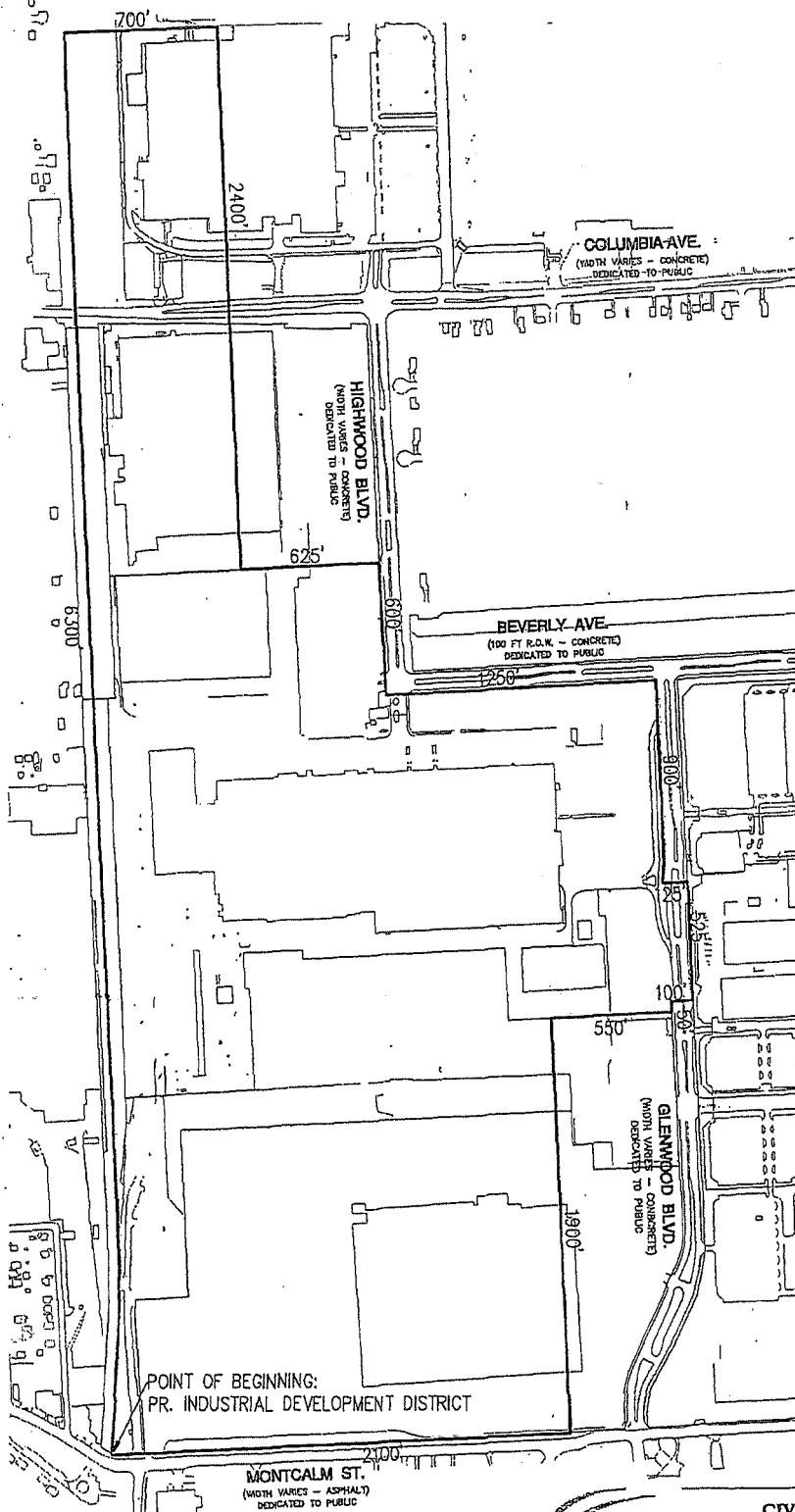
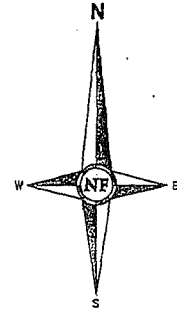

CIVIL ENGINEERS
LAND SURVEYORS
LAND PLANNERS

ENGINEERS
46777 WOODWARD AVENUE, PONTIAC, MI 48342-5032
TEL. (248) 332-7931 FAX. (248) 332-8257

DATED 07-11-14 JOB NO. H192 SCALE 1" = 600'
CLIENT GENERAL MOTORS CORPORATION SHEET NO. 4 of 4

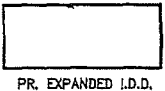

PR. EXPANDED I.D.D.

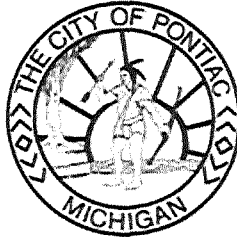

Whereas, pursuant to PA 198 of 1974, as amended, this city council has the authority to establish “Industrial Development Districts” within the City of Pontiac; and
Whereas, the City of Pontiac on its own initiative seeks to establish an Industrial Development District on property located within the City of Pontiac boundaries; and
Whereas, construction, acquisition, alteration, or installation of a proposed facility has not commenced at the time of filing the request to establish this district; and
Whereas, written notice has been given by mail to all owners of real property located within the district, and to the public by newspaper advertisement in the Oakland Press and/or public posting of the hearing on the establishment of the proposed district; and
Whereas, on August 7, 2014 a public hearing was held at which all owners of real property within the proposed Industrial Development District and all residents and taxpayers of the City of Pontiac were afforded an opportunity to be heard thereon; and
Whereas, the City Council deems it to be in the public interest of the City of Pontiac to establish the Industrial Development District as proposed; and
Now, Therefore, Be It Resolved by the City Council of the City of Pontiac that the following described parcel of land situated in the City of Pontiac, County of Oakland, and State of Michigan, to wit:

A PARCEL OF LAND DESCRIBED AS BEGINNING AT THE INTERSECTION OF EAST LINE OF THE PO&N RAILROAD AND THE NORTH LINE OF MONTCALM STREET; THENCE NORTH ALONG THE EAST LINE OF THE PO&N RAILROAD RIGHT-OF-WAY LINE 6300 FEET TO A POINT; THENCE EASTERLY 700 FEET TO A POINT; THENCE SOUTHERLY 2400 FEET TO A POINT; THENCE EASTERLY 625 FEET TO A POINT ON THE WEST RIGHT-OF-WAY LINE OF HIGHWOOD BOULEVARD; THENCE SOUTHERLY ALONG THE WEST RIGHT-OF-WAY OF HIGHWOOD BOULEVARD 600 FEET TO A POINT, SAID POINT BEING THE INTERSECTION OF THE WEST RIGHT-OF-WAY OF HIGHWOOD BOULEVARD AND THE SOUTH RIGHT-OF-WAY OF BEVERLY AVENUE; THENCE EASTERLY ALONG THE SOUTH RIGHT-OF-WAY OF BEVERLY AVENUE 1250 FEET TO A POINT, SAID POINT BEING THE INTERSECTION OF THE SOUTH RIGHT-OF-WAY OF BEVERLY AVENUE AND THE WEST RIGHT-OF-WAY OF GLENWOOD BOULEVARD; THENCE SOUTHERLY ALONG THE WEST RIGHT-OF-WAY OF GLENWOOD BOULEVARD 900 FEET TO A POINT; THENCE EASTERLY 125 FEET TO A POINT; THENCE SOUTHERLY 525 FEET TO A POINT; THENCE WESTERLY 100 FEET TO A POINT ON THE WEST RIGHT-OF-WAY LINE OF GLENWOOD BOULEVARD; THENCE SOUTHERLY ALONG THE WEST RIGHT-OF-WAY LINE OF GLENWOOD BOULEVARD 50 FEET TO A POINT; THENCE WESTERLY 550 FEET TO A POINT; THENCE SOUTHERLY 1900 FEET TO A POINT ON THE NORTH RIGHT-OF-WAY LINE OF

MONTCALM STREET; THENCE WESTERLY ALONG THE NORTH RIGHT-OF-WAY LINE OF MONTCALM STREET 2100 FEET TO THE POINT OF BEGINNING.

is established as an Industrial Development District pursuant to the provision of PA 198 of 1974, as amended, to be known as Pontiac Industrial Development District No. 2014-1.

Moved by Councilperson Woodward and supported by Councilperson Taylor-Burks.

Ayes: Holland, Pietila, Taylor-Burks, Waterman, and Woodward

No: Carter

Resolution Adopted.

Councilman Williams was temporarily excused.

I, Sherikia L. Hawkins, City Clerk of Pontiac, Michigan do hereby certify that the foregoing is a true copy of a resolution adopted by the Pontiac City Council at a regular meeting held on August 15, 2014.

Given under the hand and seal of the City of Pontiac, Michigan this 1st day of October 1, 2014.

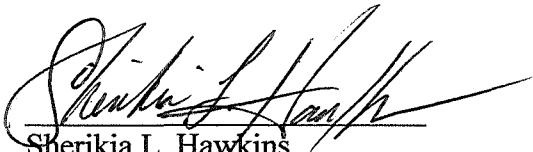

Sherikia L. Hawkins

City Clerk

47450 Woodward Avenue

Pontiac, Michigan 48342

