

## Section 4.103 Fences or Walls

A. **Residential Districts.** Fences are permitted in residential and C-O districts as follows: **1. Height requirements. (a). Front or Side Street Yards.** In any R-1 and R-2 district, decorative, non-opaque fences such as wood picket fences or wrought iron-appearing fences not exceeding four feet in height measured above immediate ground level are permitted in front yard.

B. **Rear or Interior Side Yards.** Decorative or concealing or opaque type fences or walls not exceeding six feet in height above immediate ground level are permitted in side or rear yards. **2. Location.** Fences may be located in any required or non-required yard. **3. Materials.** Barbed wire and other similar hazardous materials are prohibited in residential districts

**Side Yard Fence  
Maximum Height 6'**

**Front Yard Fence  
Maximum Height 4'**

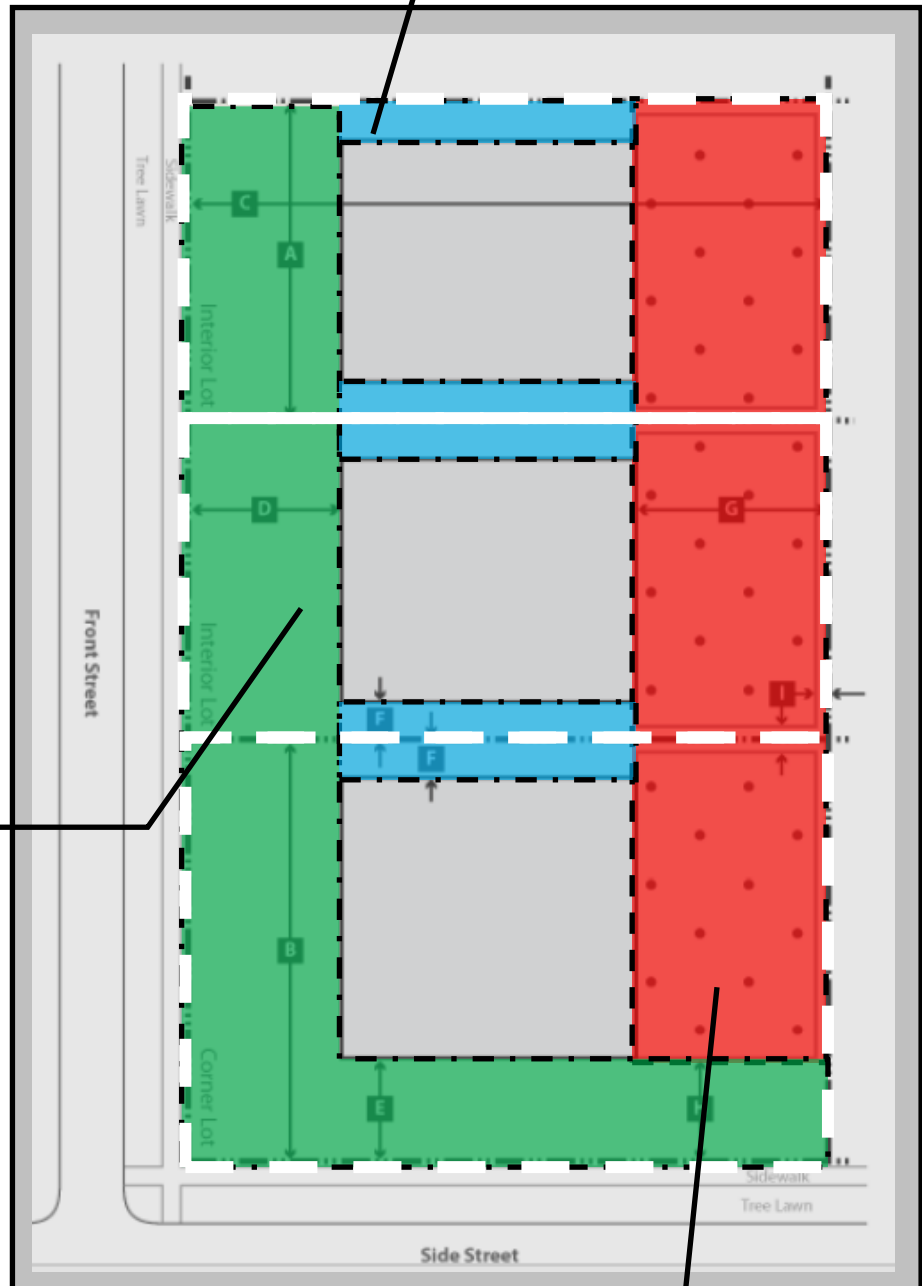

**Rear Yard Fence  
Maximum Height 6'**

Sidewalk and Driveway Repair

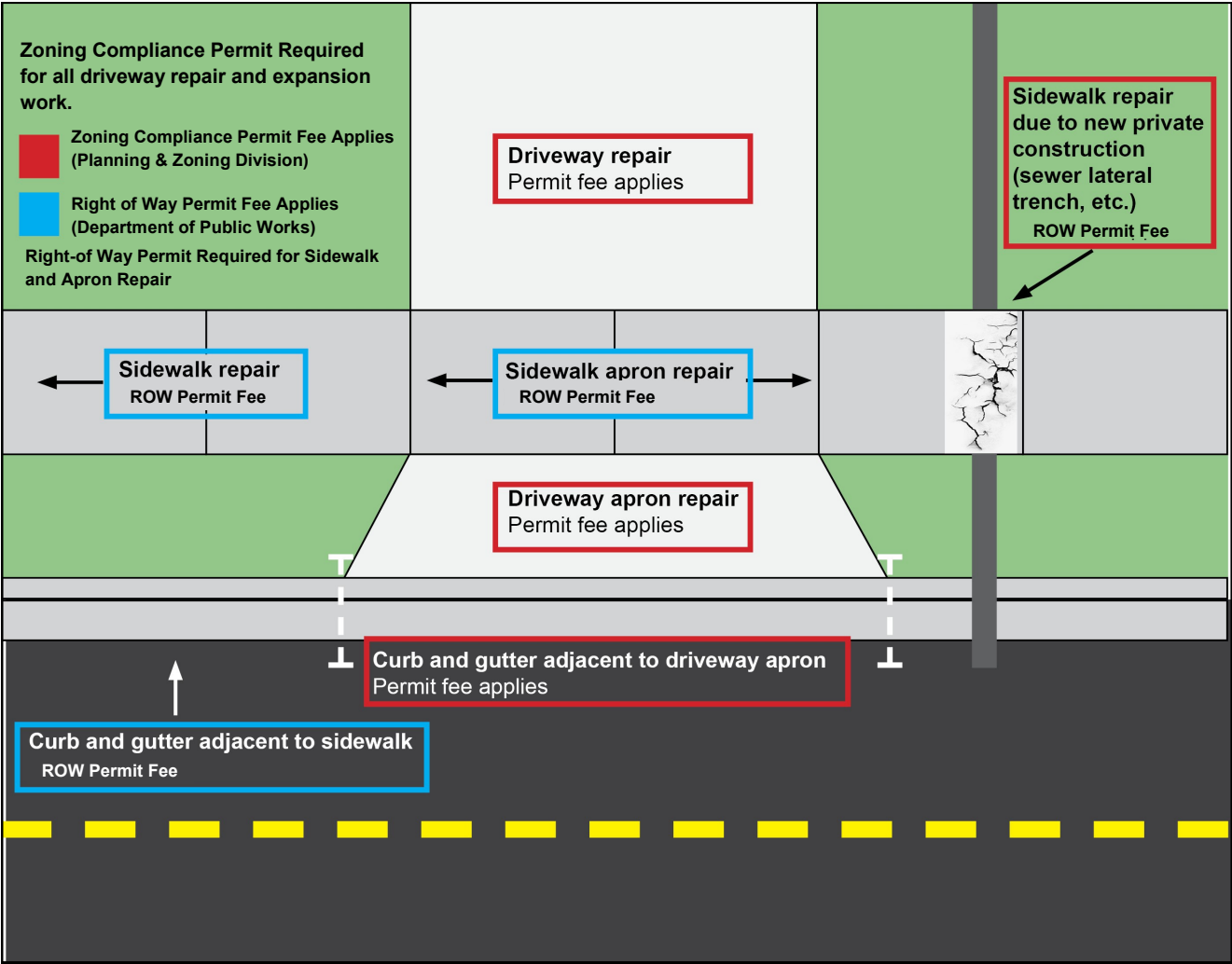

Department of Public Works—(248) 758 - 3600

Sample Property Diagram Corner Lot—Accessory Structures

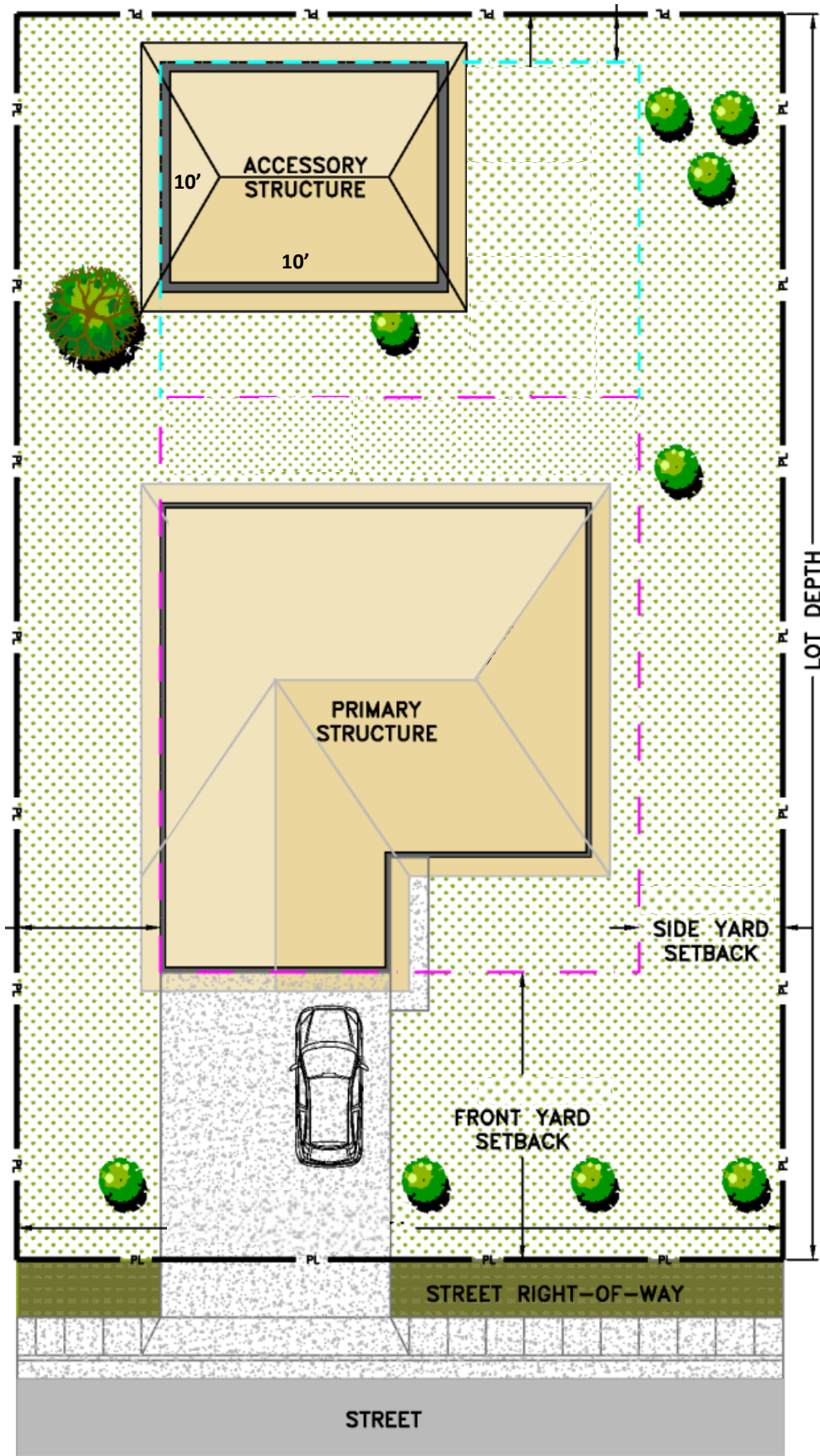



Sample Property Diagram Interior Lot—Accessory Structures

