

B

SWIMMING POOL/SPA PERMIT CHECKLIST



COMMUNITY DEVELOPMENT DEPARTMENT • 345 N EL DORADO STREET • STOCKTON, CA 95202 • (209) 937-8561
www.stocktonca.gov/buildinginspection

This form must be completed and included with all new swimming pool and spa permit applications. Your submittal may be rejected if the items below are not clearly addressed in your submittal package.

| GENERAL: | | YES | NO |
|--|---|-----|----|
| | Has your submittal package been consolidated into only <u>(2) files</u> ; one including the permit application, and one for all other documents (i.e. plans, calculations, specifications, etc.)? | | |
| | Are the setbacks from the property lines shown on the site plan? (see SMC 16.80.020) | | |
| | Are there any Accessory Structures? If so, is the distance from structure to pool shown on site plan? | | |
| | Are there any waterways or levees located next to the property? If yes, have you provided a letter of approval for the project from the levee/waterway maintaining agency? (levee setbacks found HERE) | | |
| | Are there any easements located on the property? If yes, are they shown on the site plan? Include dimensions of easement. (search for easements on the County's website HERE) | | |
| | Is the pool equipped with an anti-entrapment drain? | | |
| | Is the pool equipment shown on the site plan, with setbacks from property lines? (see SMC 16.80.020) | | |
| | All non-pedestrian gates (i.e. RV gates) are shown and specified to remain locked while not in use? | | |
| POOL SAFETY: Identify the TWO safety features that will be provided | | | |
| Note: Items 3 & 6 cannot be used together, items 4 & 5 cannot be used together | | | |
| 1 | An enclosure (i.e. fence) that isolates the swimming pool or spa from the residence. | | |
| 2 | Removable mesh fencing around the pool or spa that meets American Society for Testing and Materials (ASTM) Standard F2286 in conjunction with a gate that is self-closing and self-latching and can accommodate a key lockable device. | | |
| 3 | A manually/power-operated safety pool cover that meets all the performance standards of ASTM F1346-91. | | |
| 4 | All doors providing direct access from the residence or attached garage to the pool or spa shall be equipped with exit alarms. The exit alarm may cause either an alarm noise or verbal warning. Note: See below for additional alarm requirements. | | |
| 5 | All doors providing direct access from the residence or attached garage to the pool/spa shall be equipped with a self-closing, self-latching device with a release mechanism placed at least 54 inches above the floor. | | |
| 6 | An alarm that meets ASTM Standard F2208 that, when placed in the pool or spa, will sound upon detection of accidental or unauthorized entrance into the water. Note: Based on the size and/or shape of the pool multiple alarms may be required. | | |
| 7 | Other means of protection, if the degree of protection afforded is equal to or greater than the afforded by any of the features set forth above and has been independently verified by an approved testing laboratory as meeting standards established by ASTM or American Society of Mechanical Engineers (ASME). | | |
| ADDITIONAL REQUIREMENTS: | | | |
| Per the International Swimming Pool and Spa Code Section 305.4: Where a wall of a dwelling or structure serves as part of the barrier and where doors, gates, or windows provide direct access to the pool or spa through that wall, ONE of the following shall be required. | | | |
| Check which option you will be using or indicate N/A if providing safety feature #1 above: | | | |
| 1 | Operable <i>windows</i> having a sill height of less than 48 inches above the indoor finished floor, doors, and gates shall have an alarm that produces an audible warning when the window, door or their screens are opened. The alarm shall be listed and labeled as a water hazard entrance alarm in accordance with UL 2017, the operable parts of the alarm deactivation switches shall be located 54 inches or more above the finished floor. | | |
| 2 | A safety cover that is listed and labeled in accordance with ASTM F1346 is installed. | | |
| 3 | An approved means of protection, such as self-closing doors with self-latching devices, is provided. Such means of protection shall provide a degree of protection that is not less than the protection afforded by Item 1 or 2. | | |

SAMPLE SITE PLAN:

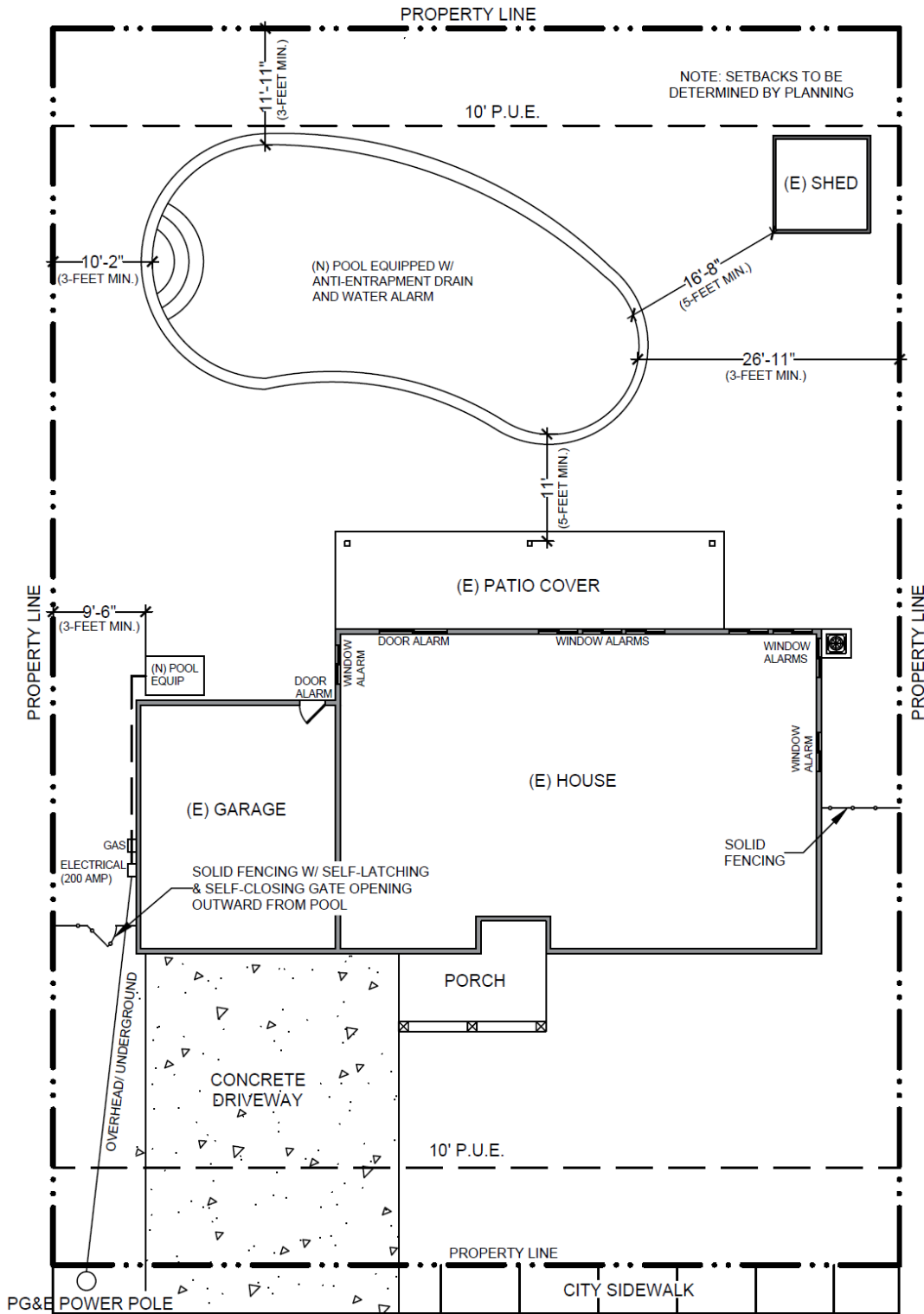

| Site Plan Requirements | |
|--------------------------|---|
| <input type="checkbox"/> | House Footprint |
| <input type="checkbox"/> | Pool/Spa Location |
| <input type="checkbox"/> | Pool Equip. Location |
| <input type="checkbox"/> | Accessory Structures |
| <input type="checkbox"/> | Dimensions between pool/spa and all property lines and structures |
| <input type="checkbox"/> | Easement Locations |
| <input type="checkbox"/> | Setbacks |
| <input type="checkbox"/> | Gates/Fences |
| <input type="checkbox"/> | All openings providing direct access to the pool/spa from the house |
| <input type="checkbox"/> | Safety Features (see page 1) |
| <input type="checkbox"/> | Adjacent levees or waterways |

123 NORTH MAIN STREET

SCALE 1/16" = 1'-0"

