

# FOCUS AREA: SOUTH AIRPORT CORRIDOR

## COMMUNITY VISION

The South Airport Corridor connects Downtown with the Airport and is home to a concentration of businesses and jobs. At the same time, South Airport is an attractive, pedestrian-friendly commercial spine for strong residential neighborhoods on both sides.

Does this capture your vision? Please place a dot on the line below.

YES! This is my vision

NO! I see it differently

? What words are missing?

## ISSUES & OPPORTUNITIES

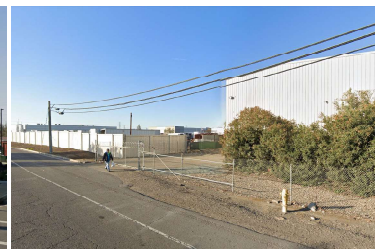
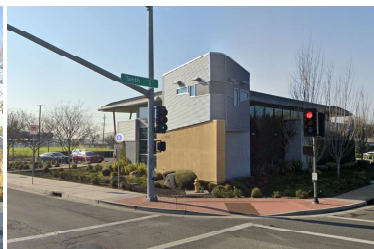
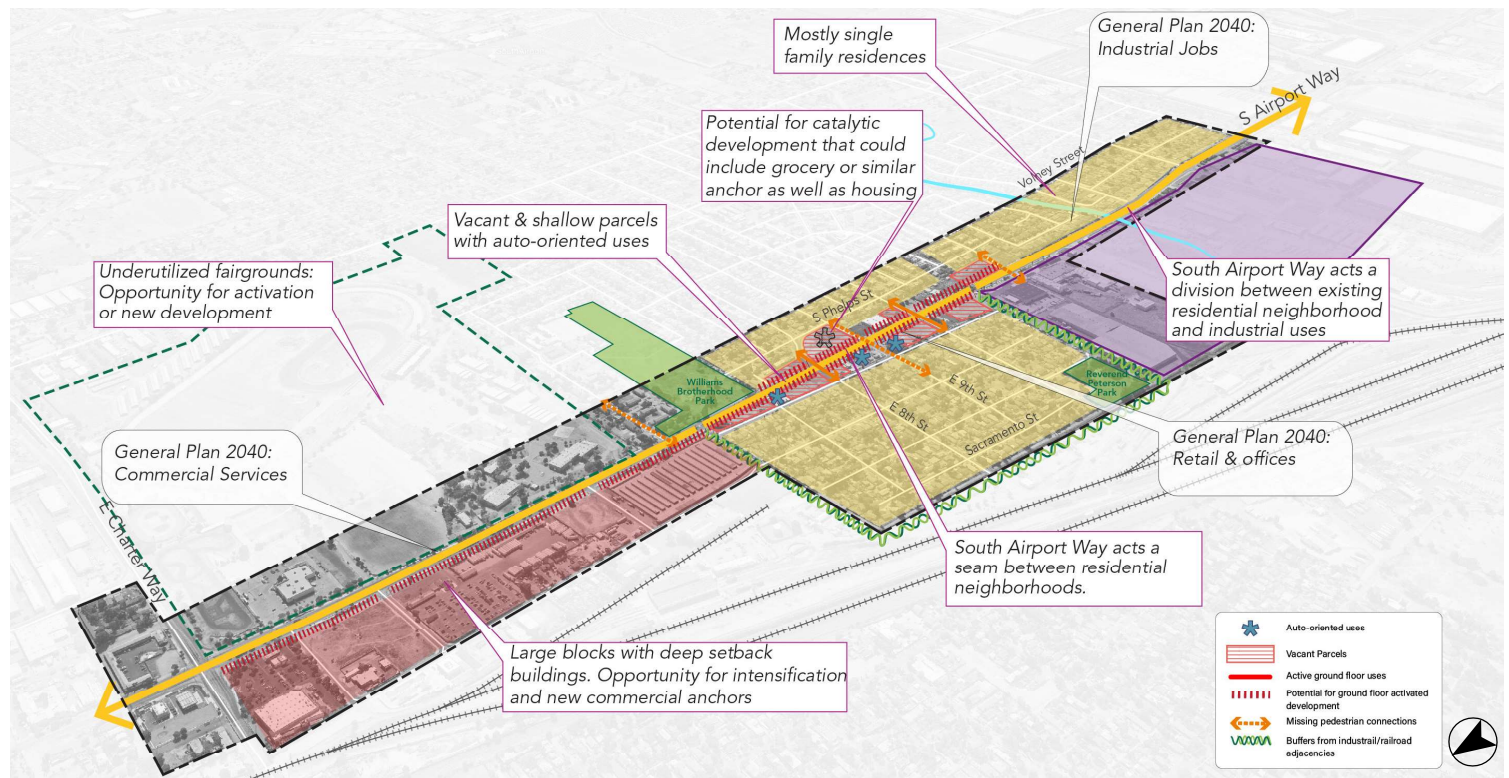

## Existing Zoning

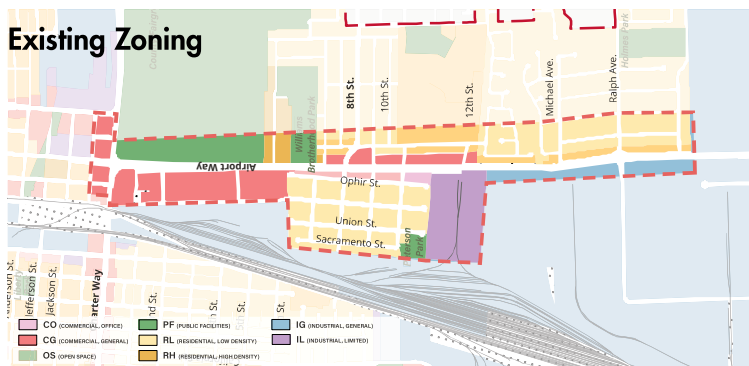

? What key conditions are we missing?

# FOCUS AREA: SOUTH AIRPORT CORRIDOR

## DESIGN CONSIDERATIONS AND APPROACHES

For each of the ideas below, please let us know if you like it (a green dot) or if you don't (a red one). Share your thoughts by writing notes on the board.

- 1 Ensure that new development along the central segment of Airport Way is sidewalk-facing, with a comfortable setback from the street, ground-floor height that suits successful retail, and ground-floor transparency.

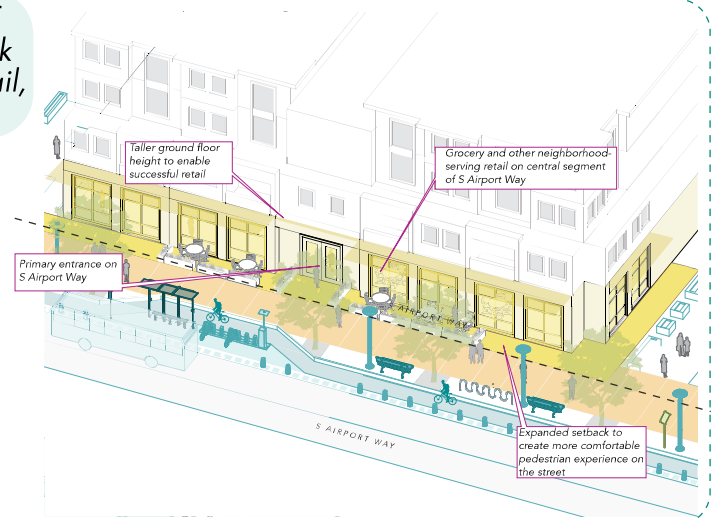

- 2 Enable mixed-use development on large sites at the north end of the district, creating new residential opportunities.

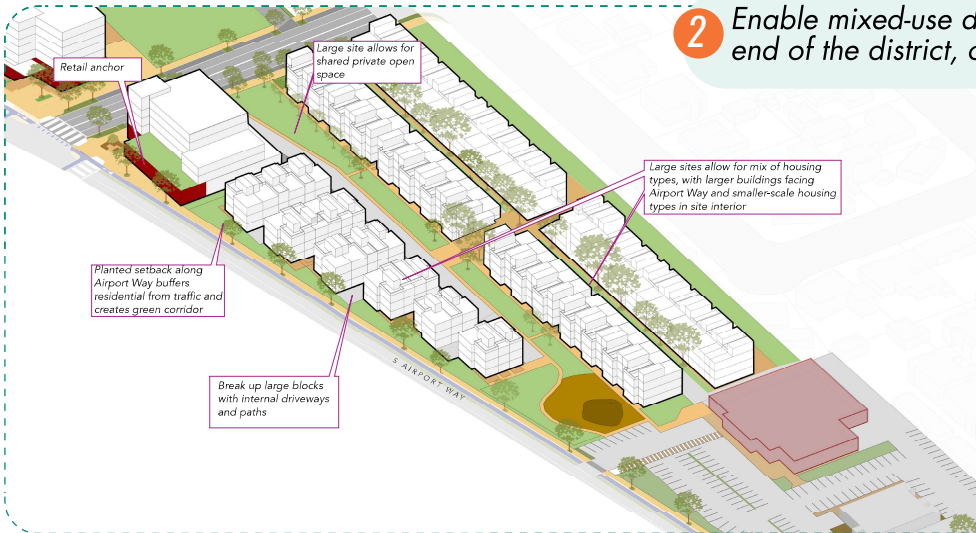

- 3 Create a safe, attractive multimodal corridor. This should include setbacks and landscape along the northern and southern segments, and enriched pedestrian environment in the central segment.

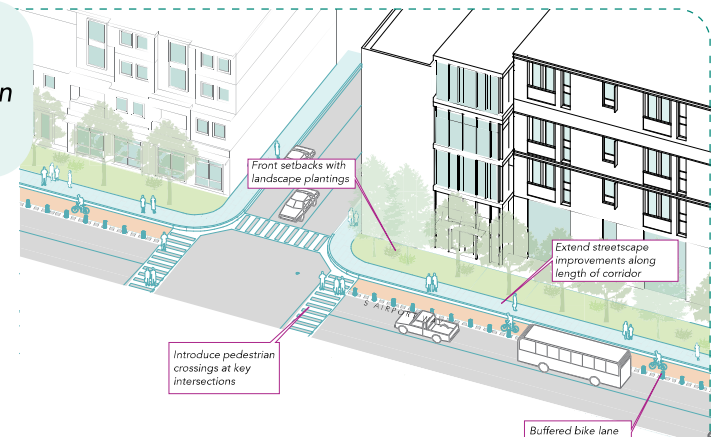



Participants were asked to comment on the vision for the area, as well as existing key conditions. Participants highlighted the need for green innovation, road improvement completion, residential development retail, grocery stores, and regulation/enforcement of pollutants and other nuisances from industrial uses.

1. Ensure that new development along the central segment of Airport Way is sidewalk-facing, with a comfortable setback from the street, ground-floor height that suits successful retail, and ground-floor transparency.

3. Create a safe, attractive multimodal corridor. This should include setbacks and landscape along the northern and southern segments, and enriched pedestrian environment in the central segment.

- *Transportation hub*
- *Mixed use should have some required open space at intervals that connect integrated paths*
- *Looks great to have separated bikeway but the pedestrian bulbouts are hazardous*

